



jordan fishwick

Macclesfield Road Whaley Bridge High Peak



Macclesfield Road Whaley Bridge High Peak SK23 7DH

Guide Price £245,000



The Property

A charming end-terrace cottage in the ever popular Whaley Bridge, offering character, modern updates, and scope to add value. This two-bedroom home has benefited from recent upgrades including a new roof, boiler, updated electrics, and modern kitchen, while still allowing the new owner to put their own stamp on it. The recently plastered and rewired loft area has access from the landing and could have many buyer specific uses or could simply be an ample storage area. Outside, the property boasts a generous garden with patio, 2 sheds, wood store, and bin storage. the location conveniently offer Whaley Bridge's many local amenities, strong transport links and the beautiful Peak District. This cottage is a fantastic opportunity for buyers seeking both charm and potential scope for improvement.



- 2 Bedroom Property
- End-terraced
- Open Plan Kitchen Diner
- Recent Improvements
- Large Front Garden
- Scope for Improvement/loft works
- Great Transport Links
- Nearby Open Countryside

Postcode

SK23 7DH

EPC Rating

D

Local Authority

High Peak

Council Tax

B

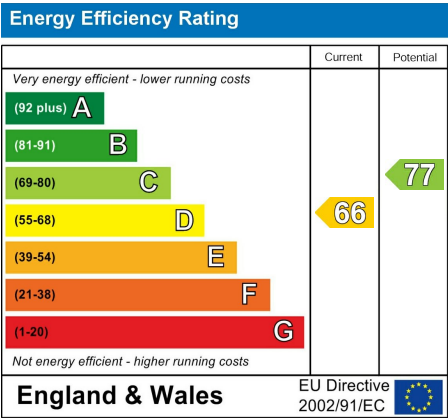

GROUND FLOOR

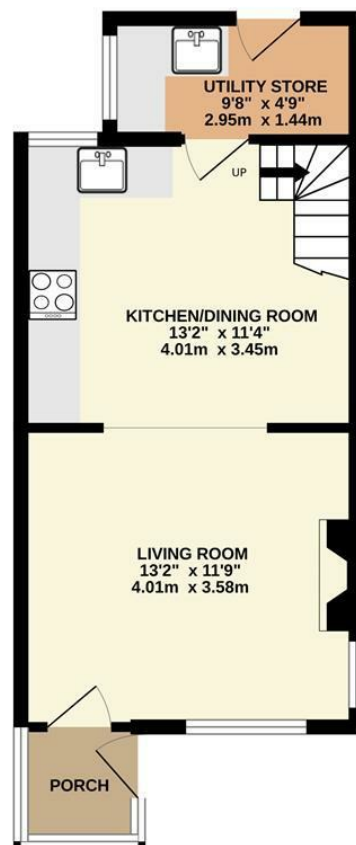

1ST FLOOR



Whilst every attempt has been made to ensure the accuracy of the floorplan contained here, measurements of doors, windows, rooms and any other items are approximate and no responsibility is taken for any error, omission or mis-statement. This plan is for illustrative purposes only and should be used as such by any prospective purchaser. The services, systems and appliances shown have not been tested and no guarantee as to their operability or efficiency can be given.
Made with Metropix ©2025



These particulars are believed to be accurate but they are not guaranteed and do not form a contract. Neither Jordan Fishwick nor the vendor or lessor accept any responsibility in respect of these particulars, which are not intended to be statements or representations of fact and any intending purchaser or lessee must satisfy himself by inspection or otherwise as to the correctness of each of the statements contained in these particulars. Any floorplans on this brochure are for illustrative purposes only and are not necessarily to scale.

Offices at: Chorlton, Didsbury, Disley, Hale, Glossop, Macclesfield, Manchester Deansgate, Manchester Whitworth Street, New Mills, Sale, Wilmslow and Withington

14 Market St, Disley, Cheshire, Stockport SK12 2AA

01663 767878

disley@jordanfishwick.co.uk
www.jordanfishwick.co.uk