



Thatch Meadow Drive, Market Harborough **Freehold** £275,000

**Pattison
Lane**

Key Features



- End of Terraced Home
- Three Bedrooms
- Driveway for Two Vehicles
- Modern Kitchen / Dining Room
- En-Suite to Master

Nestled in a peaceful and highly sought-after enclave of Market Harborough, this beautifully presented three-bedroom end-of-terrace home offers the perfect blend of contemporary style and suburban tranquillity.

Whether you are a first-time buyer, a growing family, or a professional seeking effortless connectivity, this residence is designed for modern living.



The journey begins in a welcoming entrance hallway that leads into a bright and generously proportioned living room-a perfect sanctuary for relaxation. To the rear, the home opens into a sleek, modern kitchen and dining room. This social hub is bathed in natural light, featuring elegant French doors that provide a seamless transition to the garden. A discreet guest W/C adds to the practical layout of the ground floor.

Upstairs, the home continues to impress with three bedrooms. The master bedroom serves as a private retreat, boasting a dedicated walk-in wardrobe and a stylish en-suite shower room. The remaining bedrooms are served by a family bathroom.

The rear garden is a standout feature-fully enclosed, beautifully landscaped, and meticulously maintained. It offers a private oasis for alfresco dining, complete with a functional garden shed for storage.

To the front, the property benefits from a private driveway providing comfortable off-road parking for two vehicles.

Viewings are highly advised to appreciate all this home has to offer!



GROUND FLOOR



1ST FLOOR

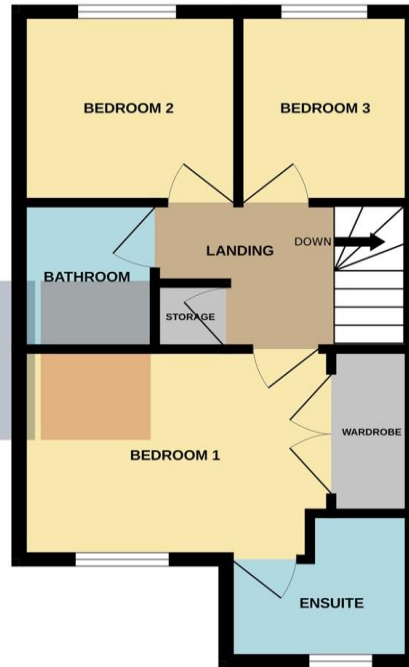

Whilst every attempt has been made to ensure the accuracy of the floorplan contained here, measurements of doors, windows, rooms and any other items are approximate and no responsibility is taken for any error, omission or mis-statement. This plan is for illustrative purposes only and should be used as such by any prospective purchaser. The services, systems and appliances shown have not been tested and no guarantee as to their operability or efficiency can be given.
Made with Metropix ©2026

The accommodation comprises:

ENTRANCE HALL

CLOAKROOM

LIVING ROOM 15' max x 14'1 (4.57m x 4.29m)

KITCHEN / DINING ROOM 8'7 x 15'1 (2.61m x 4.59m)

FIRST FLOOR LANDING

BEDROOM ONE 8'7 max x 11'5 max (2.61m x 3.47m)

EN SUITE

BEDROOM TWO 8'5 x 7'11 (2.56m x 2.41m)

BEDROOM THREE 6'6 x 7'11 (1.98m x 2.41m)

BATHROOM

OUTSIDE

FRONT GARDEN / DRIVEWAY

REAR GARDEN

To view this property call Pattison Lane on:
01536 430527

Selling your property?



SCAN ME

Contact us to arrange a **FREE** home valuation.

 01536 430527

 42 Station Road, Desborough, KETTERING, Northamptonshire, NN14 2RL

 desborough@pattisonlane.co.uk

 www.pattisonlane.co.uk



SCAN ME



Sharman Quinney Holdings Limited is registered in England and Wales under company number 4174227, Registered Office is Cumbria House, 16-20 Hockliffe Street, Leighton Buzzard, Bedfordshire, LU7 1GN. VAT Registration Number is 500 2481 05.

1: These particulars do not constitute part or all of an offer or contract. 2: The measurements indicated are supplied for guidance only and as such must be considered incorrect. 3: Potential buyers are advised to recheck the measurements before committing to any expense. 4: Sharman Quinney has not tested any apparatus, equipment, fixtures, fittings or services and it is the buyers interests to check the working condition of any appliances. 5: Sharman Quinney has not sought to verify the legal title of the property and buyers must obtain verification from their legal representative. 6: Intending purchasers will be asked to produce identification documentation at a later stage and we would ask your co-operation in order that there will be no delay in agreeing the sale. Ref: DPL101630 - 0001

