

Merchant Square, Paddington W2



Merchant Square, Paddington W2

A contemporary one bedroom apartment located on the tenth floor of this fabulous modern waterside development which offers fantastic living space and wonderful views across the Grand Union canal.

The accommodation comprises a dual aspect reception room with ample space for dining, fully integrated open plan kitchen including microwave and wine fridge, principal bedroom with built-in wardrobe and a fully tiled bathroom. The property further benefits from comfort cooling, and onsite concierge located in the impressive entrance foyer, communal terrace and residents screening room.



Guide price: £724,990

Tenure: Leasehold: approximately 969 years remaining

Service charge: £7,225.42 per annum, reviewed every year, next review due 2025

Ground rent: £398.75 per annum. We have been unable to confirm the next review date.

Local authority: City of Westminster

Council tax band: E



We have been informed of some fire safety matters that applicants should be aware of when considering this property. Further information will be provided.

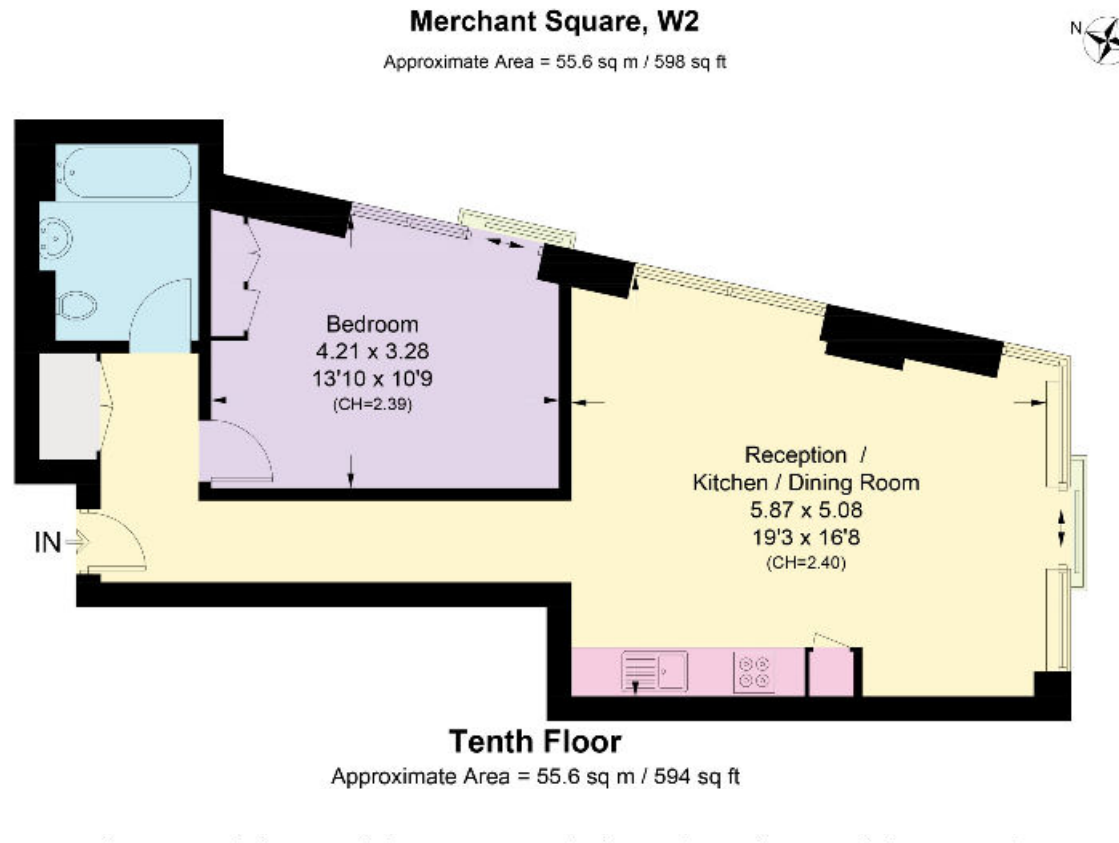

This plan is for guidance only and must not be relied upon as a statement of fact. Attention is drawn to the important notice on the last page of the text of the Particulars.

Knight Frank
Hyde Park
1 Craven Terrace
London
W2 3QD

[knightfrank.co.uk](https://www.knightfrank.co.uk)

I would be delighted to tell you more

Mark Ruffell

020 3697 8234

mark.ruffell@knightfrank.com



Fixtures and fittings: A list of the fitted carpets, curtains, light fittings and other items fixed to the property which are included in the sale (or may be available by separate negotiation) will be provided by the Seller's Solicitors.

Important Notice: 1. Particulars: These particulars are not an offer or contract, nor part of one. You should not rely on statements by Knight Frank LLP in the particulars or by word of mouth or in writing ("information") as being factually accurate about the property, its condition or its value. Neither Knight Frank LLP nor any joint agent has any authority to make any representations about the property, and accordingly any information given is entirely without responsibility on the part of the agents, seller(s) or lessor(s). 2. Photos, Videos etc: The photographs, property videos and virtual viewings etc. show only certain parts of the property as they appeared at the time they were taken. Areas, measurements and distances given are approximate only. 3. Regulations etc: Any reference to alterations to, or use of, any part of the property does not mean that any necessary planning, building regulations or other consent has been obtained. A buyer or lessee must find out by inspection or in other ways that these matters have been properly dealt with and that all information is correct. 4. VAT: The VAT position relating to the property may change without notice. 5. To find out how we process Personal Data, please refer to our Group Privacy Statement and other notices at <https://www.knightfrank.com/legals/privacy-statement>.

Particulars dated October 2024. Photographs and videos dated October 2024.

Knight Frank is the trading name of Knight Frank LLP. Knight Frank LLP is a limited liability partnership registered in England and Wales with registered number OC305934. Our registered office is at 55 Baker Street, London W1U 8AN where you may look at a list of members' names. If we use the term 'partner' when referring to one of our representatives, that person will either be a member, employee, worker or consultant of Knight Frank LLP and not a partner in a partnership. If you do not want us to contact you further about our services then please contact us by either calling 020 3544 0692, email to marketing.help@knightfrank.com or post to our UK Residential Marketing Manager at our registered office (above) providing your name and address.