

TOWN & COUNTRY
ESTATES



Islington, Trowbridge, Wiltshire BA14 8QE

£675 Per Calendar Month

LOCATION

The property is conveniently located within walking distance to the town centre, schools, doctors, train station and a new cinema and restaurant complex.

DESCRIPTION

A one bedroom split level flat, easily positioned for access to local transport links and amenities. The property comprises an open plan lounge and kitchen area on the ground floor and a large double bedroom with built in wardrobe and en-suite shower room on the first floor. Benefits include uPVC double glazing and gas central heating.

KITCHEN/LOUNGE

19'09" x 10'07"

The open plan kitchen/lounge has a UPVC double glazed window, radiator, range of matching wall and base units, ceramic hob with extractor fan above, inset sink, fridge, washing machine and cooker.

BEDROOM

11'01" x 10'07"

The bedroom is fitted with wood effect flooring, a UPVC double glazed window to the front of the property and built in wardrobe.

BATHROOM

5'05" x 6'05"

In the bathroom there is a double shower with glass sliding doors, vanity unit, hand basin, W/C, partially tiled and an extractor fan.

ADDITIONAL INFORMATION

Council Tax Band - A

Although there is no allocated parking, there is the ability to park in nearby roads.



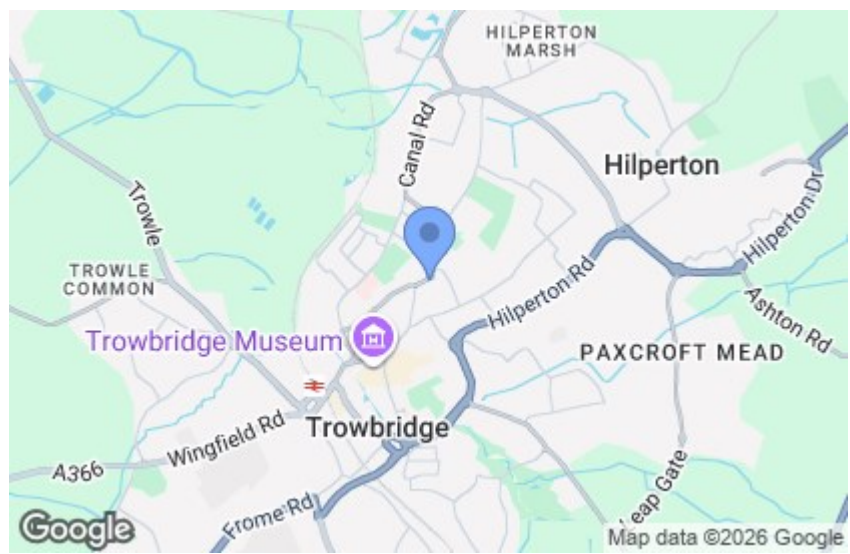





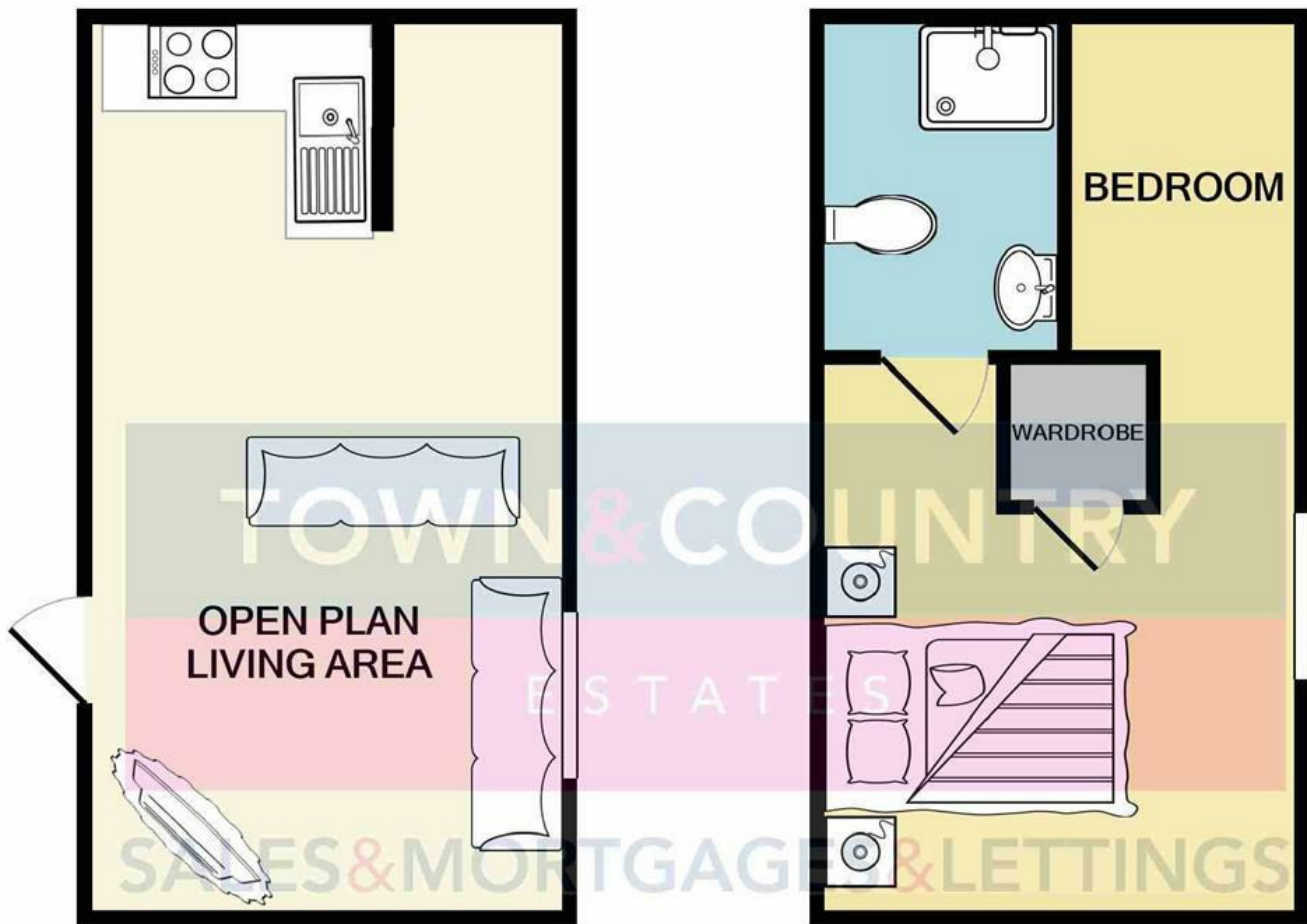

GROUND FLOOR

1ST FLOOR

Whilst every attempt has been made to ensure the accuracy of the floor plan contained here, measurements of doors, windows, rooms and any other items are approximate and no responsibility is taken for any error, omission, or mis-statement. This plan is for illustrative purposes only and should be used as such by any prospective purchaser. The services, systems and appliances shown have not been tested and no guarantee as to their operability or efficiency can be given
 Made with Metropix ©2019

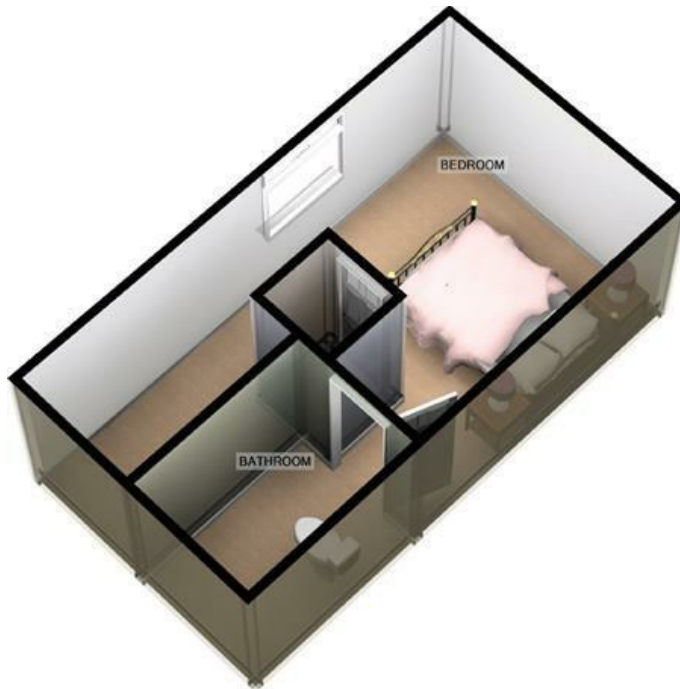

1ST FLOOR

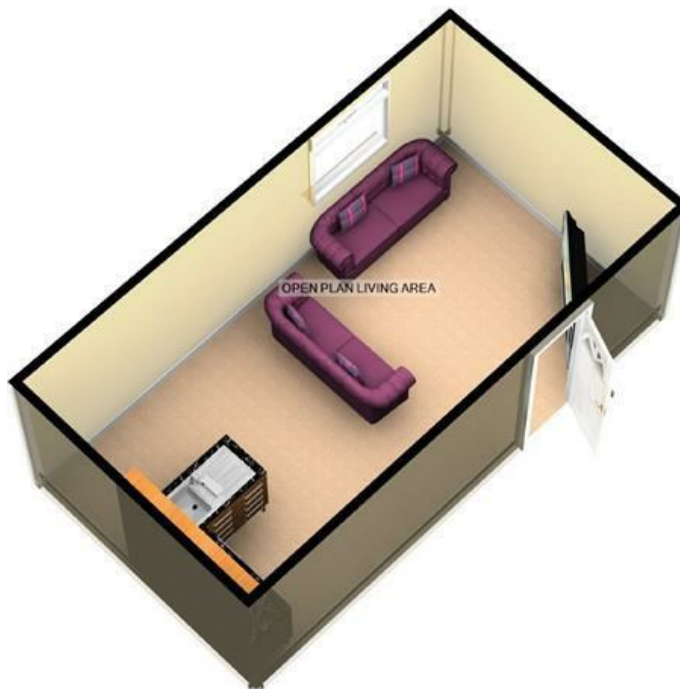

GROUND FLOOR

For illustrative purposes only. Decorative finishes, fixtures, fittings and furnishings do not represent the current state of the property. Measurements are approximate. Not to scale
Made with Metropix ©2019

