



Ariel House

144 Vaughan Way, E1W

Asking Price £715,000

A studio apartment situated on the 4th floor of the brand new London Dock development. The property is furnished to a high standard and boasts state of the art fixtures and fittings, 24 hour concierge and residents health and fitness suite.

CHESTERTONS



Ariel House

144 Vaughan Way, E1W

- New Development
- large Studio Apartment
- Fourth Floor
- 627 SQ FT
- Stylish Furniture
- 24 Hour Concierge
- Residents Fitness Suite



A studio apartment situated on the 4th floor of a new London Dock development. The property is furnished to a high standard and boasts state of the art fixtures and fittings, 24 hour concierge, residents health and fitness suite including cinema, swimming pool, gym, squash court and golf simulator.

Wapping is a unique area steeped in history and character situated along the north side of the River Thames. Although The City is within walking distance, the area is also well connected via Wapping, Tower Hill & Tower Gateway stations. The area is home to St Katharine Docks which is central London's only marina, boasting an array of bars and restaurants.

Tenure: Leasehold 962 years 3 months

Service Charge: £3341.08 pa

Ground Rent: £400 pa

Local Authority: Tower Hamlets

Council Tax Band: E

| Energy Efficiency Rating | | Current | Potential |
|---|---|-------------------------|-----------|
| Very energy efficient - lower running costs | A | | |
| (92-100) | B | 85 | 85 |
| (81-91) | C | | |
| (69-80) | D | | |
| (55-68) | E | | |
| (39-54) | F | | |
| (21-38) | G | | |
| Not energy efficient - higher running costs | | | |
| England, Scotland & Wales | | EU Directive 2002/91/EC | |

Chestertons Tower Bridge Sales

220 Tower Bridge Road

Tower Bridge

London

SE1 2UP

towerbridge@chestertons.co.uk

020 7357 7999

chestertons.co.uk

Ariel House, Vaughan Way, E1W

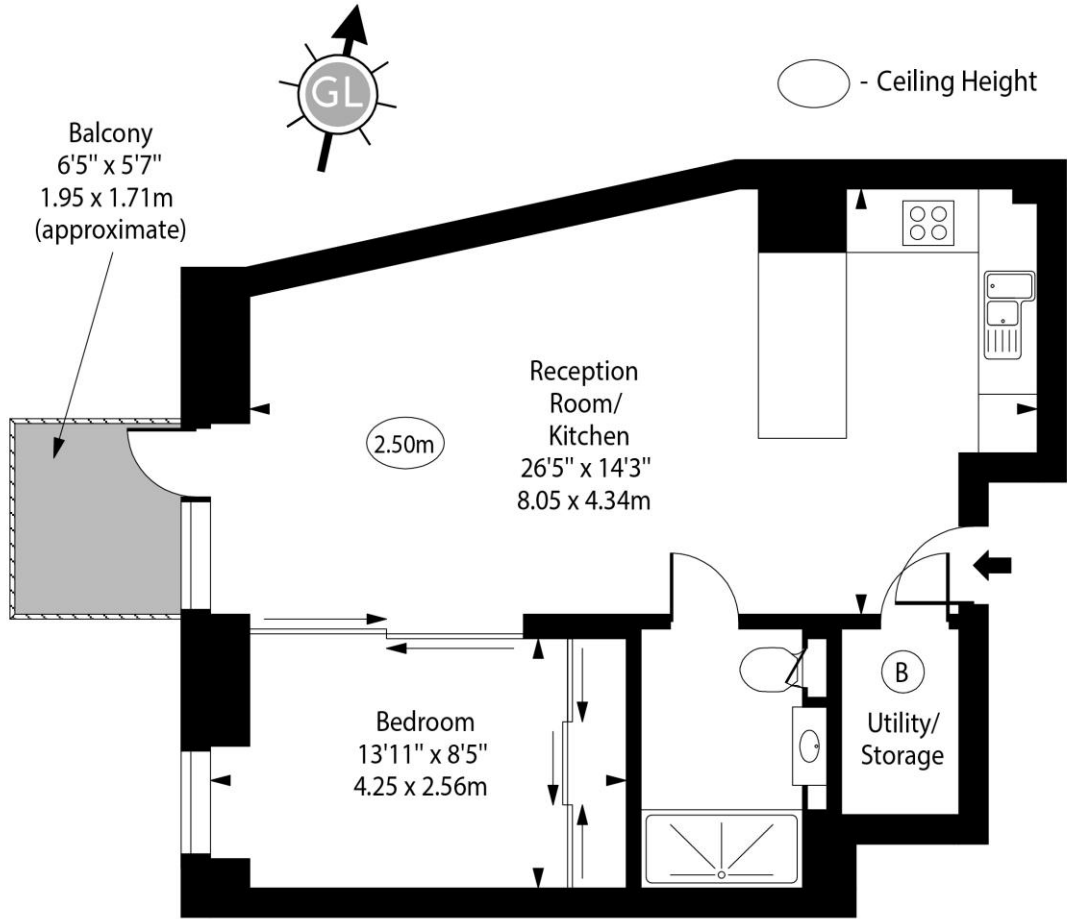

Fourth Floor

Approx Gross Internal Area

552 Sq Ft - 51.28 Sq M

Every attempt has been made to ensure the accuracy of the floor plan shown. However, all measurements, fixtures, fittings, and data shown are approximate interpretations and for illustrative purposes only. Measured according to the RICS. Not To Scale.

www.goldlens.co.uk

Ref. No. 031143D

