



12 Chesters Place Oteley Road Shrewsbury Shropshire

Monthly Rental Of £875

AVAILABLE NOW. A stylish newly built 2 bedroom semi detached property. Accommodation comprises; Ent Hall, Cloakroom, Living Room, Kitchen/ Diner. First Floor Landing, Master Bedroom, Family Bathroom, Bedroom Two. GCH, DG.

Rear Garden, Parking for Two Vehicles. ZJ&B Tenancies granted subject to contract following satisfactory credit and referencing checks. 1 weeks holding fee applicable to successful applicants. Deposit: 5 weeks rent and first month's rent payable in advance. Rent EXCLUDES utilities and council tax. Tenancies granted on a 12 month assured shorthold tenancy unless otherwise agreed.



12 Chesters Place, Oteley Road, Shrewsbury, Shropshire, SY2 6GB



<p>Accommodation includes:</p> <ul style="list-style-type: none"> Accommodation Entrance Hall Cloakroom Living Room 13' 8" x Max 13' 3" (4.16m x 4.04m) Kitchen/Diner 13' 4" x 8' 10" (4.06m x 2.69m) First Floor Landing Bedroom 1 13' 4" x 8' 10" (4.06m x 2.69m) Bathroom Bedroom 2 13' 4" x 7' 8" (4.06m x 2.34m) Rear Garden 	<p>Council Tax Band 2</p> <p>Monthly Rental Of £875 per calendar month</p> <p>Deposit - £1009.00 5 weeks rent</p> <p>Minimum Term of 12 months</p>
---	--

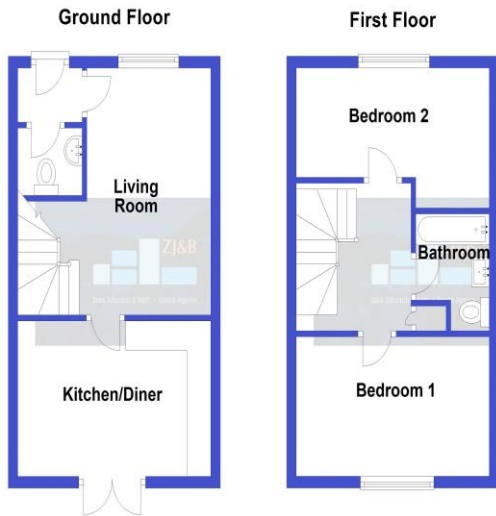

Energy performance certificate (EPC)

12 Chesters Place Shrewsbury SY2 6GB	Energy rating B	Valid until 13 September 2032
Certificate number: 9348-8042-8341-2713-1214		
Property type End-terrace house		
Total floor area 62 square metres		
<p>Rules on letting this property</p> <p>Properties can be let if they have an energy rating from A to E.</p> <p>You can read guidance for landlords on the regulations and exemptions from the law on the energy performance certificate website.</p>		
<p>Energy efficiency rating for this property</p> <p>This property's current energy rating is B. It has the potential to be A.</p> <p>See how to improve this property's energy performance.</p>		

FLOOR PLANS FOR GUIDANCE ONLY