



LOUGHBOROUGH PARK, SW9

£475,000

Two Double Bedrooms
Private Balcony
Two Bathrooms
Open Plan Kitchen-Living
Private Bike Storage
Energy Rating: B

@marshandparsons
marshandparsons.co.uk

MARSH &
PARSONS



ABOUT THE PROPERTY

A spacious two bedroom apartment spanning just shy of 850 sqft comprising of two double bedrooms, two bathrooms, a stylish kitchen offering ample storage and integrated appliances and a generous open plan dining-living area leading onto a private balcony. Offered chain free with a long lease.

Farlow House is situated in a modern development within easy walking distance to the vast array of shops, cafes and restaurants of central Brixton and Herne Hill village, the open green spaces of Brockwell Park and its historic Lido with easy access to the excellent transport links of



STEP INSIDE LOUGHBOROUGH PARK

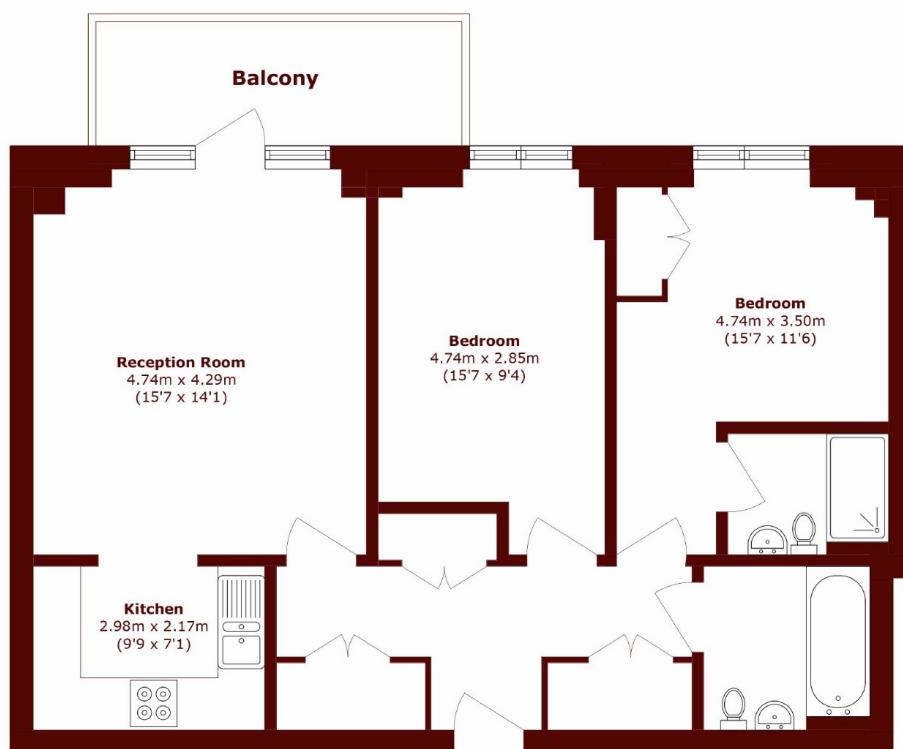

Total area (approx.): 78.2 sq. m (841.7 sq. ft)

Balcony area (approx.): 7.5 sq. m (80.7 sq. ft)

Brixton
020 7733 4595

Energy Rating: B We aim to make our particulars both accurate and reliable. However, they are not guaranteed; nor do they form part of an offer or contract. If you require clarification on any points then please contact us, especially if you're traveling some distance to view. Please note that appliances and heating systems have not been tested and therefore no warranties can be given as to their good working order

**MARSH &
PARSONS**