



## Somerton Road, NW2

£350,000

A stunning one bedroom flat fully refurbished to a high specification, located within a purpose built development. This top floor flat has a fully integrated kitchen, a double bedroom and a bathroom including both a shower and a bath. Further benefits include private parking, a boarded loft space and a lease exceeding 160 years.

Somerton Road is conveniently located for local amenities and transport links including Cricklewood station (Thameslink), David Lloyd gym and Brent Cross shopping centre. The A406, A5 and M1 are also within 1 mile of the property.

### Features

- One Bedroom Flat
- Fully Refurbished
- Fully Fitted Bathroom
- Chain Free
- Fantastic Boarded Loft Space
- Private Parking

Somerton Road,  
London, NW2

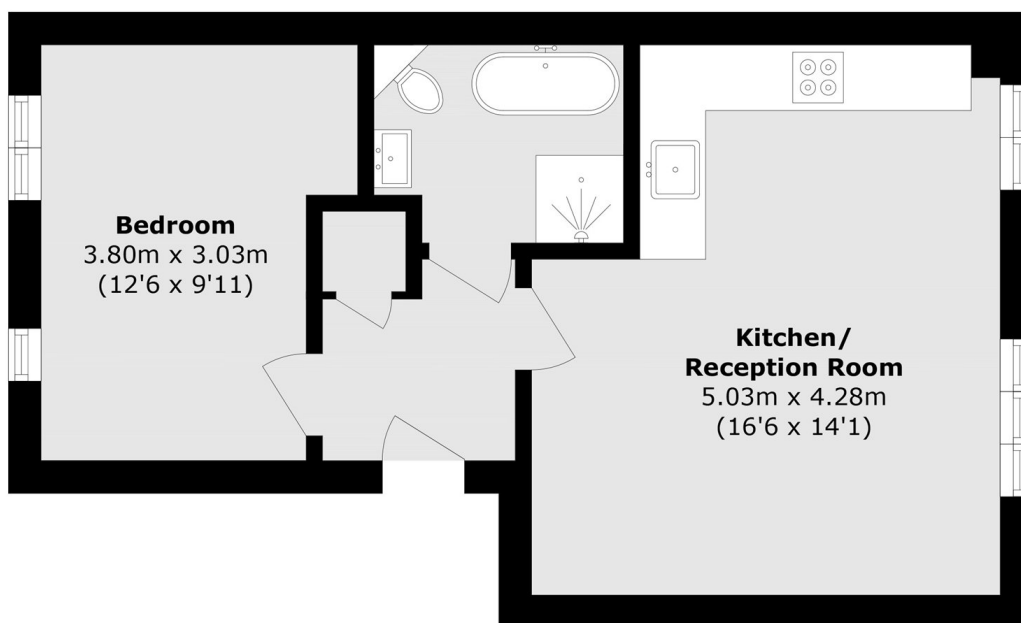

Total area (approx.): 38.5 sq. m (414.4 sq. ft)