



5 Greenlaw Drive, Newton Mearns, G77 6NL

www.nicolestateagents.co.uk



Nicol Estate Agents



Nicol Estate Agents

Situation

A hugely popular suburb, Newton Mearns is a welcoming, family friendly town, with a fantastic, lively and inclusive community. If you choose to live in Newton Mearns, you will have access to some of Scotland's highest attaining primary and secondary schools, Eastwood High School and St. Ninian's High School.

Newton Mearns is located approximately 9 miles from Glasgow City Centre. Commuter routes are served by the M77, M8 and Glasgow Orbital motorways which also provide 30 minute journey times to both Glasgow and Prestwick international airports. There are regular train and bus services to Glasgow, East Kilbride and the beautiful Ayrshire coast.

Recognised as providing amongst the highest standards of local amenities, Newton Mearns offers an array of healthcare centres, banks and libraries and a broad range of supermarkets, boutique shops and restaurants, including The Avenue Shopping Centre and Greenlaw Retail Park which includes Waitrose, Tesco Metro, Aldi and a range of bars and restaurants.

Local sports and recreational facilities include David Lloyd's, Parklands Country Club, East Renfrewshire and Whitecraigs Golf Clubs, Whitecraigs Tennis and Rugby club, as well as East Renfrewshire Council's own excellent sports and leisure facilities at Eastwood Toll. If you are an outdoors lover, Rouken Glen Park, voted Best Park in the UK 2016, is nearby with walking trails through the woods, a great adventure play area, a skate park, five a side football pitches and a boating pond.









Nicol Estate Agents

Property Description

Seldom available, a well presented four/five bedroom detached family home built by Miller Homes, located within the quiet residential pocket of Greenlaw Drive, close to Mearns Cross, The Avenue Shopping Centre and popular East Renfrewshire Schooling.

This property extends to around 1,885 Sqft (154 Sqm) and has been upgraded and well maintained by the present owners and affords well appointed flexible split level accommodation, arranged over two floors, well designed for family living and comprises:

Ground Floor: Generous welcoming reception hall with good storage and staircase to upper level, Bedroom one is spacious with fitted wardrobes and attractive refitted ensuite shower room. Bedroom two, also benefits from an ensuite shower room.

First Floor: Upper landing affords access to majority of the accommodation. Generous and well presented sitting room. Bay window dining room. Both the dining room and sitting room enjoy partial views over the surrounding area and towards Glasgow City Centre and beyond. Home office/bedroom five with Bi-Fold doors to rear. Well appointed refitted dining sized kitchen with a full complement of wall mounted and floor standing units, complementary worktop surfaces and integrated appliances. Upgraded utility room with door to garden. Bedroom three with fitted wardrobes. Bedroom four with fitted wardrobes. An attractively refitted house bathroom completes the accommodation.

The property is further complemented by an upgraded gas central heating and replacement double glazing.

Well-tended landscaped gardens, enclosed rear garden with decked terrace. A garden room provides a perfect space for home working or a gym studio, complete with Bi-Fold doors.

An monobloc driveway provides off street parking and leads to an integral garage

www.nicolestateagents.co.uk



















Nicol Estate Agents

Viewing

By appointment through
Nicol Estate Agents
Newton Mearns

Outgoings

East Renfrewshire Council
Band G

Fixtures & Fittings

Only items specifically mentioned in the sale particulars are included in the sale price.

Energy Efficiency Rating

Band C

Services

The property will be supplied by mains water, gas and electricity. Gas central heating.

Local Authority

East Renfrewshire Council
Council headquarters
Eastwood Park
Rouken Glen Road
Giffnock G46 6UG
Tel: (0141) 577 3000

Property Reference

3615

5 Greenlaw Drive, Newton Mearns

Approximate Gross Internal Area
Main House 1885 sq ft - 175.12 sq m
Garage 207 sq ft - 19.27 sq m
Garden Room 87 sq ft - 8.08 sq m
Total 2179 sq ft - 202.47 sq m

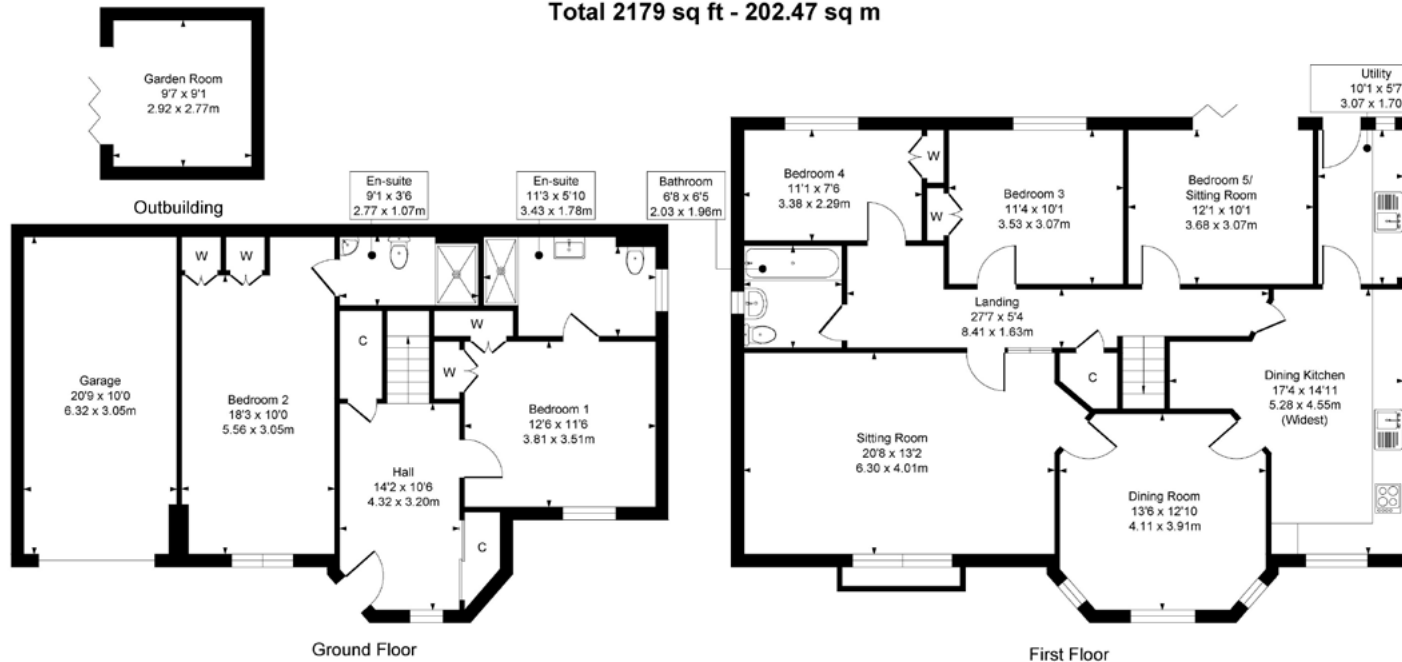

SKETCH PLAN FOR ILLUSTRATIVE PURPOSES ONLY All measurements, walls, doors, windows, fitting and appliances, their sizes and locations are approximate only. They cannot be regarded as being a representation by the seller, nor their agent. We believe these details to be accurate however it is not guaranteed and they do not form any part of a contract. Fixtures and fittings are not included unless specified in the enclosed. Photographs are for general information and it must not be inferred that any item is included for sale with the property.

46 Ayr Road, Newton Mearns, Glasgow G46 6SA | 0141 616 3960 | fax 0141 258 2761 | mail@nicolestateagents.co.uk

1 Helena Place, Busby Road, Clarkston, G76 7RB | 0141 638 4541 | fax 0141 258 2761 | clarkston@nicolestateagents.co.uk



www.nicolestateagents.co.uk