

£1,150 PCM *Unfurnished*

AVAILABLE NOW - UNFURNISHED

A bright and spacious, well presented, top floor, one bedroom apartment. Located in a quiet and tucked away position at the end of a cul-de-sac on the sought after Conegra Road. High Wycombe train station (which connects to London Marylebone in less than 30 minutes) and the town centre are both located just a short walk from the property.

The accommodation comprises: entrance hall, spacious lounge/diner with far reaching views over Wycombe Valley, contemporary fitted kitchen, large double bedroom and family bathroom. The property further benefits: Gas central heating to radiators, allocated parking bay, visitors permit, well maintained communal gardens and double glazing throughout.

HOLDING FEE: £265.38

DEPOSIT REQUIRED: £1,326.90

- ONE BEDROOM APARTMENT
- GOOD CONDITION THROUGHOUT
- SPACIOUS FITTED KITCHEN
- ALLOCATED PARKING BAY
- COMMUNAL GARDENS
- SHORT WALK OF TRAIN STATION
- GAS CENTRAL HEATING
- MODERN BATHROOM
- COUNCIL TAX BAND B
- SOUTH FACING



7 Towers Lea, Conegra Road, High Wycombe, Buckinghamshire, HP13

Estate Agents ~ Lettings Agents ~ Valuers ~ Independent Mortgage Advisors

Conegra Road

Approximate Gross Internal Area
433 sq ft / 40.2 sq m



CH
2.26 = Ceiling Height

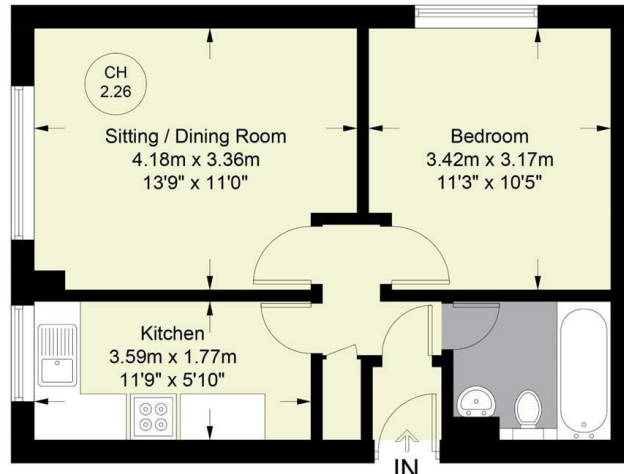

SECOND FLOOR

Floor Plan produced for Hursts by Media Arcade ©.
Illustration for identification purposes only. Window and door openings are approximate. Whilst every attempt is made to assure accuracy in the preparation of this plan, please check all dimensions, shapes and compass bearings before making any decisions reliant upon them.

