



**2 Church Street, Ermington,  
Ivybridge, PL21 9NJ  
Guide Price £230,000**

  
MILLINGTON TUNNICLIFF

2 Church Street,  
Ermington,  
Ivybridge, PL21  
9NJ

## FLOORPLAN

**Ground Floor**  
Approx. 25.9 sq. metres (278.8 sq. feet)

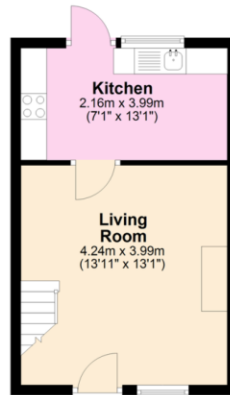

**First Floor**  
Approx. 16.9 sq. metres (182.2 sq. feet)

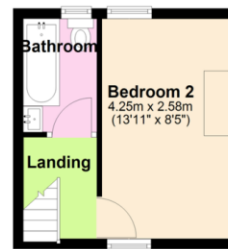

**Second Floor**  
Approx. 17.4 sq. metres (187.5 sq. feet)



Total area: approx. 60.3 sq. metres (648.5 sq. feet)



2



2



1



B



D 67



648.5  
SQFT

## Guide Price £230,000

### SUMMARY

A beautifully presented two bedroom cottage, located in the heart of the popular village of Ermington. The property has been recently updated with a new fitted kitchen, updated bathrooms and newly installed decking area to the rear. The light and airy accommodation is set over three levels, has character features throughout and has countryside views to the front and rear. There is on road parking available to the front of the property. Offered for sale with no onward chain. EPC D 67

No Onward Chain | Countryside Views To The Front And Rear | Located In The Popular Village Of Ermington | Character Features Throughout | Rear Decked Area | Family Bathroom & Ensuite Shower Room | Gas Central Heating & Double Glazing | Newly Fitted Kitchen | Two Good Sized Bedrooms | A Beautifully Presented Cottage

### CONTACT

19 Fore Street, Ivybridge,  
Devon, PL21 9AB

### EMAIL

info@millingtontunnicliff.co.uk

### TEL

01752 896020

www.millingtontunnicliff.co.uk