



**Orchard Grove, Wolverton, Milton Keynes, MK12**

Milton Keynes

**£300,000**

expo.uk

Bedrooms: | Bathrooms: | Receptions:  
2 | 1 | 1

Council Tax Band: B

Tenure: Freehold

Property Type: Semi Detached House

- Open Day 16/05/2026 from 1pm to 3pm by appointment only
- Deceptively spacious two bedroom semi detached home built to a three bedroom footprint
- Modern and well presented throughout ready to move straight into
- Stylish kitchen diner ideal for everyday living and entertaining
- Unique downstairs WC combined with a practical utility space
- Thermal solar panels supporting hot water and helping reduce energy costs
- South east facing rear garden enjoying excellent natural light
- Driveway parking for one vehicle with space for two in tandem
- Well located in Wolverton close to schools, shops, leisure facilities and transport links
- EG1332



ETHAN GAULTER

exp

EG1332

Open Day – 16/05/2026, 1pm to 3pm – All viewings strictly by appointment only.

A beautifully presented and deceptively spacious two bedroom semi detached home in the ever popular area of Wolverton, Milton Keynes. Built with the proportions of a three bedroom home but configured as a generous two bedroom, this property offers excellent space, modern living and fantastic value for money.

Internally, the home is finished to a high standard throughout and is ready to move straight into. The ground floor offers a bright and welcoming living room leading through to a stylish kitchen diner, perfect for both everyday living and entertaining. A real standout feature is the unique downstairs WC combined with a utility space, adding practicality rarely found in homes of this type.

Upstairs, the property continues to impress with two well proportioned bedrooms that benefit from the larger than average footprint, alongside a modern family bathroom.

One of the key benefits of this home is the inclusion of thermal solar panels, which directly support the hot water system. This helps reduce energy costs by heating water throughout the day and assisting the central heating system, making the home more efficient and cost effective to run.

Externally, the property boasts a well maintained south east facing rear garden, ideal for enjoying morning and afternoon sun. To the front, there is parking for one vehicle with the ability to accommodate two cars in tandem.

The location is equally appealing. You are approximately an 11 minute walk to Radcliffe Secondary School, around a 4 minute walk to a local convenience shop, and roughly a 12 minute walk to a popular children's play park and Wolverton Swimming and Fitness Centre. Wolverton train station is approximately a 6 minute drive away, offering direct links into London Euston, making this a great option for commuters.

This is a fantastic opportunity to secure a modern, energy efficient home in a well connected and sought after location.

Get in touch today to secure your viewing slot.

Photo Disclaimer:

Please note that some images have been digitally enhanced and may include virtual staging, edited finishes, or improvements such as changes to furniture layout, flooring, carpets, and landscaping to demonstrate how the property could look when fully furnished or presented. These images are for illustration purposes only and do not represent items included in the sale. If you are travelling from a distance, we recommend arranging a virtual viewing or contacting us prior to your journey to ensure everything is arranged for your visit

Early viewing is highly recommended to fully appreciate the space, character, and location on offer.



Approx Gross Internal Area  
67 sq m / 722 sq ft

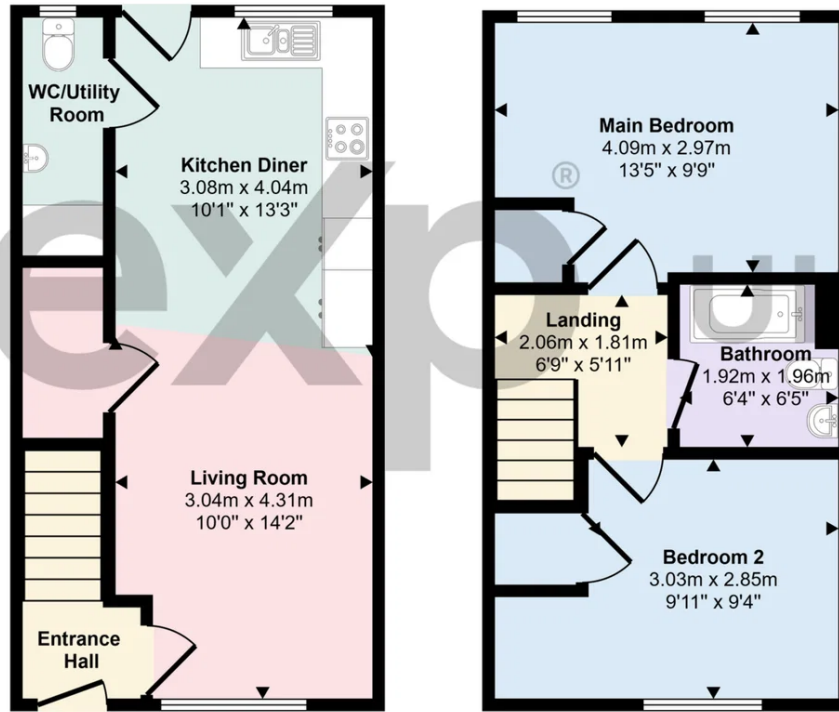

This floorplan is only for illustrative purposes and is not to scale. Measurements of rooms, doors, windows, and any items are approximate and no responsibility is taken for any error, omission or mis-statement. Icons of items such as bathroom suites are representations only and may not look like the real items. Made with Made Snappy 360.



Score	Energy rating	Current	Potential
92+	A		
81-91	B		83 B
69-80	C	78 C	
55-68	D		
39-54	E		
21-38	F		
1-20	G		

Ethan Gaulter  
Local Estate Agent  
01908 464 950  
Ethan.Gaulter@exp.uk.com  
<https://ethangaulter.exp.uk.com>

ETHAN GAULTER

