

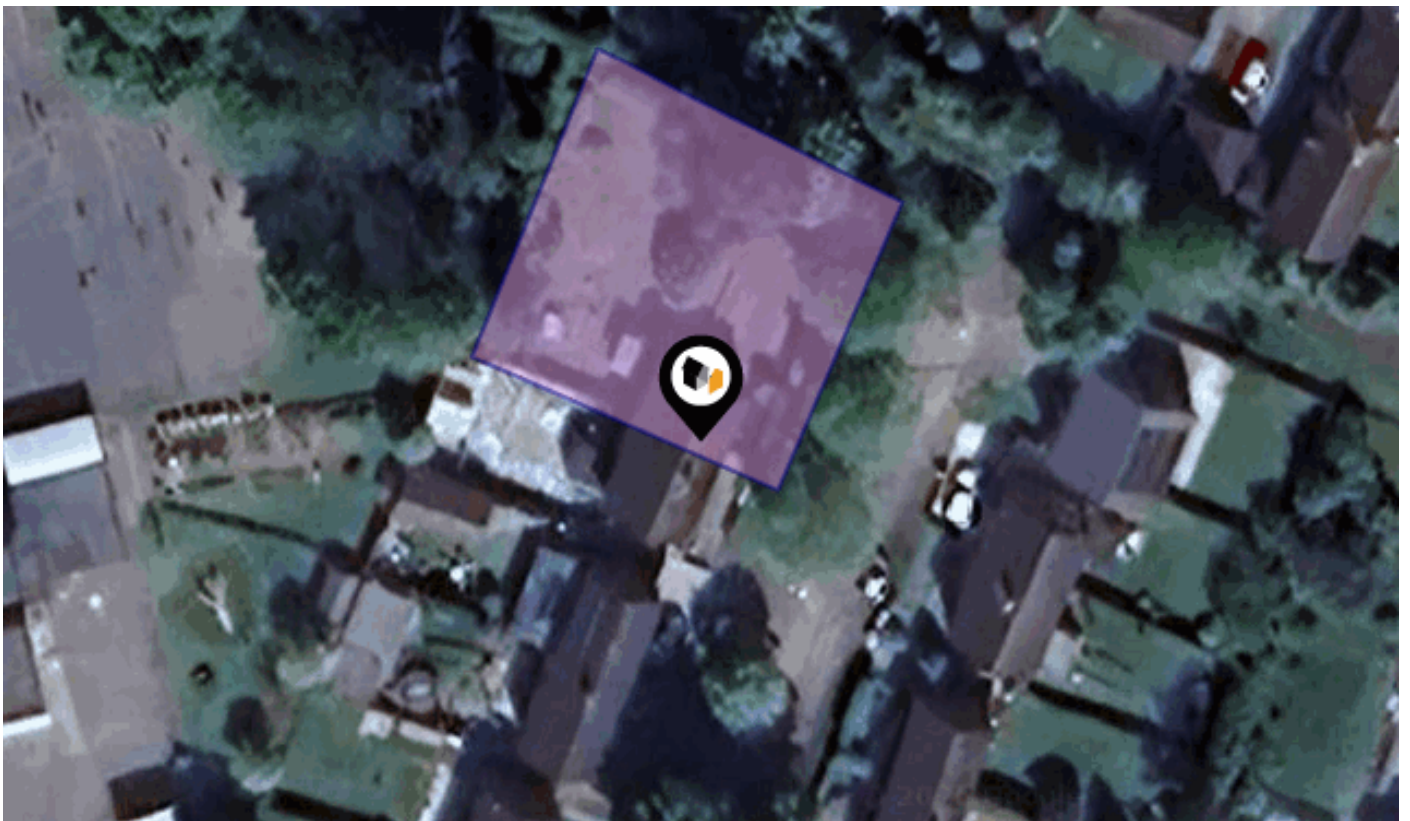

See More Online

KFB: Key Facts For Buyers

A Guide to This Property & the Local Area
Tuesday 07th April 2026



ASH GROVE, GRANTHAM, NG31

Charles Dyson Estate Agents

Elmer House, Finkin Street, Grantham, NG31 6QZ

01476 576688

David.carter@charlesdyson.co.uk

charlesdyson.co.uk





Property

Type:	Semi-Detached	Tenure:	Freehold
Bedrooms:	3		
Floor Area:	871 ft ² / 81 m ²		
Plot Area:	0.18 acres		
Year Built :	1950-1966		
Council Tax :	Band A		
Title Number:	LL34498		

Local Area

Local Authority:	South kesteven
Conservation Area:	No
Flood Risk:	
• Rivers & Seas	Very low
• Surface Water	Very low

Estimated Broadband Speeds (Standard - Superfast - Ultrafast)

6 mb/s	91 mb/s	10000 mb/s

Mobile Coverage: (based on calls indoors)



Satellite/Fibre TV Availability:



Planning History

This Address

Planning records for: *Ash Grove, Grantham, NG31*

Reference - S24/0989	
Decision:	Decided
Date:	10th June 2024
Description:	Proposed residential development to create upto 2no semi detached dwellings (outline planning permission with all matters reserved)

Gallery Photos



Gallery Photos

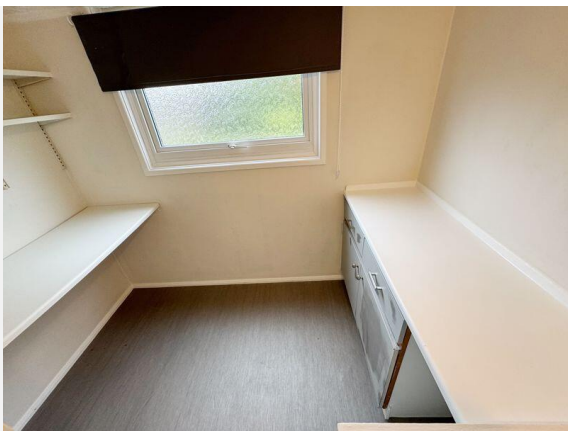



ASH GROVE, GRANTHAM, NG31

GROUND FLOOR
497 sq.ft. (46.1 sq.m.) approx.

1ST FLOOR
418 sq.ft. (38.9 sq.m.) approx.

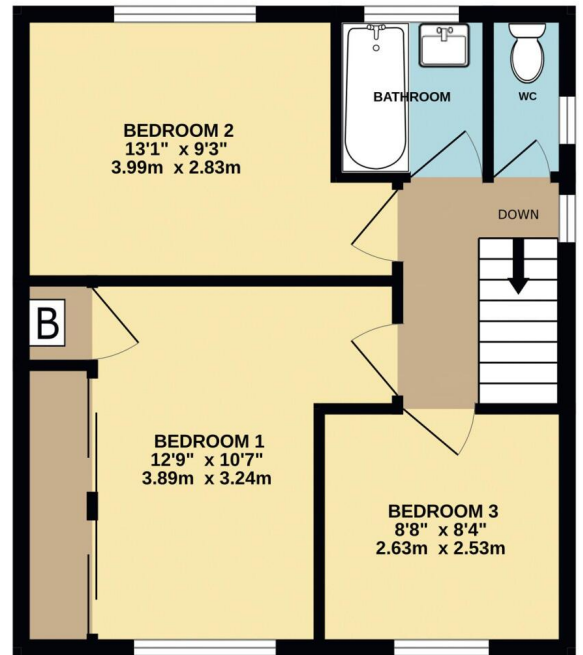
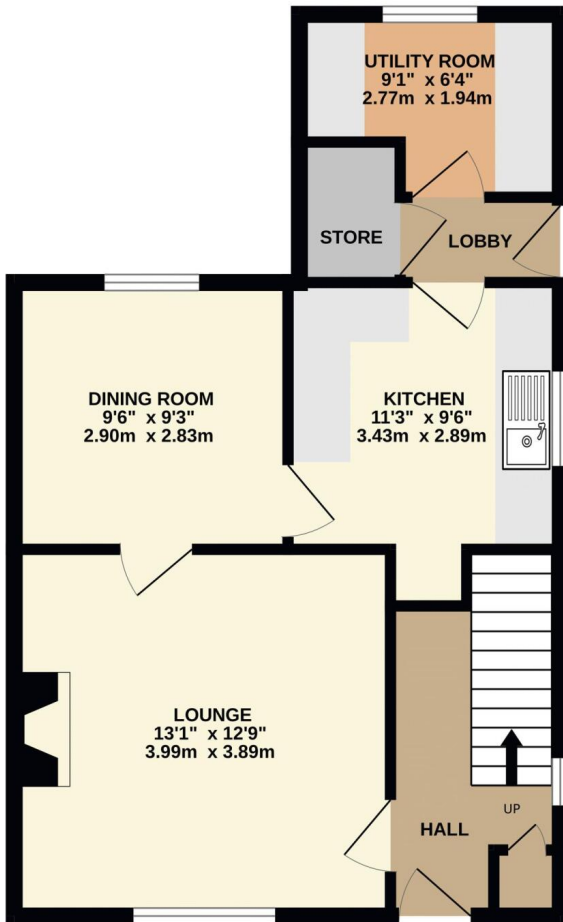

TOTAL FLOOR AREA : 915 sq.ft. (85.0 sq.m.) approx.

Whilst every attempt has been made to ensure the accuracy of the floorplan contained here, measurements of doors, windows, rooms and any other items are approximate and no responsibility is taken for any error, omission or mis-statement. This plan is for illustrative purposes only and should be used as such by any prospective purchaser. The services, systems and appliances shown have not been tested and no guarantee as to their operability or efficiency can be given.
Made with Metropix ©2025

Property EPC - Certificate

NG31

Energy rating

C

Valid until 18.07.2033

Score	Energy rating	Current	Potential
92+	A		
81-91	B		85 B
69-80	C	70 c	
55-68	D		
39-54	E		
21-38	F		
1-20	G		

Additional EPC Data

Property Type:	House
Build Form:	Semi-Detached
Transaction Type:	Marketed sale
Energy Tariff:	Dual
Main Fuel:	Mains gas (not community)
Main Gas:	Yes
Flat Top Storey:	No
Top Storey:	0
Glazing Type:	Double glazing installed before 2002
Previous Extension:	0
Open Fireplace:	1
Ventilation:	Natural
Walls:	Cavity wall, filled cavity
Walls Energy:	Average
Roof:	Pitched, 100 mm loft insulation
Roof Energy:	Average
Main Heating:	Boiler and radiators, mains gas
Main Heating Controls:	Programmer, room thermostat and TRVs
Hot Water System:	From main system
Hot Water Energy Efficiency:	Good
Lighting:	Low energy lighting in 50% of fixed outlets
Floors:	Solid, no insulation (assumed)
Total Floor Area:	81 m ²

Market

House Price Statistics

10 Year History of Average House Prices by Property Type in NG31

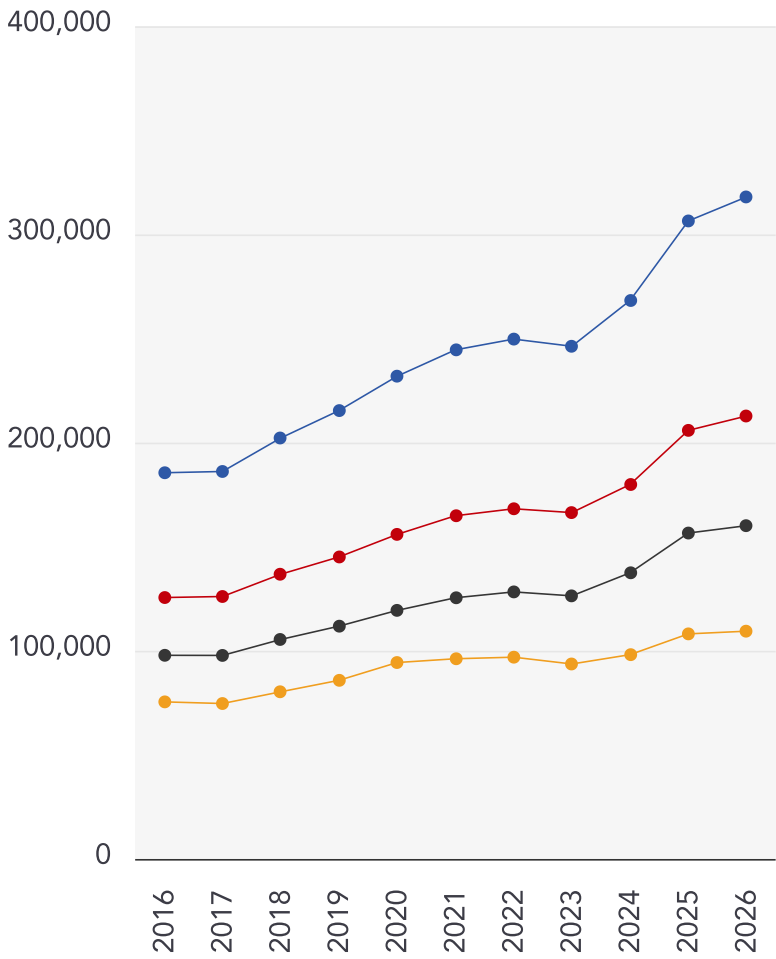

Detached

+71.41%

Semi-Detached

+69.43%

Terraced

+63.64%

Flat

+44.99%

This map displays nearby coal mine entrances and their classifications.

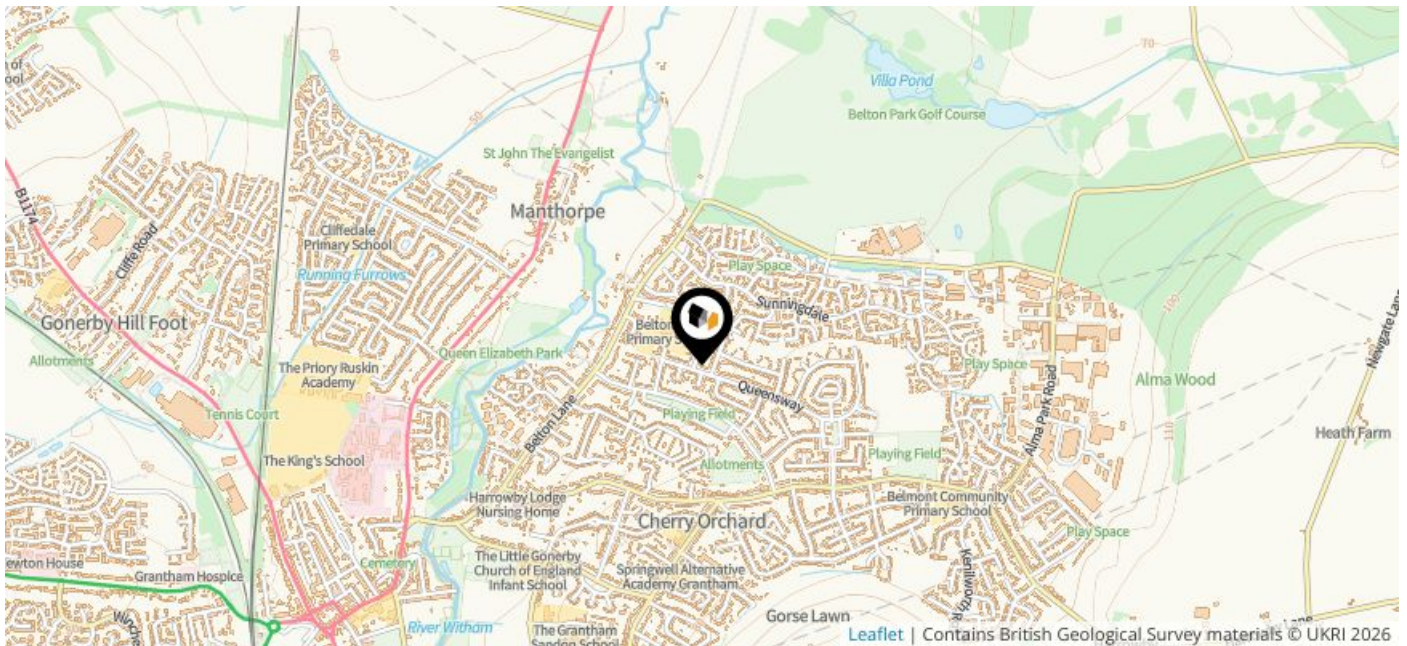

Mine Entry

- ✕ Adit
- ✕ Gutter Pit
- ✕ Shaft

The Coal Authority has records of over 175,000 mine entries within the UK captured in the National Coal Mining database, derived from sources including abandonment plans, geological and topographical plans.

Coal mining activity is recorded as far back as the 13th century, but prior to 1872 there was no requirement to deposit abandonment plans. It is therefore believed there may be many unrecorded mine entries of which the Authority has no information or knowledge. These entries do not, therefore, appear within the Authority's national dataset as shown on this map.

Maps

Conservation Areas

This map displays nearby official conservation areas. Every local authority in England has at least one conservation area. Most are designated by the Council as the local planning authority, though Historic England and the Secretary of State also have the power to create them.

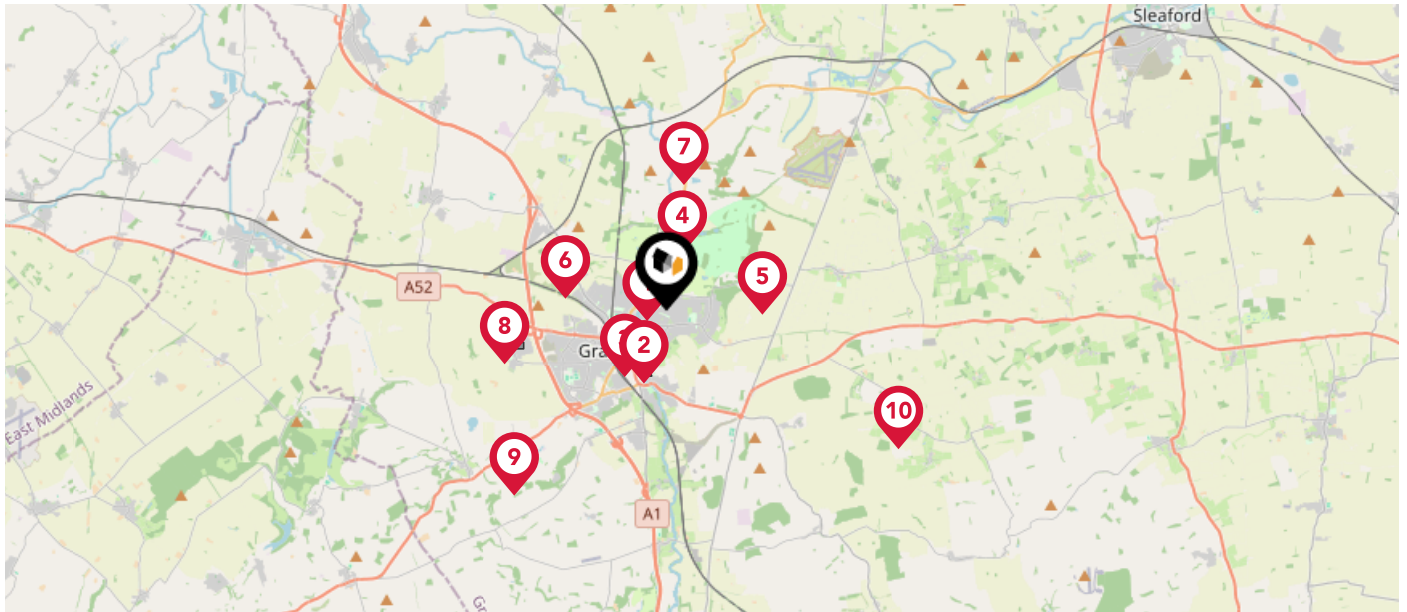

Nearby Conservation Areas

- 1 Manthorpe
- 2 St. Anne's
- 3 Grantham
- 4 Belton
- 5 Londonthorpe
- 6 Great Gonerby
- 7 Barkston
- 8 Barrowby (Part 1)
- 9 Harlaxton
- 10 Ropsley

Maps

Council Wards

The UK is divided into wards that are used for local elections to elect local government councillors. Sometimes these are known as 'electoral divisions'. Population counts can vary substantially between wards, but the national average is about 5,500

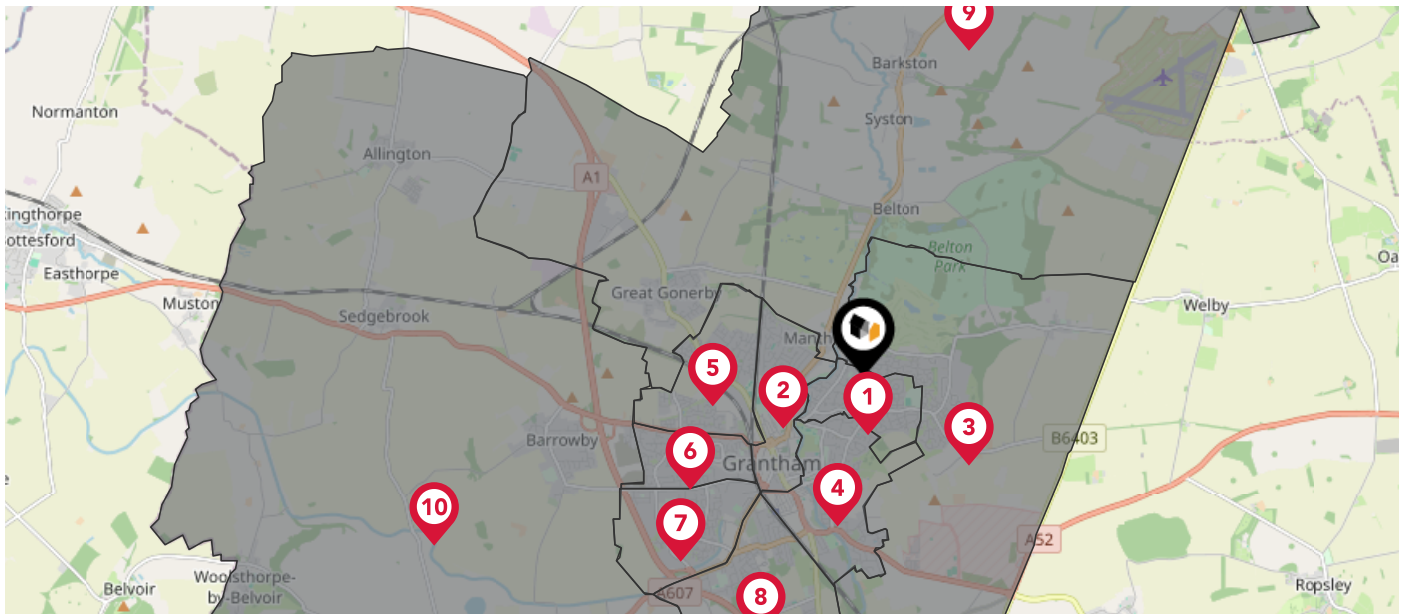

Nearby Council Wards

- 1 Grantham Harrowby Ward
- 2 Grantham St. Wulfram's Ward
- 3 Belmont Ward
- 4 Grantham St. Vincent's Ward
- 5 Grantham Arnoldfield Ward
- 6 Grantham Barrowby Gate Ward
- 7 Grantham Earlesfield Ward
- 8 Grantham Springfield Ward
- 9 Peascliffe & Ridgeway Ward
- 10 Belvoir Ward

This map displays the noise levels from nearby network rail and HS1 railway routes that affect this property...

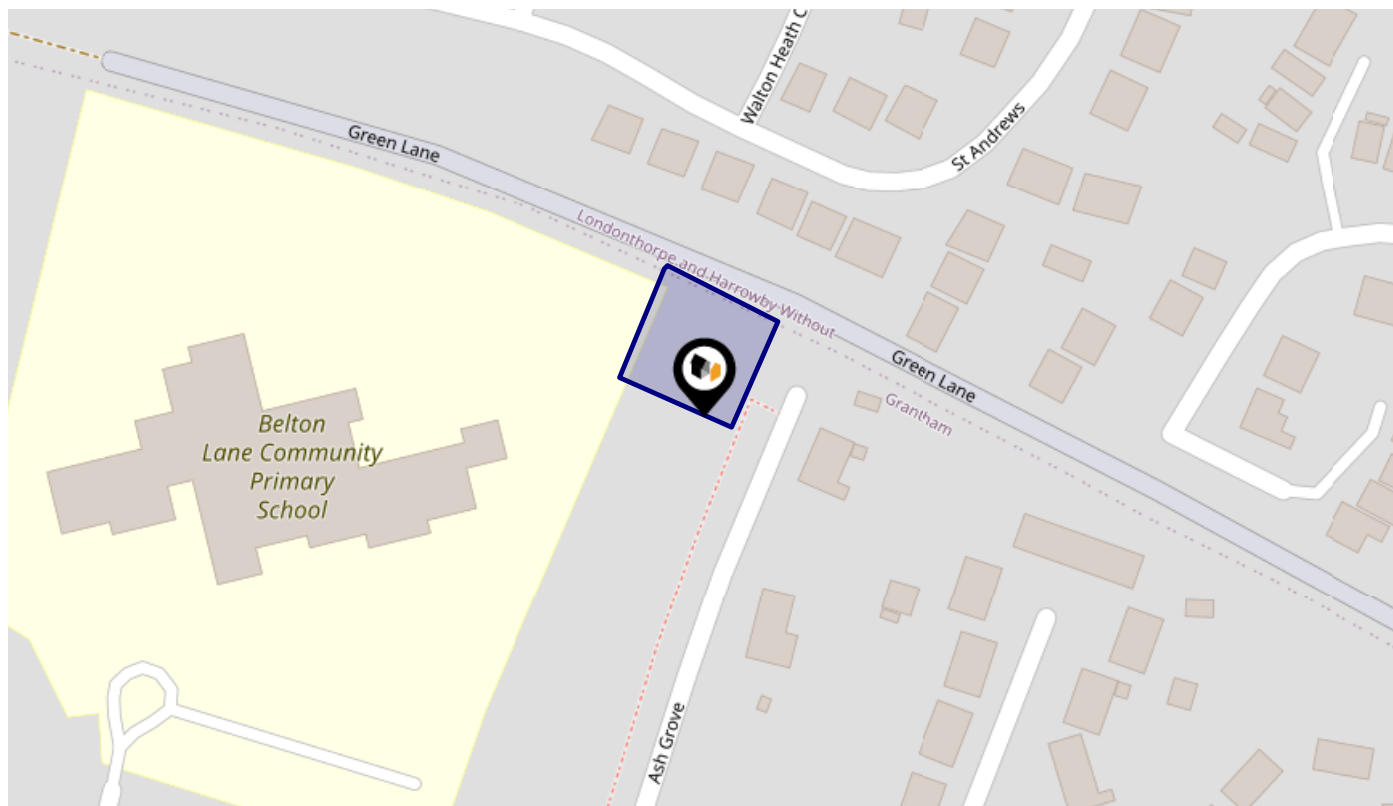

Rail Noise Data

This data indicates the level of noise according to the strategic noise mapping of rail sources within areas with a population of at least 100,000 people (agglomerations) and along Network Rail and HS1 traffic routes.

The data indicates the annual average noise levels for the 16-hour period between 0700 - 2300.

Noise levels are modelled on a 10m grid at a receptor height of 4m above ground, polygons are then produced by merging neighbouring cells within the following noise classes:

5		75.0+ dB	■
4		70.0-74.9 dB	■
3		65.0-69.9 dB	■
2		60.0-64.9 dB	■
1		55.0-59.9 dB	■

Flood Risk

Rivers & Seas - Flood Risk

This map shows the chance of flooding from rivers and / or the sea, taking into account flood defences and their condition.

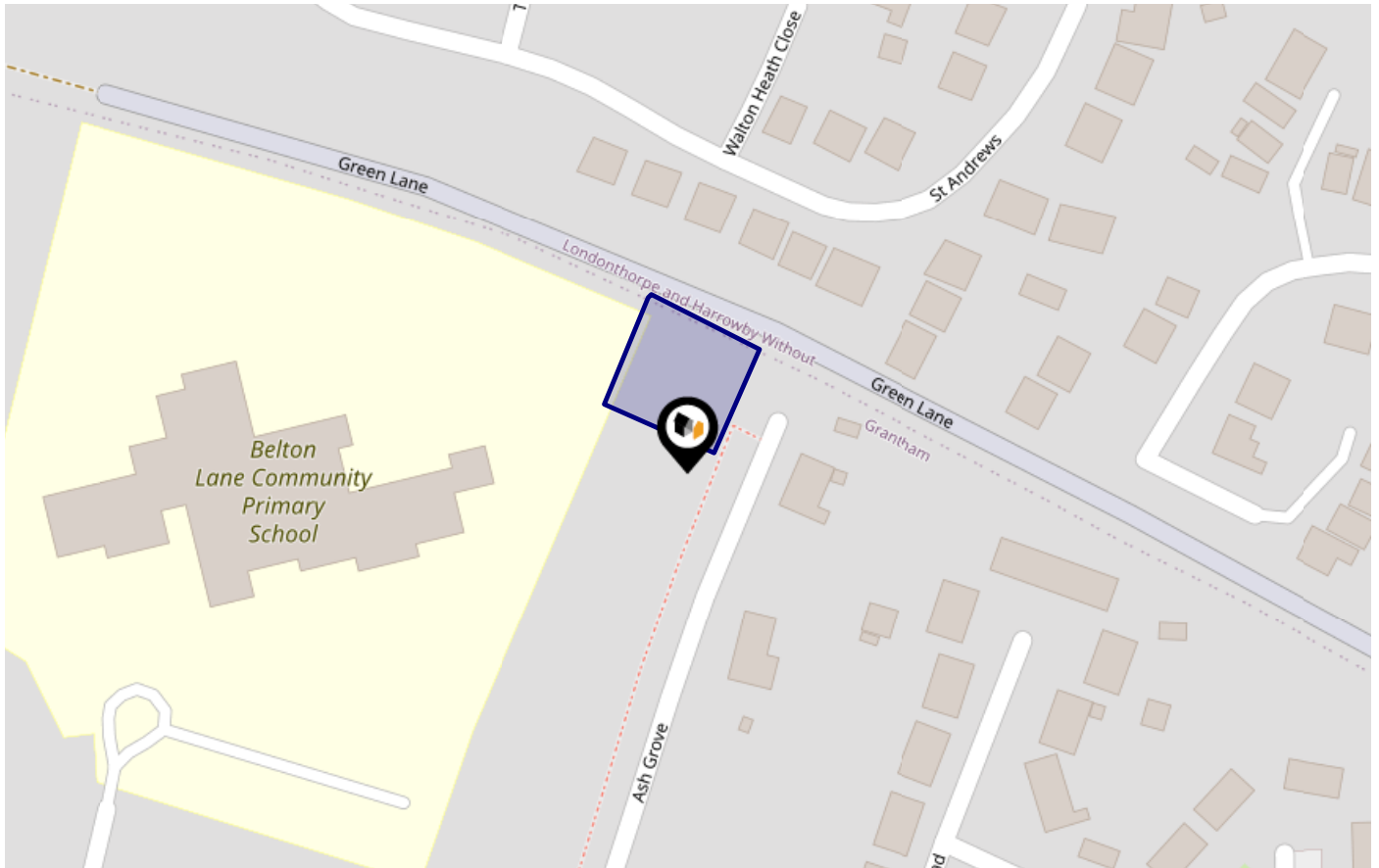

Risk Rating: Very low

The map does not contain sufficient information for it to be used to determine flood risk to individual properties, but it does give you an indication of whether your area may be affected by surface water flooding at this risk level.

- **High Risk** - an area which has a chance of flooding of greater than 1 in 30 (3.3%) in any one year.
- **Medium Risk** - an area which has a chance of flooding of greater than 1 in 100 (1.0%) in any one year.
- **Low Risk** - an area which has a chance of flooding of greater than 1 in 1000 (0.1%) in any one year.
- **Very Low Risk** - an area in which the risk is below 1 in 1000 (0.1%) in any one year.

Chance of flooding to the following depths at this property:



Flood Risk

Rivers & Seas - Climate Change

This map shows the future chance of flooding from rivers and / or the sea **between 2036 and 2069**, taking into account flood defences and their condition. The government climate change models cannot predict exactly when the chance of flooding will go up. It could happen at any time during the time period.

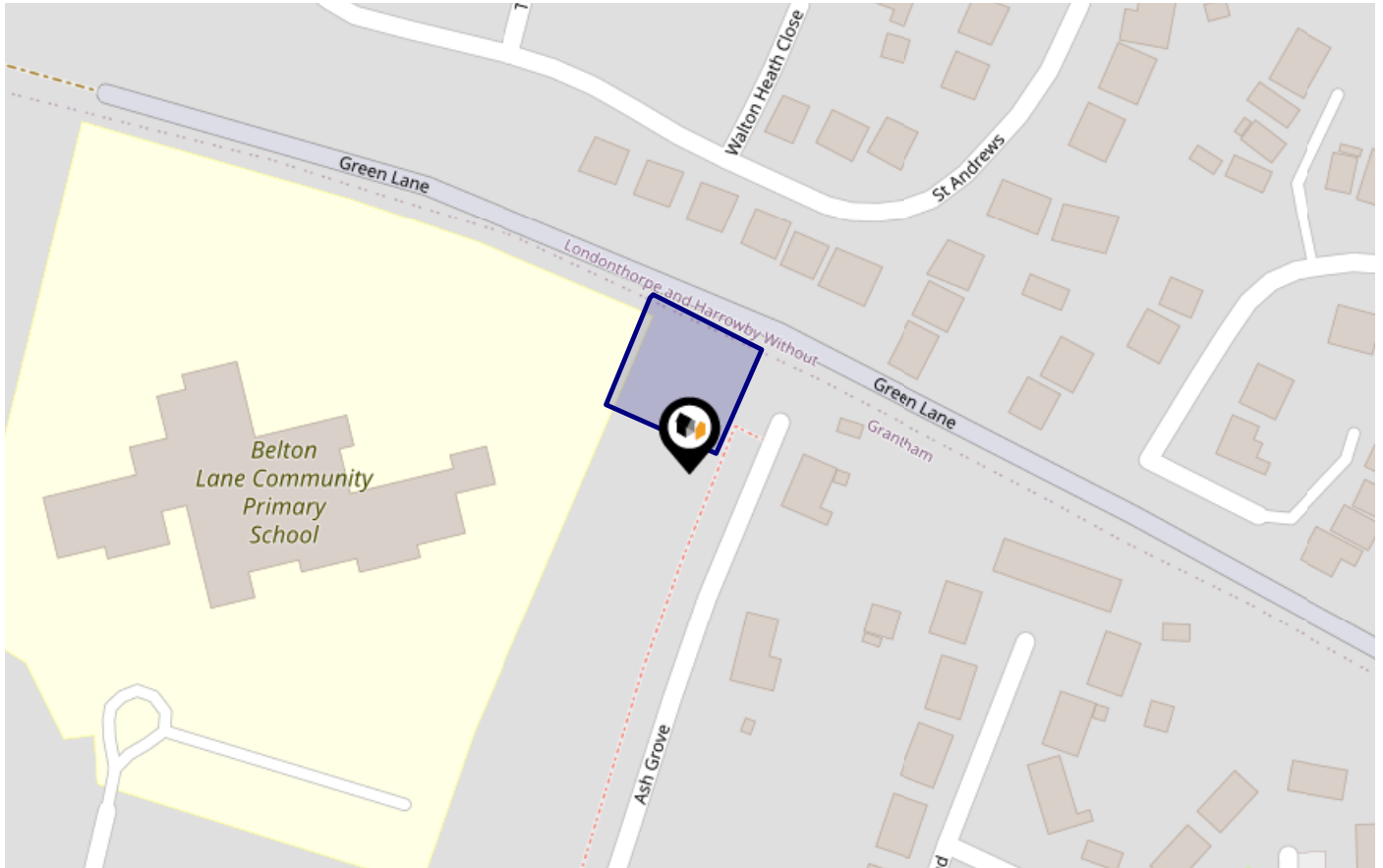

Risk Rating: Very low

The map does not contain sufficient information for it to be used to determine flood risk to individual properties, but it does give you an indication of whether your area may be affected by surface water flooding at this risk level.

- **High Risk** - an area which has a chance of flooding of greater than 1 in 30 (3.3%) in any one year.
- **Medium Risk** - an area which has a chance of flooding of greater than 1 in 100 (1.0%) in any one year.
- **Low Risk** - an area which has a chance of flooding of greater than 1 in 1000 (0.1%) in any one year.
- **Very Low Risk** - an area in which the risk is below 1 in 1000 (0.1%) in any one year.

Chance of flooding to the following depths at this property:



Flood Risk

Surface Water - Flood Risk

This map shows the chance of flooding where rainwater has nowhere to drain. This kind of flooding can occur far from rivers or seas.

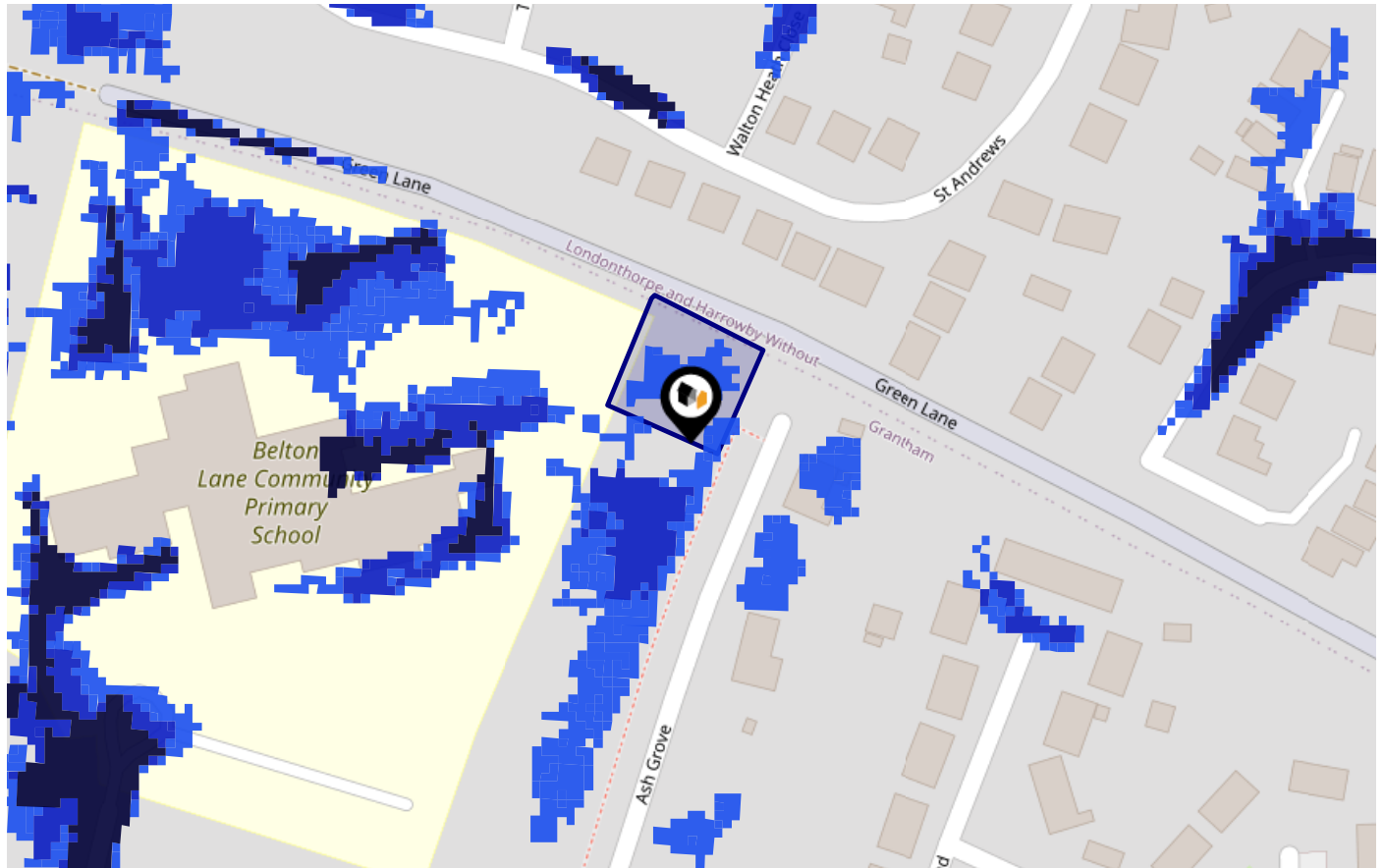

Risk Rating: Very low

The map does not contain sufficient information for it to be used to determine flood risk to individual properties, but it does give you an indication of whether your area may be affected by surface water flooding at this risk level.

- High Risk** - an area which has a chance of flooding of greater than 1 in 30 (3.3%) in any one year.
- Medium Risk** - an area which has a chance of flooding of greater than 1 in 100 (1.0%) in any one year.
- Low Risk** - an area which has a chance of flooding of greater than 1 in 1000 (0.1%) in any one year.
- Very Low Risk** - an area in which the risk is below 1 in 1000 (0.1%) in any one year.

Chance of flooding to the following depths at this property:



Flood Risk

Surface Water - Climate Change

This map shows the future chance of flooding **between 2040 and 2060** where rainwater has nowhere to drain. This kind of flooding can occur far from rivers or seas. The government climate change models cannot predict exactly when the chance of flooding will go up. It could happen at any time during the time period.

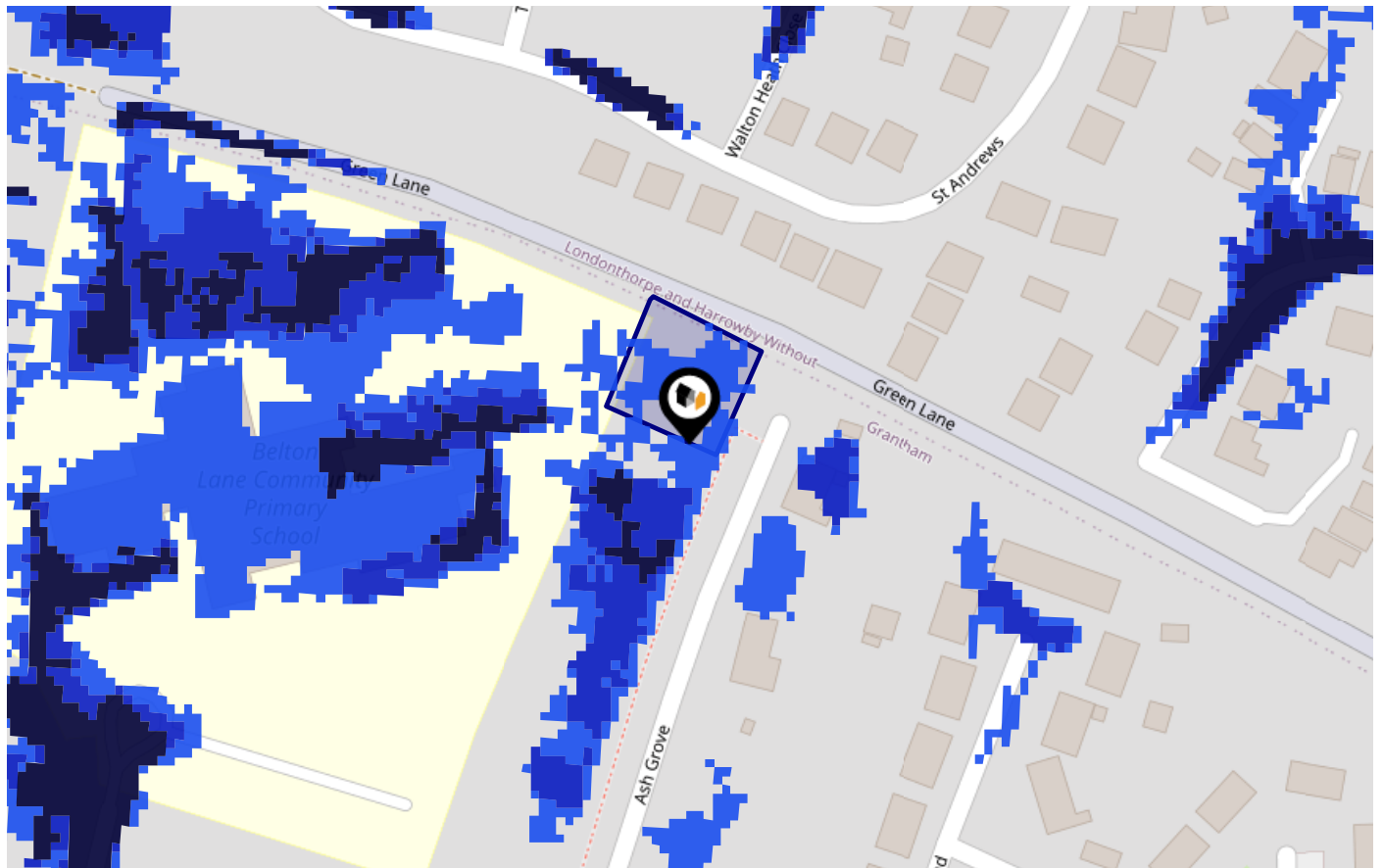

Risk Rating: Very low

The map does not contain sufficient information for it to be used to determine flood risk to individual properties, but it does give you an indication of whether your area may be affected by surface water flooding at this risk level.

- High Risk** - an area which has a chance of flooding of greater than 1 in 30 (3.3%) in any one year.
- Medium Risk** - an area which has a chance of flooding of greater than 1 in 100 (1.0%) in any one year.
- Low Risk** - an area which has a chance of flooding of greater than 1 in 1000 (0.1%) in any one year.
- Very Low Risk** - an area in which the risk is below 1 in 1000 (0.1%) in any one year.

Chance of flooding to the following depths at this property:



Maps

Green Belt

This map displays nearby areas that have been designated as Green Belt...

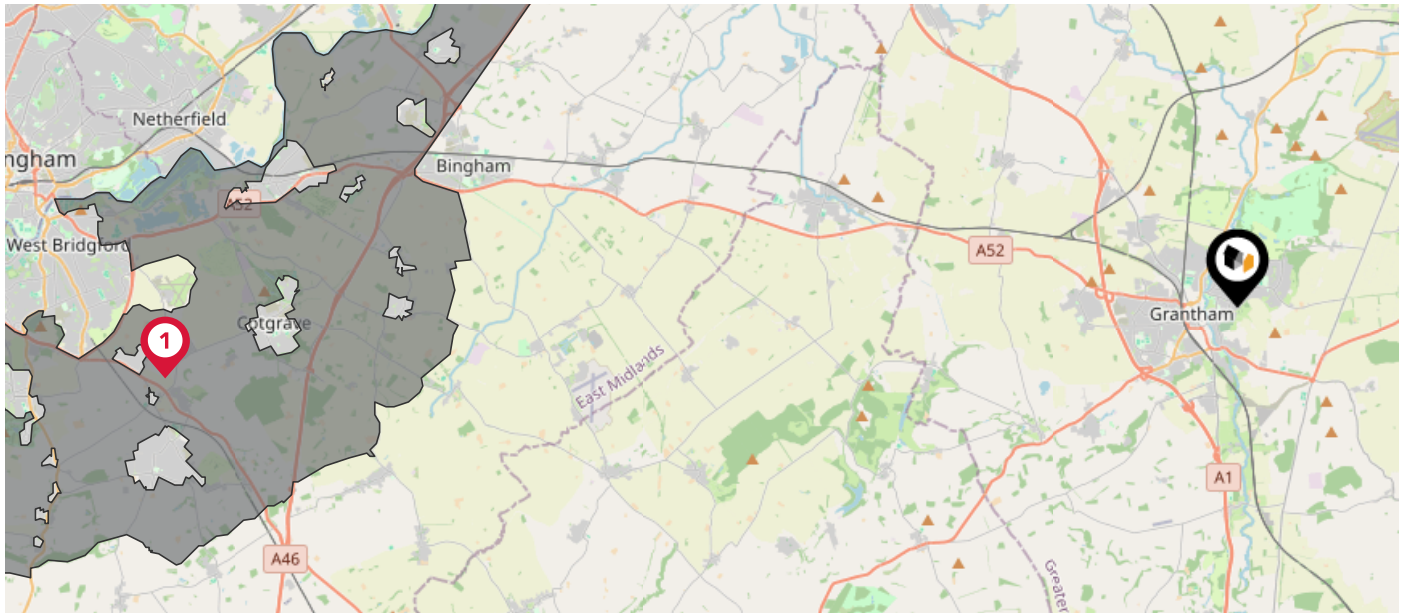

Nearby Green Belt Land



Derby and Nottingham Green Belt - Rushcliffe

This map displays the location of known landfill sites. Historic sites are where there is no environmental permit in force. Active sites are currently authorised by the Environment Agency under Environmental Permitting Regulations.

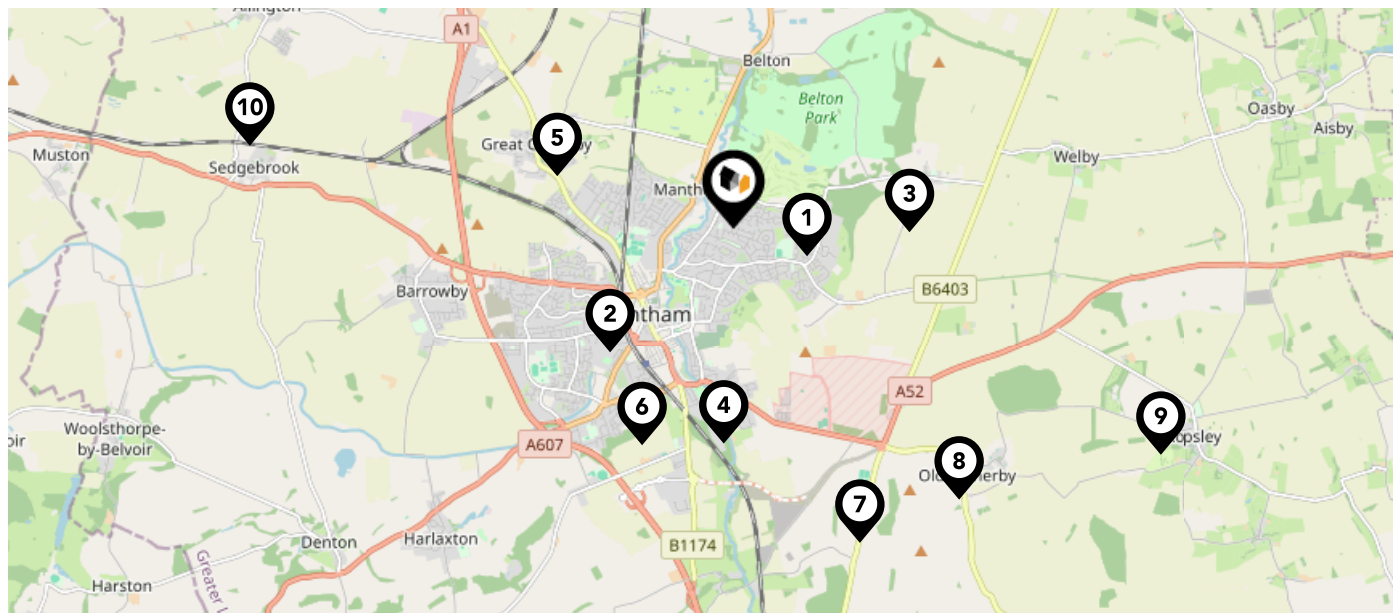

Nearby Landfill Sites









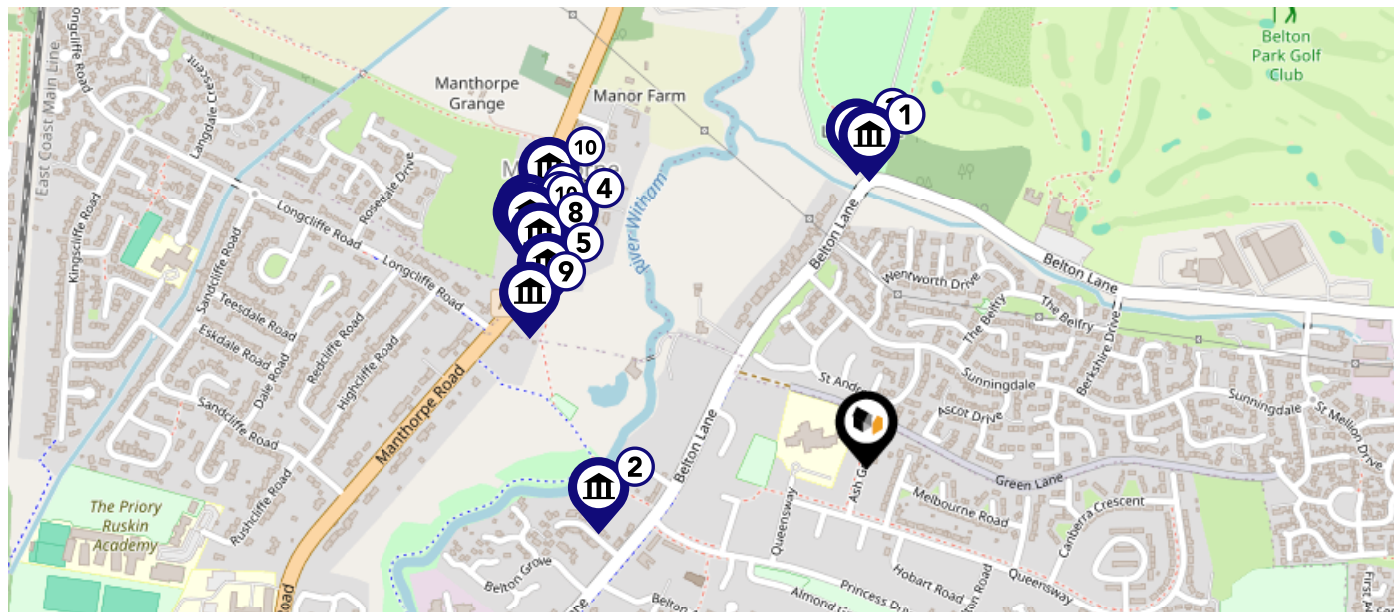

1	Land to West of Ruston Road-Alma Park Industrial Estate, Grantham, Lincolnshire	Historic Landfill
2	Autumn Park Landfill-Autumn Park Industrial Estate, Dysart Road, Grantham, Lincolnshire	Historic Landfill
3	Disused Quarry-Newgate Lane, Londonthorpe, Grantham, Lincolnshire	Historic Landfill
4	Bridge End Grove-Grantham, Lincolnshire	Historic Landfill
5	Long Street Landfill Site-Great Gonerby, Grantham	Historic Landfill
6	Caddy Castings-Springfield Road, Grantham	Historic Landfill
7	Woodnook-Woodnook, Lincolnshire	Historic Landfill
8	The Quarry-School Lane, Old Somerby, Lincolnshire	Historic Landfill
9	Somerby Road-Ropsley	Historic Landfill
10	Allington Road-Allington Road, Sedgebrook	Historic Landfill

Maps

Listed Buildings

This map displays nearby listed buildings and protected structures, as well as their listed tier and distance from the target property...





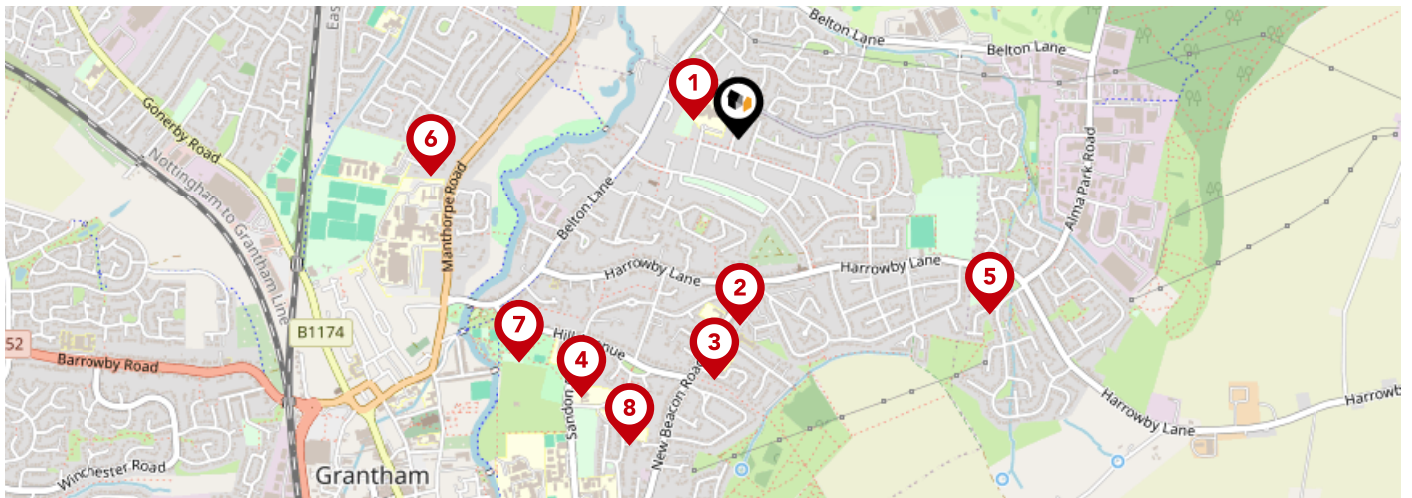



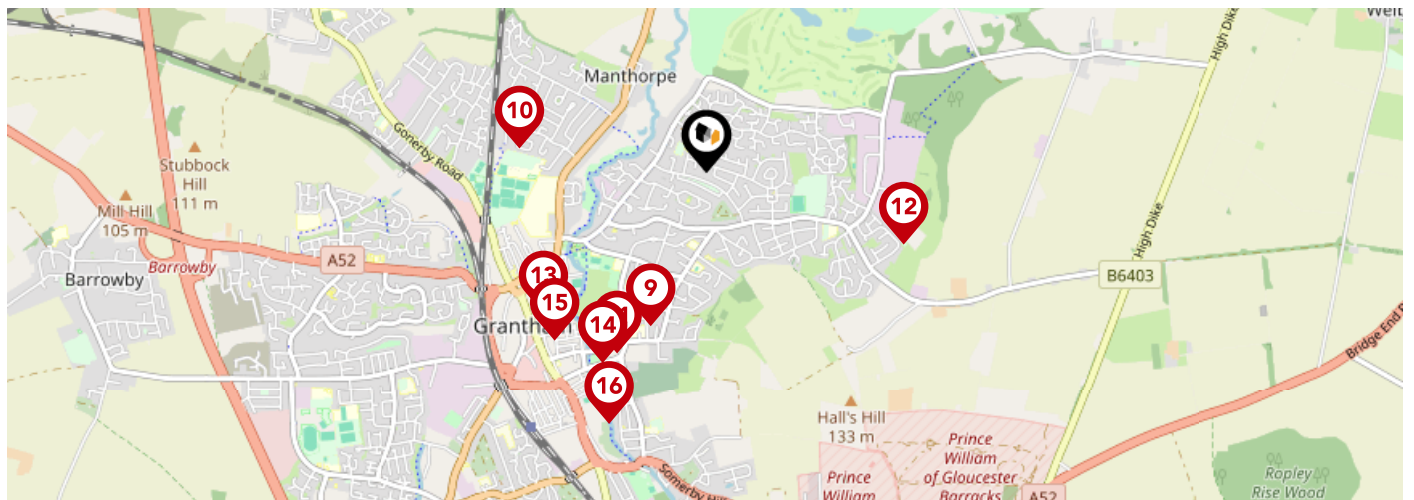

Listed Buildings in the local district	Grade	Distance
 1261877 - South Gates To Belton Park	Grade I	0.3 miles
 1062505 - Harrowby Mill House	Grade II	0.3 miles
 1261867 - South Lodge To Belton Park Londonthorpe	Grade II	0.3 miles
 1298450 - Old Clovers And Attached Boundary Wall	Grade II	0.4 miles
 1236036 - Farm Cottage	Grade II	0.4 miles
 1298449 - 7 And 8, High Road	Grade II	0.4 miles
 1194832 - Wash House Boundary Wall And Railing Between Numbers 6 And 7 High Road	Grade II	0.4 miles
 1236000 - 17, High Road	Grade II	0.4 miles
 1194840 - Holly Cottage	Grade II	0.4 miles
 1264815 - Ivy Lodge	Grade II	0.4 miles
 1235940 - Well Head Between Numbers 6 And 7 High Road	Grade II	0.4 miles



	Nursery	Primary	Secondary	College	Private
1 Belton Lane Community Primary School Ofsted Rating: Good Pupils: 323 Distance:0.11	<input type="checkbox"/>	<input checked="" type="checkbox"/>	<input type="checkbox"/>	<input type="checkbox"/>	<input type="checkbox"/>
2 The Harrowby Church of England Primary School Ofsted Rating: Requires improvement Pupils: 57 Distance:0.42	<input type="checkbox"/>	<input checked="" type="checkbox"/>	<input type="checkbox"/>	<input type="checkbox"/>	<input type="checkbox"/>
3 Springwell Alternative Academy Grantham Ofsted Rating: Good Pupils: 49 Distance:0.54	<input type="checkbox"/>	<input type="checkbox"/>	<input checked="" type="checkbox"/>	<input type="checkbox"/>	<input type="checkbox"/>
4 The Little Gonerby Church of England Primary Academy, Grantham Ofsted Rating: Good Pupils: 116 Distance:0.68	<input type="checkbox"/>	<input checked="" type="checkbox"/>	<input type="checkbox"/>	<input type="checkbox"/>	<input type="checkbox"/>
5 Belmont Community Primary School Ofsted Rating: Good Pupils: 207 Distance:0.68	<input type="checkbox"/>	<input checked="" type="checkbox"/>	<input type="checkbox"/>	<input type="checkbox"/>	<input type="checkbox"/>
6 The Priory Ruskin Academy Ofsted Rating: Outstanding Pupils: 1406 Distance:0.69	<input type="checkbox"/>	<input type="checkbox"/>	<input checked="" type="checkbox"/>	<input type="checkbox"/>	<input type="checkbox"/>
7 Wyndham Park Nursery School Ofsted Rating: Outstanding Pupils: 116 Distance:0.7	<input checked="" type="checkbox"/>	<input type="checkbox"/>	<input type="checkbox"/>	<input type="checkbox"/>	<input type="checkbox"/>
8 Saint Mary's Catholic Voluntary Academy Ofsted Rating: Good Pupils: 200 Distance:0.73	<input type="checkbox"/>	<input checked="" type="checkbox"/>	<input type="checkbox"/>	<input type="checkbox"/>	<input type="checkbox"/>



Area Schools

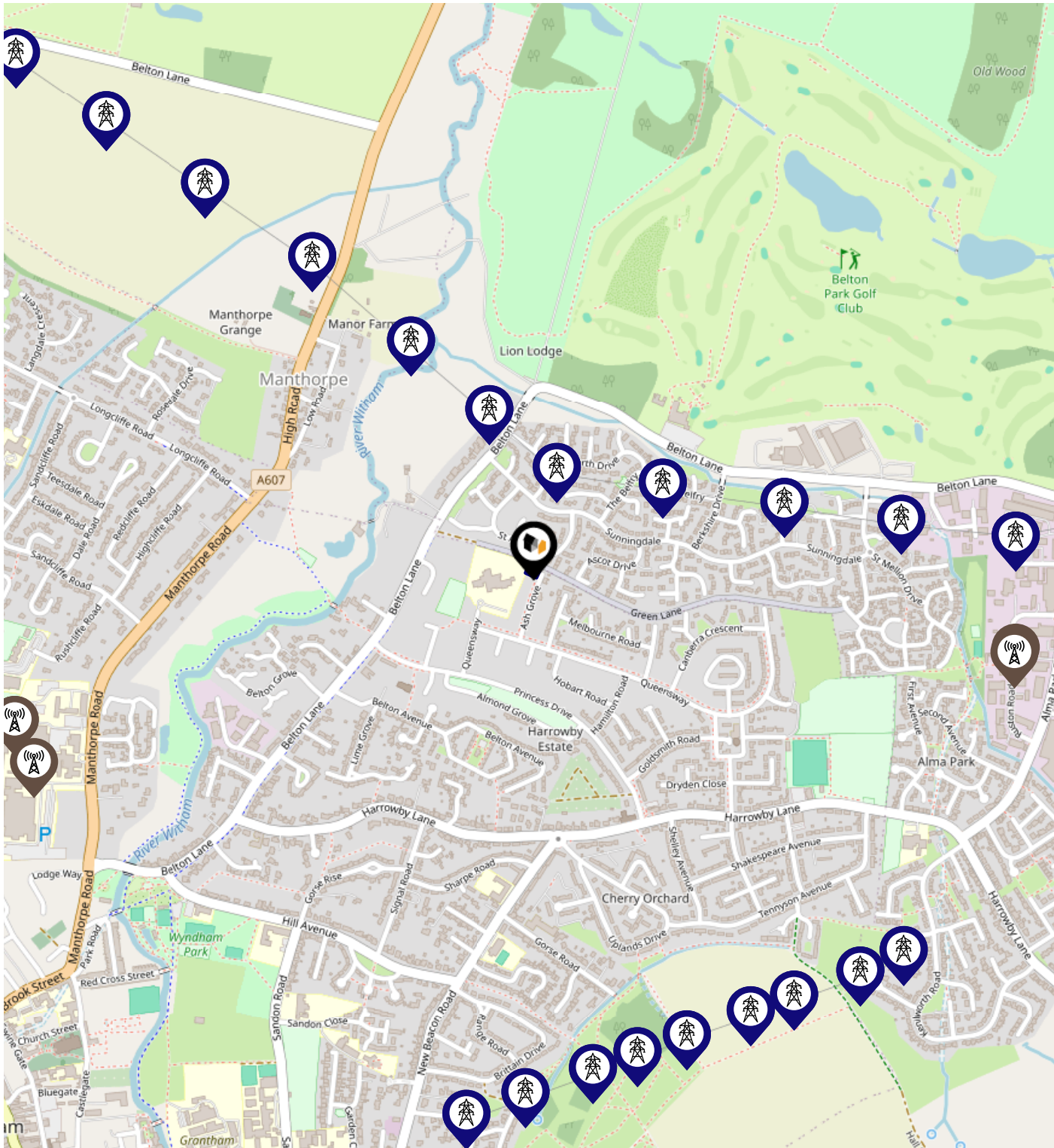

		Nursery	Primary	Secondary	College	Private
	Grantham Additional Needs Fellowship Ofsted Rating: Outstanding Pupils: 251 Distance:0.73	<input type="checkbox"/>	<input type="checkbox"/>	<input checked="" type="checkbox"/>	<input type="checkbox"/>	<input type="checkbox"/>
	Cliffedale Primary School Ofsted Rating: Good Pupils: 289 Distance:0.84	<input type="checkbox"/>	<input checked="" type="checkbox"/>	<input type="checkbox"/>	<input type="checkbox"/>	<input type="checkbox"/>
	Kesteven and Grantham Girls' School Ofsted Rating: Outstanding Pupils: 1188 Distance:0.9	<input type="checkbox"/>	<input type="checkbox"/>	<input checked="" type="checkbox"/>	<input type="checkbox"/>	<input type="checkbox"/>
	Esland Grantham School Ofsted Rating: Good Pupils: 29 Distance:0.94	<input type="checkbox"/>	<input type="checkbox"/>	<input checked="" type="checkbox"/>	<input type="checkbox"/>	<input type="checkbox"/>
	The King's School, Grantham Ofsted Rating: Good Pupils: 1200 Distance:0.96	<input type="checkbox"/>	<input type="checkbox"/>	<input checked="" type="checkbox"/>	<input type="checkbox"/>	<input type="checkbox"/>
	Grantham College Ofsted Rating: Good Pupils:0 Distance:0.97	<input type="checkbox"/>	<input type="checkbox"/>	<input checked="" type="checkbox"/>	<input type="checkbox"/>	<input type="checkbox"/>
	St Wulfram's National Church of England Primary School Ofsted Rating: Requires improvement Pupils: 215 Distance:1.01	<input type="checkbox"/>	<input checked="" type="checkbox"/>	<input type="checkbox"/>	<input type="checkbox"/>	<input type="checkbox"/>
	Dudley House School Ofsted Rating: Good Pupils: 18 Distance:1.2	<input type="checkbox"/>	<input checked="" type="checkbox"/>	<input type="checkbox"/>	<input type="checkbox"/>	<input type="checkbox"/>

Local Area Masts & Pylons



- Key:**
-  Power Pylons
 -  Communication Masts

What is Radon?

Radon is a natural radioactive gas, which enters buildings from the ground. Exposure to high concentrations increases the risk of lung cancer. The UK Health Security Agency (UKHSA) recommends that radon levels should be reduced in homes where the annual average is at or above 200 becquerels per cubic metre (200 Bq/m³).

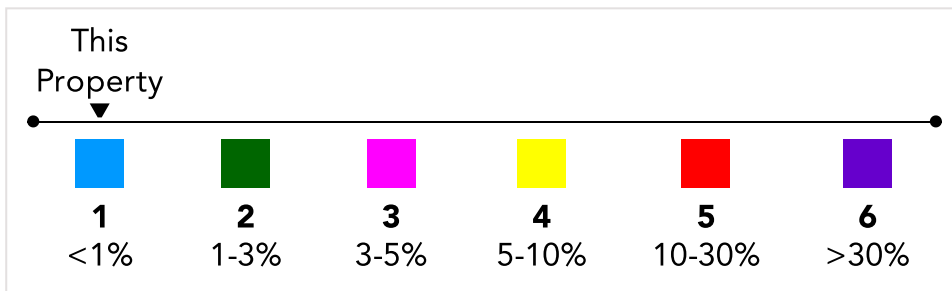
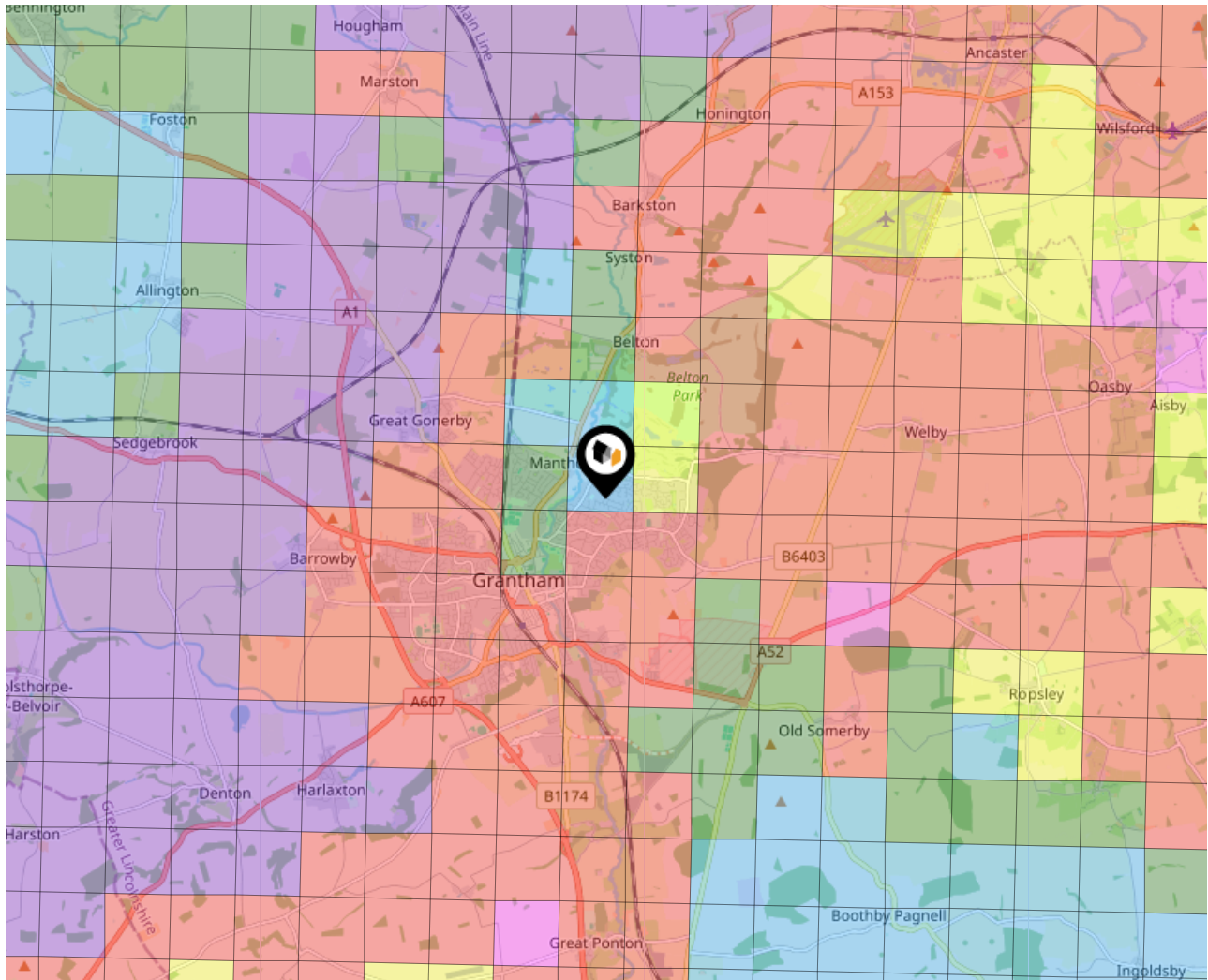

Local Area Road Noise

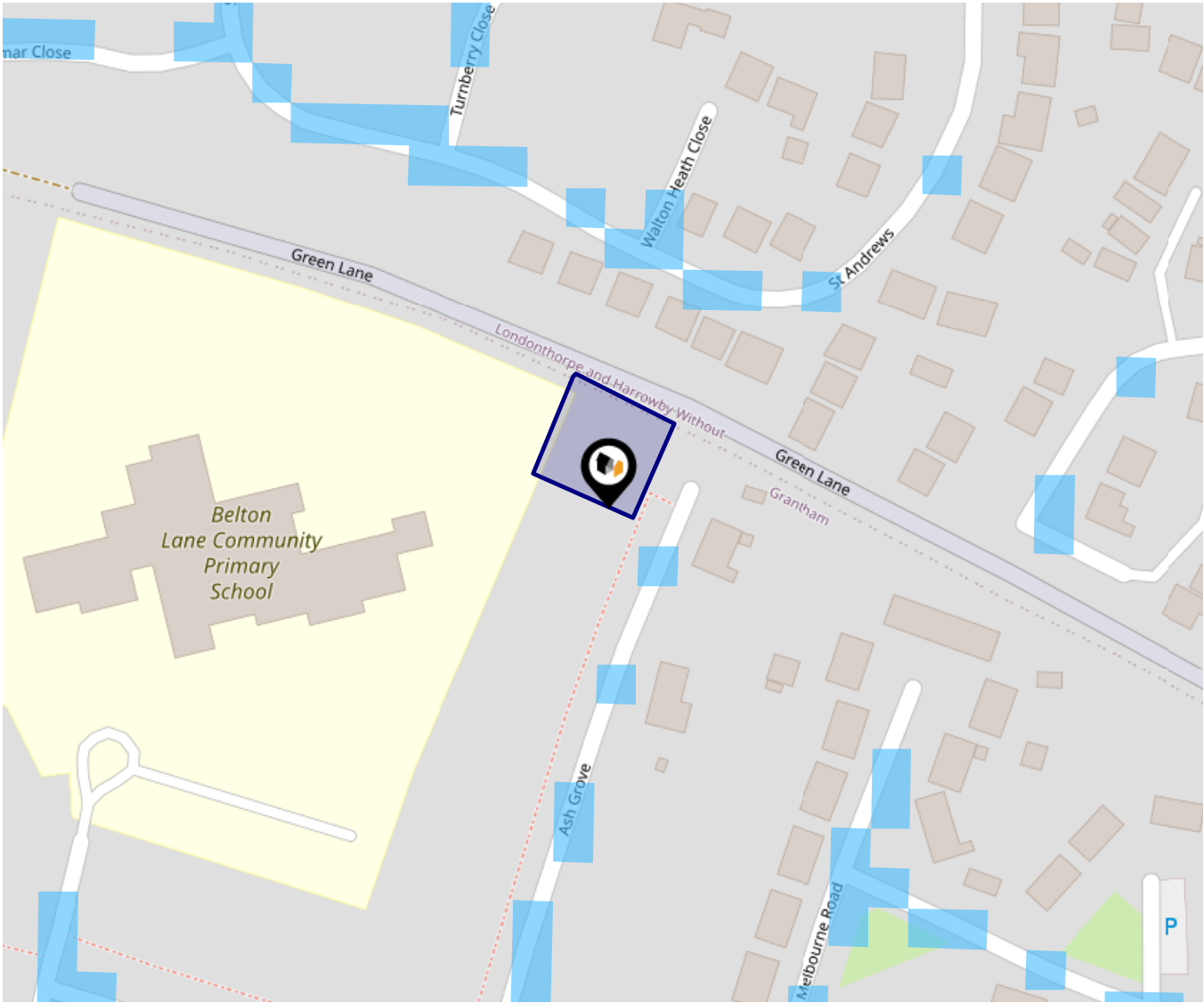

The data indicates the level of noise according to strategic noise sources across all traffic routes. This indicates a 25 house annual average noise level with separate weightings for the evening and the night periods.

- 75.0+ dB
- 70.0-74.9 dB
- 65.0-69.9 dB
- 60.0-64.9 dB
- 55.0-59.9 dB

Ground Composition for this Address (Surrounding square kilometer zone around property)

Carbon Content:	VARIABLE(LOW)	Soil Texture:	LOAM TO CLAY
Parent Material Grain:	ARGILLACEOUS	Soil Depth:	DEEP
Soil Group:	MEDIUM TO HEAVY		

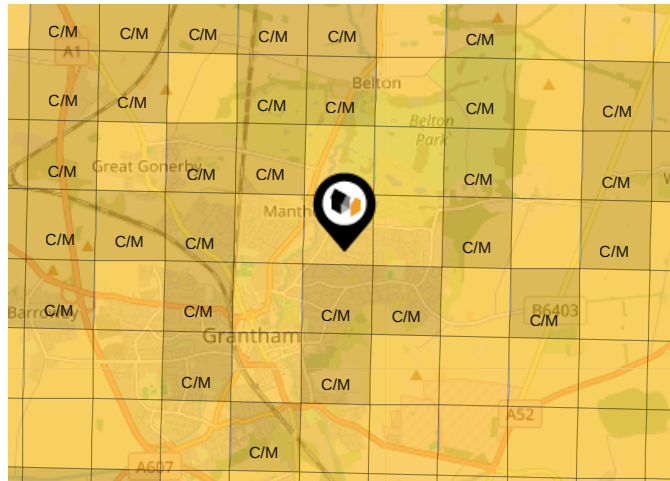

Primary Classifications (Most Common Clay Types)

C/M	Claystone / Mudstone
FPC,S	Floodplain Clay, Sand / Gravel
FC,S	Fluvial Clays & Silts
FC,S,G	Fluvial Clays, Silts, Sands & Gravel
PM/EC	Prequaternary Marine / Estuarine Clay / Silt
QM/EC	Quaternary Marine / Estuarine Clay / Silt
RC	Residual Clay
RC/LL	Residual Clay & Loamy Loess
RC,S	River Clay & Silt
RC,FS	Riverine Clay & Floodplain Sands and Gravel
RC,FL	Riverine Clay & Fluvial Sands and Gravel
TC	Terrace Clay
TC/LL	Terrace Clay & Loamy Loess

Area

Transport (National)

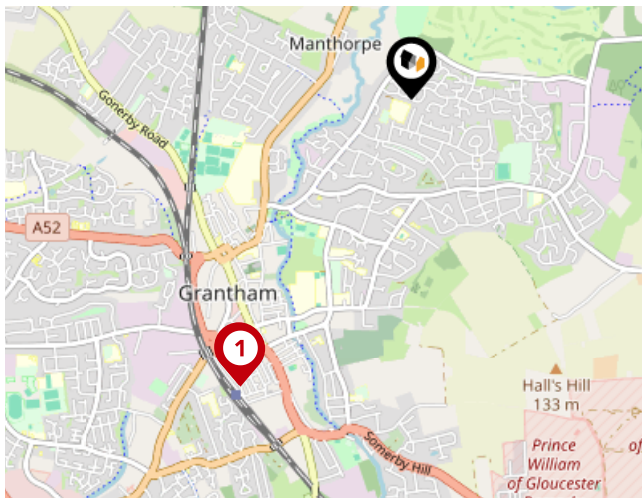

National Rail Stations

Pin	Name	Distance
1	Grantham Rail Station	1.49 miles
2	Grantham Rail Station	1.49 miles
3	Ancaster Rail Station	5.69 miles

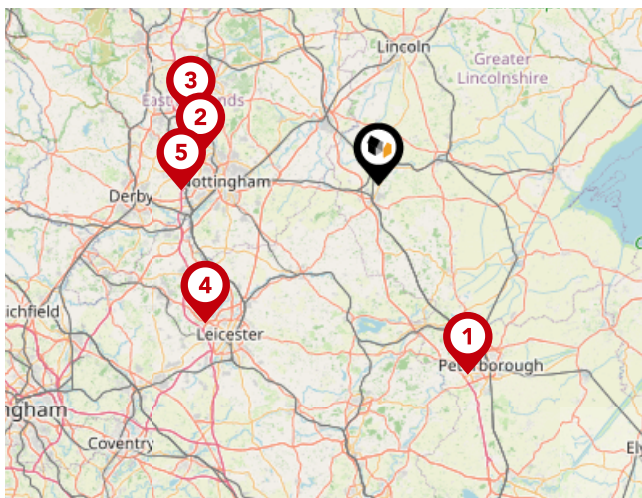

Trunk Roads/Motorways

Pin	Name	Distance
1	A1(M) J17	30.14 miles
2	M1 J26	25.85 miles
3	M1 J27	28.49 miles
4	M1 J21A	31.82 miles
5	M1 J25	28.17 miles

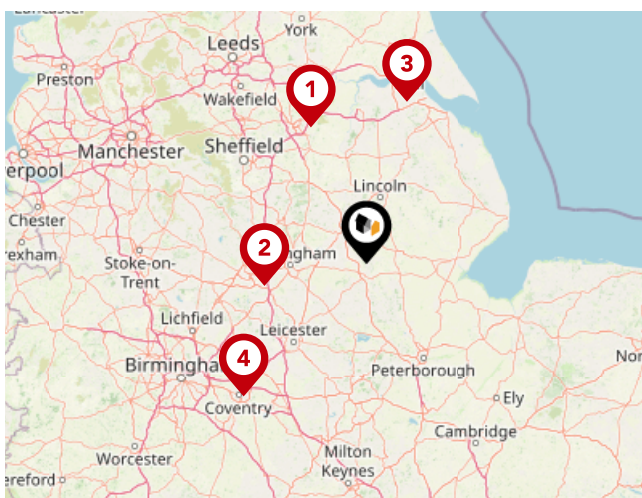

Airports/Helipads

Pin	Name	Distance
1	Finningley	41.64 miles
2	East Mids Airport	30.22 miles
3	Humberside Airport	46.94 miles
4	Baginton	52.54 miles

Area

Transport (Local)

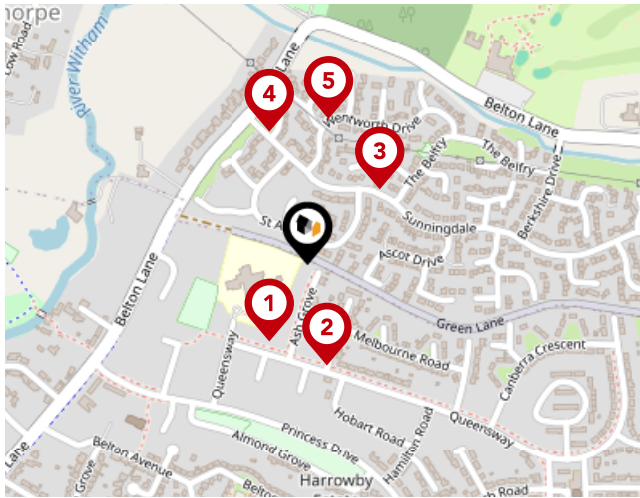

Bus Stops/Stations

Pin	Name	Distance
1	Ash Grove	0.1 miles
2	Melbourne Road	0.11 miles
3	The Belfry	0.12 miles
4	St Andrews	0.15 miles
5	Muirfield	0.17 miles



Charles Dyson Estate Agents

Specialising in Grantham and the surrounding villages, Charles Dyson Estate Agents is committed to providing exceptional levels of customer service, through our dedicated and experienced team.

As most people choose their agent based on their location and experience, we are proud that the majority of our vendors and landlords are either recommended to us or are repeat customers who value the local knowledge of our friendly and experienced staff.

Whether you are buying, renting or selling we guarantee to offer a genuine one-to-one service at an affordable price.

Call us today to discuss your requirements with one of our team who will always be pleased to offer friendly impartial advice.

Testimonial 1



I bought my property through this team so they weren't directly representing me, though I did find them to be very friendly and helpful.

I couldn't get along with my conveyancer who didn't seem to want to know me, but Kristie was able to make up that shortfall by keeping me informed of what was going on from the buyer's side.

On the day I collected my keys they even gave me a welcome box full of some new home goodies.

Testimonial 2



I use Charles Dyson Estate & Letting Agents to manage all of my properties in the Grantham area. It is always my preference to deal with a local estate agent with a family feel, rather than a regional or national agency (that don't really care!).

I first started to use Charles Dyson Estate & Letting Agents in 2021, and three years on, their service continues to be exceptional.

Testimonial 3



Charles Dyson have been absolutely brilliant. A phenomenal service with great communication throughout our property sale. The team were so friendly and warm and made selling our home easy. We received regular updates during the sale and were impressed with the timely and professional service provided. We will definitely use Dysons again in the future.

Testimonial 4



Absolutely fantastic experience using Charles Dyson Estate agents to sell our property. The communication and level of efficiency was outstanding, they were really proactive and made the selling process as easy as possible for us.

Would highly recommend.



/CharlesDysonEstateAgents



/DysonEA



/charlesdysonestateagents/

Charles Dyson Estate Agents Data Quality

We are committed to comprehensive property data being made available upfront to make the home buying and selling process quicker, easier and cheaper. This is why we have partnered with Sprift, the UK's leading supplier of property-specific data.



Contains public sector information licensed under the Open Government License v3.0

The information contained within this report is for general information purposes only.

Sprift Technologies Ltd aggregate this data from a wide variety of sources and while we endeavour to keep the information up to date and correct, we make no representations or warranties of any kind, express or implied, about the completeness, accuracy, reliability, of the information or related graphics contained within this report for any purpose.

Any reliance you place on such information is therefore strictly at your own risk. In no event will we be liable for any loss or damage including without limitation, indirect or consequential loss or damage, or any loss or damage whatsoever arising from loss of data or profits arising out of, or in connection with, the use of this report.



Charles Dyson Estate Agents

Elmer House, Finkin Street, Grantham,
NG31 6QZ

01476 576688

David.carter@charlesdyson.co.uk

charlesdyson.co.uk

