



Whitebeam Way, North Baddesley, Southampton, SO52 9FZ

welcome to

Whitebeam Way, North Baddesley, Southampton

Fox and Sons Romsey have immense pleasure in offering for sale this three-bedroom semi-detached house, located in a quiet cul-de-sac within the highly desirable area of North Baddesley. This three-bedroom home presents an excellent opportunity for both first-time buyers and investors alike.



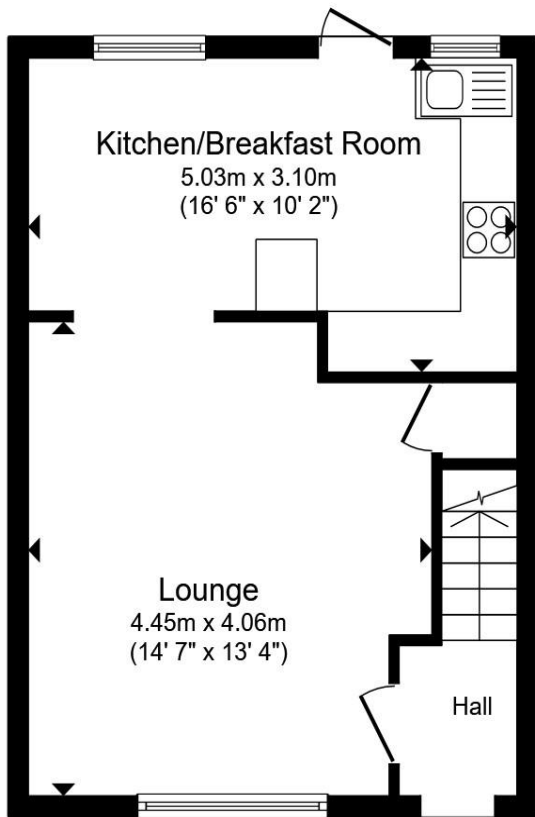

Ground Floor

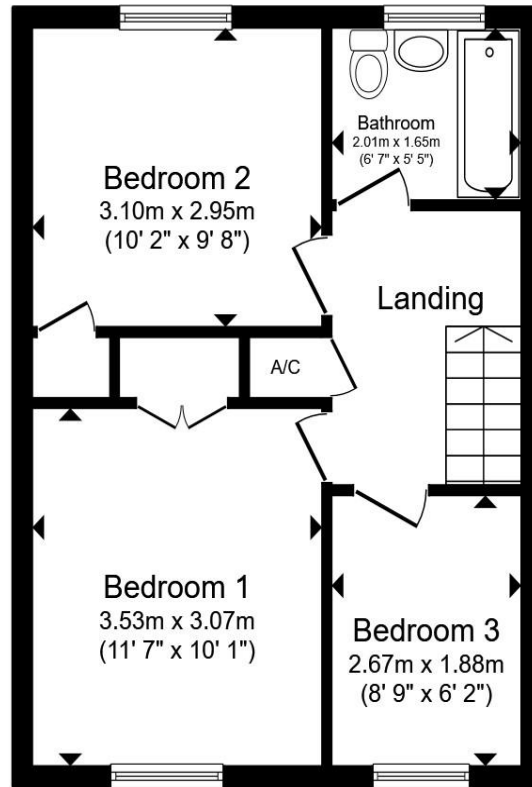

First Floor

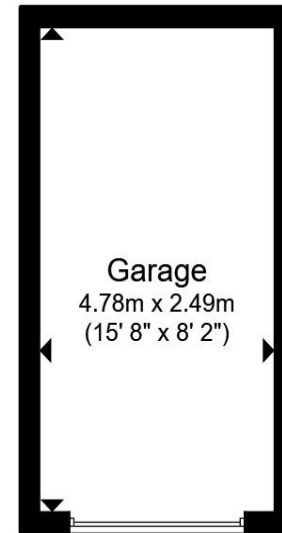

Garage

Entrance

Hallway

Lounge

14' 7" x 13' 4" (4.45m x 4.06m)

Kitchen Breakfast Room

16' 6" x 10' 2" (5.03m x 3.10m)

Landing

Family Bathroom

6' 7" x 5' 5" (2.01m x 1.65m)

Bedroom One

11' 7" x 10' 1" (3.53m x 3.07m)

Bedroom Two

10' 2" x 9' 8" (3.10m x 2.95m)

Bedroom Three

8' 9" x 6' 2" (2.67m x 1.88m)

Garage In Block

15' 8" x 8' 2" (4.78m x 2.49m)

Front And Rear Garden

Total floor area 87.3 m² (940 sq.ft.) approx

This floor plan is for illustrative purposes only. It is not drawn to scale. Any measurements, floor areas (including any total floor area), openings and orientation are approximate. No details are guaranteed, they cannot be relied upon for any purpose and they do not form part of any agreement. No liability is taken for any error, omission or misstatement. A party must rely upon its own inspection(s). Powered by www.propertybox.io



welcome to

Whitebeam Way, North Baddesley, Southampton

- Three bedroom Semi-Detached House
- Garage in a Block
- In need of Renovation
- Excellent room sizes
- Desired North Baddesley Area

Tenure: Freehold EPC Rating: D
Council Tax Band: C

£325,000



Please note the marker reflects the
postcode not the actual property

view this property online fox-and-sons.co.uk/Property/RMY105668



Property Ref:
RMY105668 - 0004

1. MONEY LAUNDERING REGULATIONS Intending purchasers will be asked to produce identification documentation at a later stage and we would ask for your co-operation in order that there is no delay in agreeing the sale. 2. These particulars do not constitute part or all of an offer or contract. 3. The measurements indicated are supplied for guidance only and as such must be considered incorrect. Potential buyers are advised to recheck measurements before committing to any expense. 4. We have not tested any apparatus, equipment, fixtures or services and it is in the buyers interest to check the working condition of any appliances. 5. Where an EPC, or a Home Report (Scotland only) is held for this property, it is available for inspection at the branch by appointment. If you require a printed version of a Home Report, you will need to pay a reasonable production charge reflecting printing and other costs. 6. We are not able to offer an opinion either written or verbal on the content of these reports and this must be obtained from your legal representative. 7. Whilst we take care in preparing these reports, a buyer should ensure that his/her legal representative confirms as soon as possible all matters relating to title including the extent and boundaries of the property and other important matters before exchange of contracts.

fox & sons



01794 513085



Romsey@fox-and-sons.co.uk



2 Market Place, ROMSEY, Hampshire, SO51
8NB



fox-and-sons.co.uk