



jordan fishwick

High Hill Road New Mills High Peak



High Hill Road New Mills High Peak SK22 4HQ

£285,000



The Property

Occupying a substantial corner plot in a popular residential location, a traditional three bedroom semi detached property with no onward chain. Set back from the road with a gated block paved drive, and lovely gardens to three sides. Ready for general and cosmetic updating and briefly comprising; entrance porch, entrance hall, large living room, kitchen, dining room, rear porch, to the first floor there are three bedrooms and bathroom with white suite. The property has an integral double garage as well as a separate detached garage to the rear of the garden with its own access and established gardens with lawns and patio areas.



- Traditional Three Bedroom Semi Detached Property
- Substantial Corner Plot
- In Need of General and Cosmetic Updating
- Large Living Room and Separate Dining Room
- Integral Double Garage as well as Separate Detached Garage
- Large Gated Block Paved Driveway
- Lovely Established Gardens to Three Sides
- Popular Residential Location

Postcode SK22 4HQ

EPC Rating D

Local Authority High Peak

Council Tax C

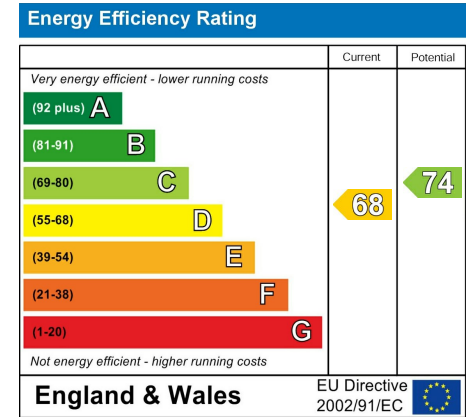

GROUND FLOOR
989 sq.ft. (91.8 sq.m.) approx.

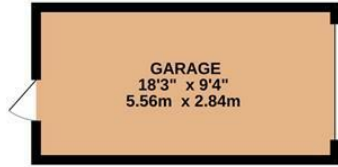

1ST FLOOR
452 sq.ft. (42.0 sq.m.) approx.

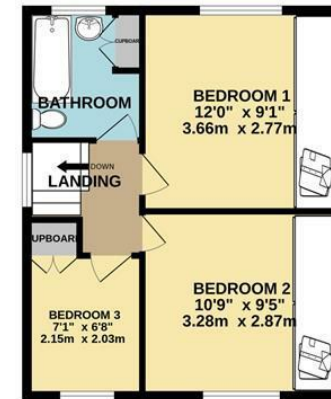

TOTAL FLOOR AREA: 1441 sq.ft. (133.9 sq.m.) approx.

Whilst every attempt has been made to ensure the accuracy of the floorplan contained here, measurements of doors, windows, rooms and any other items are approximate and no responsibility is taken for any error, omission or mis-statement. This plan is for illustrative purposes only and should be used as such by any prospective purchaser. The services, systems and appliances shown have not been tested and no guarantee as to their operability or efficiency can be given.
Made with Metropix ©2026



These particulars are believed to be accurate but they are not guaranteed and do not form a contract. Neither Jordan Fishwick nor the vendor or lessor accept any responsibility in respect of these particulars, which are not intended to be statements or representations of fact and any intending purchaser or lessee must satisfy himself by inspection or otherwise as to the correctness of each of the statements contained in these particulars. Any floorplans on this brochure are for illustrative purposes only and are not necessarily to scale.

Offices at: Chorlton, Didsbury, Disley, Hale, Glossop, Macclesfield, Manchester Deansgate, Manchester Whitworth Street, New Mills, Sale, Wilmslow and Withington

14 Market St, Disley, Cheshire, Stockport SK12 2AA

01663 767878

disley@jordanfishwick.co.uk

www.jordanfishwick.co.uk