



1 Cavern Mews Cavern Road, Brixham, Devon, TQ5 9DQ
Freehold House - Terraced
£160,000

boycebrixham
email property@ljboyce.co.uk call 01803 852736

Tucked away behind gates just off Bolton Street in central Brixham, this stylish two-bedroom mews house offers an opportunity to acquire a modern, low-maintenance investment property in a peaceful yet highly convenient location. Built in 2014 to contemporary standards, the home is set within a charming courtyard development, providing privacy and a quiet retreat just moments from the town's vibrant harbour, shops, and amenities.

The property has been constructed to meet efficient modern building regulations and is heated via an eco-friendly air source heat pump system, offering cost-effective and sustainable living for tenants. Its clean, contemporary design, practical layout, and energy efficiency make it an attractive option for long-term rental, with strong ongoing appeal in Brixham's active rental market.

Internally, the mews house provides well-proportioned accommodation with a bright open-plan living area, modern kitchen, two bedrooms, and a contemporary bathroom. The property is well maintained and ready for continued letting without the need for immediate works—ideal for investors looking for a hands-off, hassle-free addition to their portfolio, or for owner occupation.

Currently let and generating a solid yield, the property offers instant income with the benefit of a reliable tenant in situ. Its central yet tucked-away position, along with low running and maintenance costs, makes this a particularly appealing opportunity for landlords seeking long-term value and stability.

Additionally, other similar properties within the mews development are also available, offering the chance to acquire multiple units in one attractive, purpose-built setting. Viewings are by appointment and early interest is encouraged.

Council Tax Band: B



- Modern freehold mews house (built 2014)
- Tenanted and generating solid yield
- Convenient Town Centre Location
- Energy-efficient air source heating
- Great Investment / No Chain
- Similar Units Available



boycebrixham
email property@ljboyce.co.uk call 01803 852736



boycebrixham

email property@ljoyce.co.uk call 01803 852736

GROUND FLOOR
367 sq.ft. (34.1 sq.m.) approx.

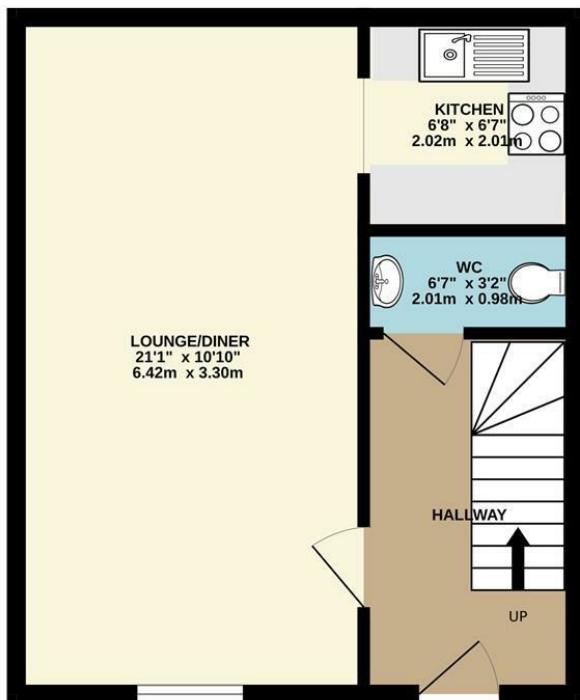

1ST FLOOR
367 sq.ft. (34.1 sq.m.) approx.

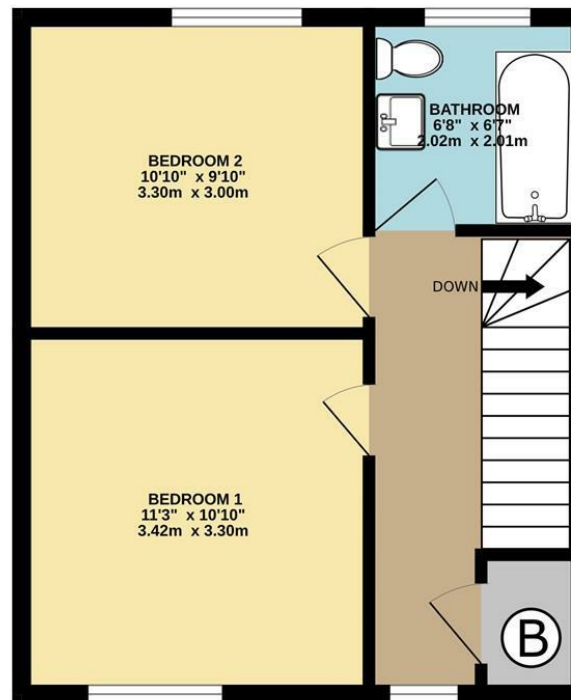

TOTAL FLOOR AREA : 734 sq.ft. (68.1 sq.m.) approx.

Whilst every attempt has been made to ensure the accuracy of the floorplan contained here, measurements of doors, windows, rooms and any other items are approximate and no responsibility is taken for any error, omission or mis-statement. This plan is for illustrative purposes only and should be used as such by any prospective purchaser. The services, systems and appliances shown have not been tested and no guarantee as to their operability or efficiency can be given.
Made with Metropix ©2026

Current EPC Rating: B

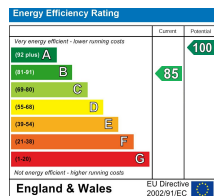

Find us on



Please note floorplans are to be used as a guide only. The Agent has not tested any apparatus, equipment, fixtures and fittings or services and so cannot verify that they are in working order or fit for purpose. A buyer is advised to obtain verification from their solicitor or surveyor. References to the tenure of the property are based on information supplied by the seller. The agent has not had sight of the title documents. A buyer is advised to obtain verification from their solicitor. You are advised to check the availability of this property before travelling distance to view.

boycebrixham

email property@ljboyce.co.uk call 01803 852736