

Court Yard, London, SE9 5PR

**Asking Price £315,000**

An unique opportunity to acquire either a ground floor garden flat or an entire block for a portfolio. Initially the ground floor accommodation comprises of a sizeable lounge with a door to you own garden, master bedroom, second bedroom, bathroom and fitted kitchen. Offered with a share of the freehold and situated very centrally for Eltham High Street. Greenwich council tax band G. EPC rating D.





Floor Plan



Court Road, SE9

Approximate Gross Internal Area = 642 sq ft /59.6 sq m

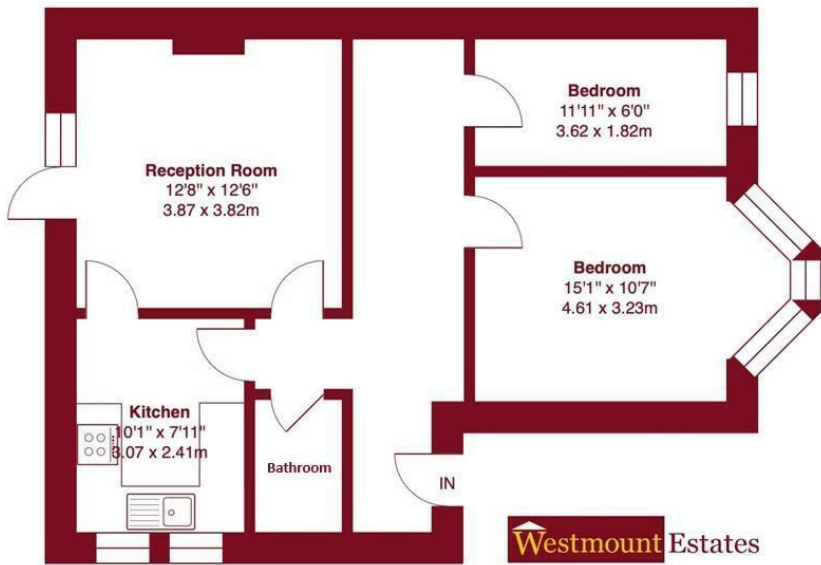

Ground Floor

This plan is for layout guidance only and not drawn to scale unless stated. Window and door openings are approximate. Whilst every care is taken in the preparation of this plan, we would advise interested parties to check all dimensions, shapes and compass bearings prior to making any decisions reliant upon them. No liability is accepted for any errors. By Prime Square Photography / Copyright 2025

Area Map

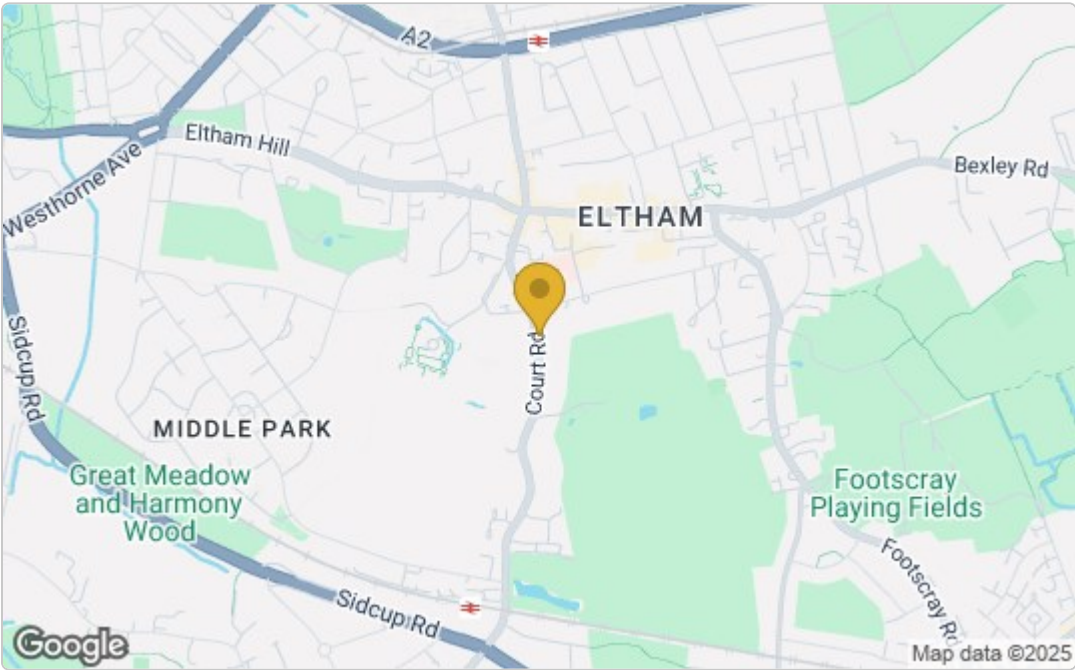

Energy Efficiency Graph

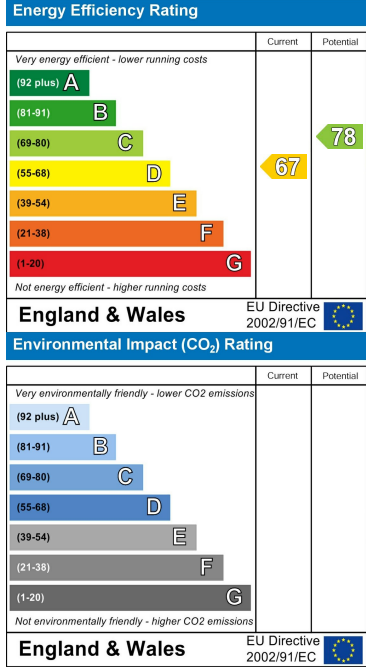

These particulars, whilst believed to be accurate are set out as a general outline only for guidance and do not constitute any part of an offer or contract. Intending purchasers should not rely on them as statements of representation of fact, but must satisfy themselves by inspection or otherwise as to their accuracy. No person in this firms employment has the authority to make or give any representation or warranty in respect of the property.