

GROUND FLOOR FLAT



Flat - Purpose Built (EPC Rating: D) D

VIEWFIELD CLOSE, HARROW. HA3 0PP

£1,375 Per Calendar



HAYMILLS
Expertise Experience Engagement



1 BED GROUND FLOOR FLAT CLOSE TO PRESTON ROAD STATION

Presenting a 1 bed flat with own front door and with a good size bedroom, lounge open plan with kitchen and modern shower room.

The property is all electric and comes with it's own marked and allocated parking space. The flat is situated within minutes to Preston Road Station and its multiple shopping and bus services as well as Schools.



Approx Gross Internal Area
33 sq m / 351 sq ft

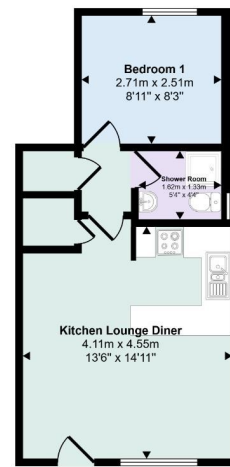

Floorplan

This floorplan is only for illustrative purposes and is not to scale. Measurements of rooms, doors, windows, and any items are approximate and no responsibility is taken for any error, omission or mis-statement. Icons of items such as bathroom suites are representations only and may not look like the real items. Made with Made Snappy 360.

Council Tax Band C

Energy Performance Graph

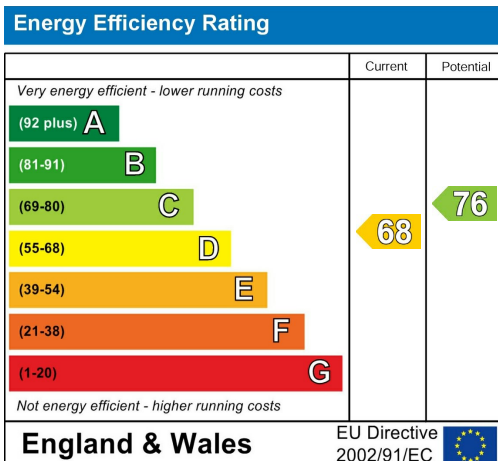

Call us on
0208 904 8822
info@haymills.uk

Agents Note: Whilst every care has been taken to prepare these particulars, they are for guidance purposes only. All measurements are approximate and are for general guidance purposes only and whilst every care has been taken to ensure their accuracy, they should not be relied upon and potential buyers are advised to recheck the measurements.