



8 Grosvenor Manor, Old Bexley Lane, Bexley DA5 2BJ
Guide Price £280,000 - £300,000



**** Guide Price Range £280,000 - £300,000 **** Park Estates are delighted to offer this spacious 2 bedroom modern apartment, situated in a small gated development within easy access to all amenities. Situated on the first floor and comprising of a living room and dining area, fitted kitchen, 2 double bedrooms - one with a large walk-in wardrobe and a modern bathroom. In addition the property features gas central heating, well managed communal areas, allocated parking and a 97 year unexpired lease.

Energy Efficiency Rating		
	Current	Potential
Very energy efficient - lower running costs		
(92 plus) A		
(81-91) B		
(69-80) C	75	78
(55-68) D		
(39-54) E		
(21-38) F		
(1-20) G		
Not energy efficient - higher running costs		
England & Wales	EU Directive 2002/91/EC	

Local Authority: Dartford Borough Council
Council Tax Band: D



01322 553322

60-62 High Street, Bexley, Kent DA5 1AH

bexley@parkestates.co.uk
www.parkestates.co.uk

Grosvenor Manor

Approximate Gross Internal Area = 70.2 sq m / 756 sq ft

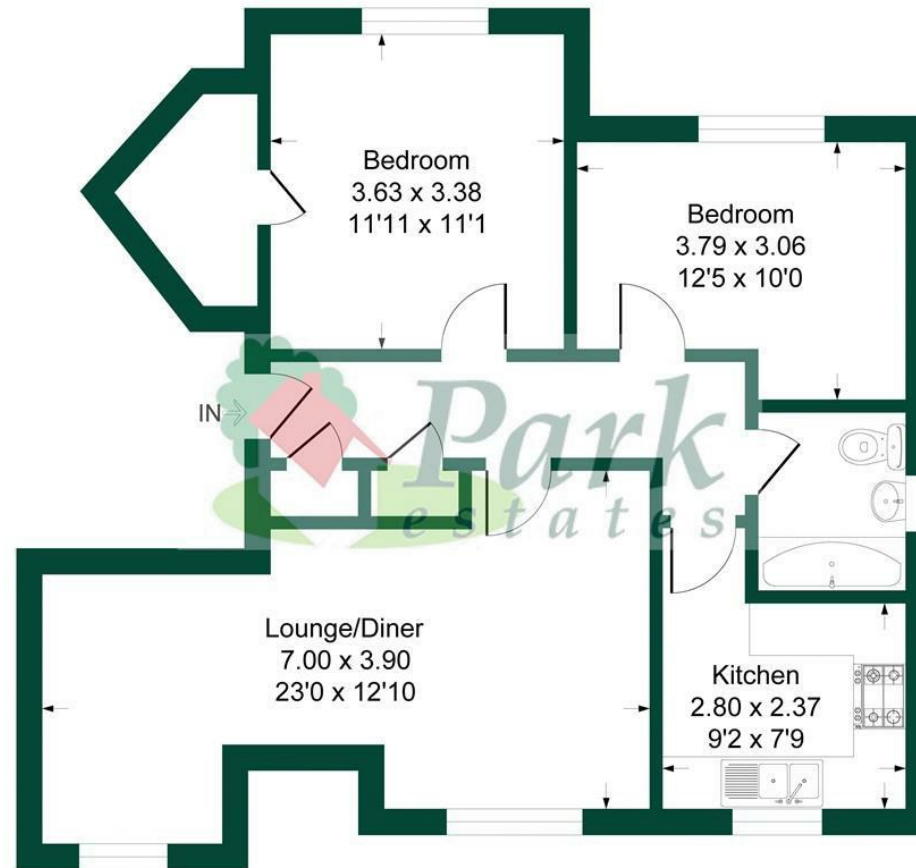

This plan is for layout guidance only. Not drawn to scale unless stated. Windows and door openings are approximate. Whilst every care is taken in the preparation of this plan, please check all dimensions, shapes and compass bearings before making any decisions reliant upon them.
Produced By Planpix

Every care has been taken with the preparation of details, but accuracy is in no way guaranteed. These particulars do not constitute a contract and are issued and accepted on the express understanding that all negotiations will be conducted through Park Estates. The seller does not make or give, nor do we or our employees have any authority to give a representation or warranty in relation to the property. Please contact this office before viewing the property. If there is any point which is of particular importance to you, we will be pleased to check the information for you and confirm that the property remains available. This is particularly important if you are contemplating travelling some distance to view the property. We would strongly recommend that all the information that we provide about the property is verified by yourself on inspection and also by your conveyancer, especially where statements have been made by us to the effect that the information provided by us has not been verified.