



Church Street, East Hendred, Wantage, OX12 8LA
Guide Price £800,000

THOMAS
MERRIFIELD
SALES LETTINGS





The Property

Poplars is a charming Grade II listed home, ideally situated in the heart of the idyllic village of East Hendred. Offering a wealth of character alongside stunning private gardens, this is a rare opportunity to acquire a truly historic property on the sought-after Church Street.

This delightful home is rich in period features that must be seen to be fully appreciated. The accommodation comprises an entrance hall with storage, leading through to an open kitchen/breakfast room with a very useful pantry and a formal dining area featuring a large fireplace with exposed brickwork, a wood burner, and a bay window.

To the rear of the property, an additional hallway utilised as a study provides access to a cloakroom. A particularly impressive sitting room boasts a fireplace, vaulted ceiling, and mezzanine level, creating a wonderful sense of space and character. This area leads through to inner hallway with a utility room and stairs ascending to the mezzanine, which has previously been used as a bedroom.

Upstairs, the property offers an impressive principal bedroom with built-in storage, two further bedrooms, and a family bathroom.

The picturesque rear garden is simply outstanding, featuring a patio area, lawn, and well-stocked mature shrubs and borders. A timber-framed outdoor entertaining area is perfectly positioned to enjoy the surroundings, while a charming hedge arch leads through to a further "secret" garden, offering an excellent degree of privacy and planning permission in place to erect a further outbuilding / home office. Additional features include a storage shed, and further seating areas. Side access leads to a parking area providing space for multiple vehicles.





Key Features

- Council Tax Band: E, EPC Rating: E
- Picturesque village location
- Charming Grade II listed cottage offering a wealth of character
- Vaulted rear sitting room with mezzanine floor
- Ample off street parking
- Three/four bedrooms
- Dining room with large fireplace and wood burner
- Stunning, well-maintained gardens
- Oil fired central heating
- Planning permission for further room with ensuite shower room granted



The Location

East Hendred is situated between Wantage and Harwell having two country pubs, village shop, community centre, The Hendreds Pre-School and Church of England Primary School and St Amand's Catholic Primary School. The A34 is easily accessible with the M40 to the north and the M4 to the south Didcot c.5 miles offers a fast service to London Paddington c.40 minutes. The nearby town of Wantage offers schooling for all ages a range of shopping and leisure facilities as well as a market on a Wednesday and Saturday.

Some material information to note: Freehold property. Oil central heating, Mains water, mains electrics and mains drains. Ofcom checker indicates standard and superfast broadband is available at this postcode. Ofcom checker indicates mobile availability is available with most major providers. The government portal generally highlights this as a very low flood risk within this postcode. We are not aware of any planning permissions in place which would negatively affect the property.



Thomas Merrifield and their clients give notice that:

1. They are not authorised to make or give any representations or warranties in relation to the property either here or elsewhere, either on their own behalf or on behalf of their client or otherwise. They assume no responsibility for any statement that may be made in these particulars. These particulars do not form any part of any offer or contract and must not be relied upon as statements or representations of fact.

2. Any areas, measurements or distances are approximate. The text, photographs and plans are for guidance only and are not necessarily comprehensive. It should not be assumed that the property has all necessary planning, building regulation or other consents and Thomas Merrifield have not tested any services, equipment or facilities. Purchasers must satisfy themselves by inspection or otherwise.

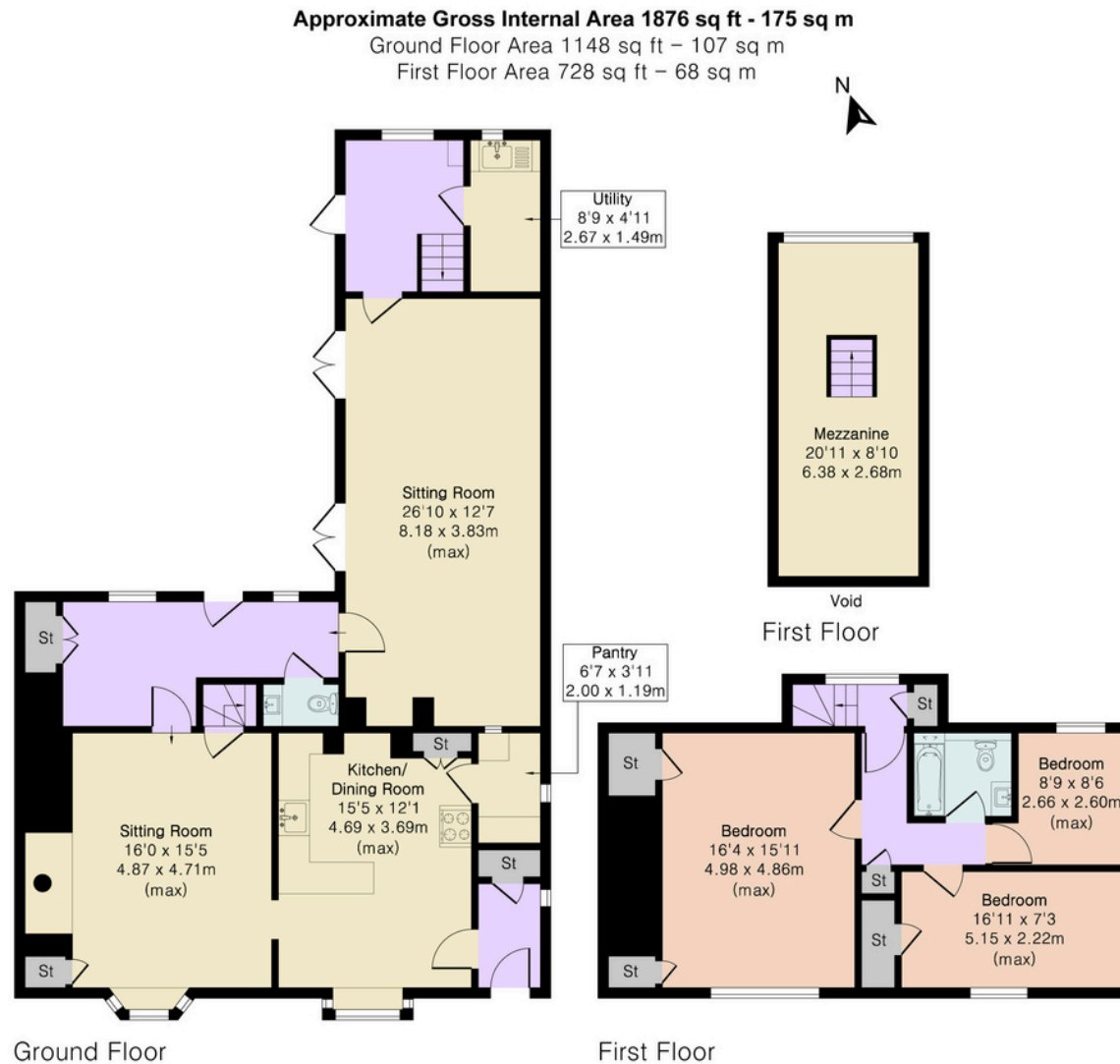

Wantage Office

15 Millbrook Square, Grove, Wantage
Oxfordshire, OX12 7JZ

T 01235 764 444

E wantage@thomasmerrifield.co.uk

W thomasmerrifield.co.uk

THOMAS
MERRIFIELD
SALES LETTINGS