

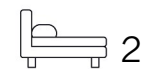

Living
made
better

1 Tower Mill Road
Peckham, SE15 6GJ



£1,900 PCM

1 Tower Mill Road, Peckham, SE15 6GJ

Madison Brook

Property Summary

This first-floor two-bedroom, two-bathroom apartment offers modern open-plan living within easy reach of the station and town centre. The property includes a bright reception and dining area with a fitted kitchen, two well-proportioned bedrooms, a contemporary shower room, and a modern family bathroom. Additional benefits include good storage, allocated parking, and furnished accommodation.

Floorplan

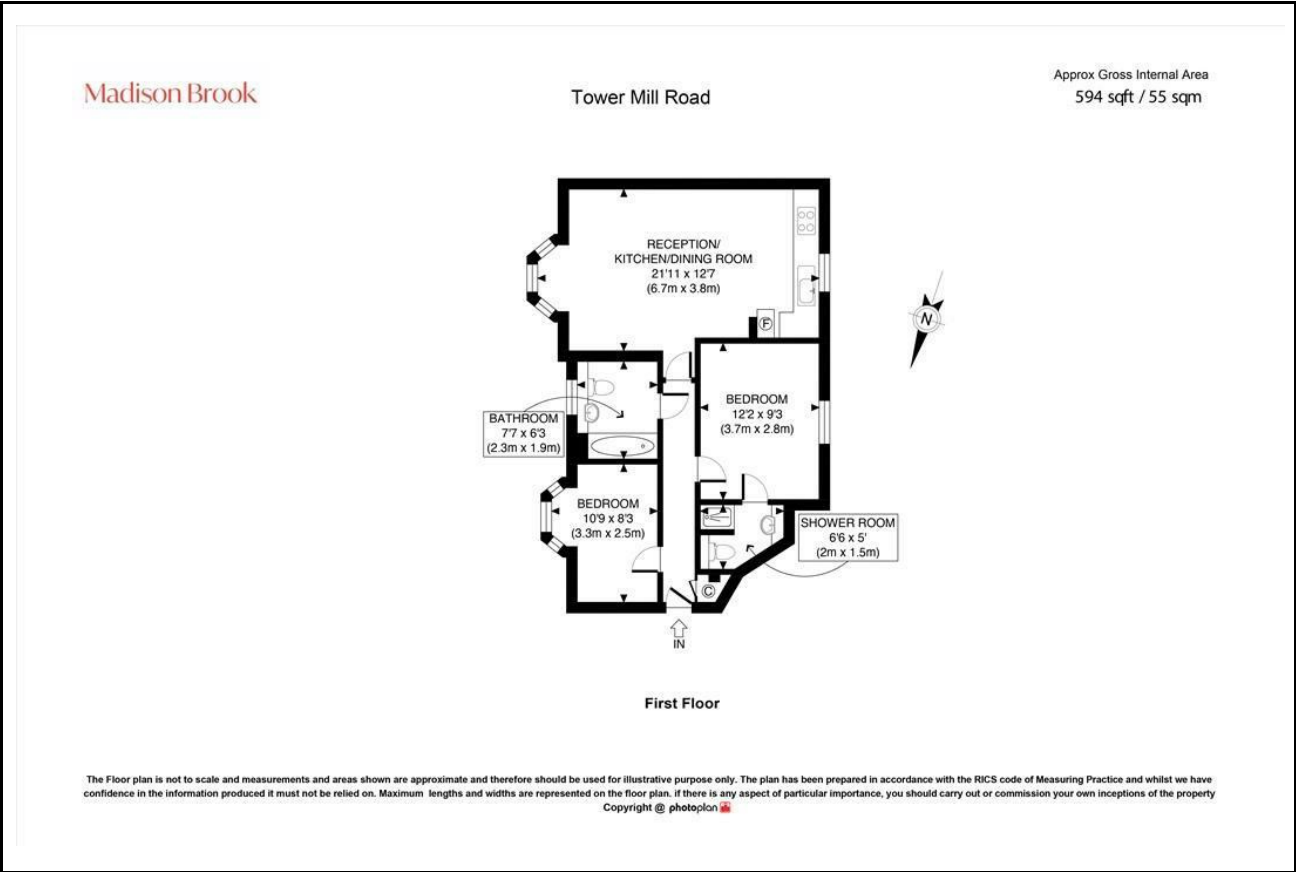

Area Map



Energy Efficiency Graph

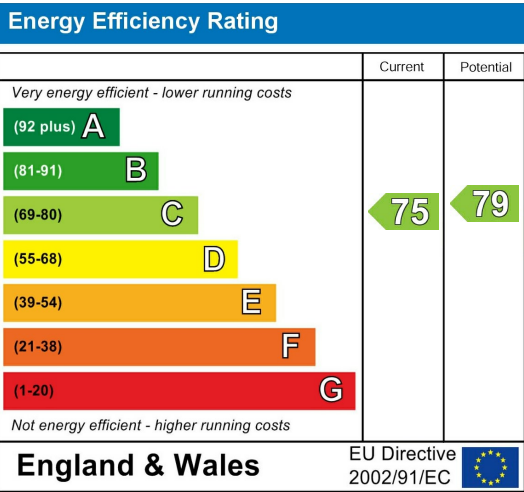

These particulars, whilst believed to be accurate are set out as a general outline only for guidance and do not constitute any part of an offer or contract. Intending purchasers should not rely on them as statements of representation of fact, but must satisfy themselves by inspection or otherwise as to their accuracy. No person in this firm's employment has the authority to make or give any representation or warranty in respect of the property.

43 Loampit Vale, Lewisham, London, SE13 7FT
Tel: 020 3946 6200 Email:
lewisham@madisonbrook.com
<https://madisonbrook.com/>