



**38 Station Road
Alcester
B49 5ET**

Offers In Excess Of £350,000

Located on Station Road in Alcester, this spacious three-storey family home offers well-balanced accommodation extending to approximately 119.6 sq. metres (1,287.8 sq. feet).

The ground floor comprises a welcoming reception hall, living room, kitchen/dining room and WC.

The first floor provides two bedrooms and a family bathroom.

The second floor features a generous principal bedroom complete with a dressing area, walk-in wardrobe, and en-suite shower room.

Externally, the property benefits from a landscaped rear garden, single garage, and allocated parking for one car, making it ideal for modern family living in a convenient town location.



Reception Hall

10'6" x 6'8" (3.21m x 2.04m)

Attractive herringbone-style vinyl flooring, with doors leading to all ground floor rooms and a staircase rising to the first floor.

Kitchen/Dining Room

12'0" x 7'8" (3.68m x 2.35m)

Fitted with a range of wall and base units with marble-effect laminate worktops over and a stainless steel sink with mixer tap. Integrated electric oven with four-ring hob. Wall-mounted gas boiler housed within a cupboard. Space and plumbing for a washing machine, fridge, and dishwasher. Window to the front elevation and herringbone-style vinyl flooring.

WC

6'2" x 2'9" (1.90m x 0.86m)

Fitted with a low-level WC and hand basin, with herringbone-style vinyl flooring.

Living Room

13'11" x 14'10" (4.25m x 4.54m)

A generously sized room featuring herringbone-style vinyl flooring, an understairs storage cupboard, a window, and double doors leading to the rear garden.

First Floor

Landing

9'6" x 6'9" (2.92m x 2.07m)

Bedroom Two

12'2" (into wardrobe) x 14'9" (3.71m (into wardrobe) x 4.51m)

Bedroom Three

13'10" (max) x 7'8" (4.22m (max) x 2.35m)

Bathroom

6'2" x 6'9" (1.88m x 2.06m)

Fitted with a three-piece suite comprising a low-level WC, wash hand basin, and panelled bath with electric shower over and ceramic tiling to the surround. Frosted window to the front elevation.

Second Floor

Bedroom One

14'9" x 14'9" (4.50m x 4.51m)

A generously sized master bedroom featuring a dressing area, walk-in wardrobe, and en-suite shower room.

Dressing Area

3'11" x 5'7" (1.20m x 1.72m)

Walk-In Wardrobe

5'8" x 5'10" (1.75m x 1.80m)

En-suite Shower Room

8'7" x 8'5" (2.64m x 2.58m)

Fully tiled walls and floor, comprising a low-level WC, wash hand basin, and corner shower.

Outside

Featuring a slabbed seating area, astro turf, gravel borders, and a raised artificial lawn with additional seating. Gate providing access to the

Garage

8'7" x 17'3" (2.64m x 5.28m)

Additional Information

Services:

Mains drainage, electricity, gas and water are connected to the property.

Tenure:

The property is Freehold. Vacant possession will be given upon completion of the sale.

Broadband:

Superfast broadband speed is available in the area, with predicted highest available download speed 2300 Mbps and highest available upload speed 2300 Mbps. For more information visit: <https://checker.ofcom.org.uk/>. Mobile signal coverage (both voice and data) is available from the four major providers (O2, EE, Three, and Vodafone), with EE being rated as 'Good outdoor, variable in-home' coverage, O2 being rated as 'Good outdoor, variable in-home' coverage, Three being rated as 'Good outdoor, variable in-home' coverage and Vodafone being rated as 'Good outdoor' coverage.

For more information, please visit: <https://checker.ofcom.org.uk/>.

Council Tax:

Stratford-on-Avon District Council - Band D

Flood Risk:

This location is in a very low risk flood zone. For more information, please visit: <https://check-long-term-flood-risk.service.gov.uk/risk#>

Fixtures & Fittings:

All those items mentioned in these particulars will be included in the sale, others, if any, are specifically excluded.

Viewing:

Strictly by prior appointment with Earles (01789 330 915/01564 794 343).

Earles is a Trading Style of 'John Earle & Son LLP' Registered in England. Company No: OC326726 for professional work and 'Earles Residential Ltd' Company No: 13260015 Agency & Lettings. Registered Office: Carleton House, 266 - 268 Stratford Road, Shirley, West Midlands, B90 3AD.





Ground Floor

Approx. 50.1 sq. metres (539.2 sq. feet)

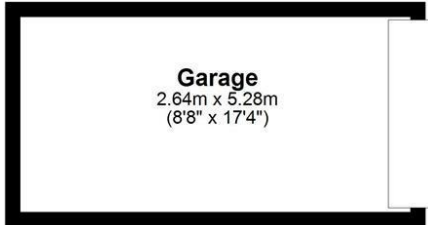

First Floor

Approx. 36.3 sq. metres (390.6 sq. feet)

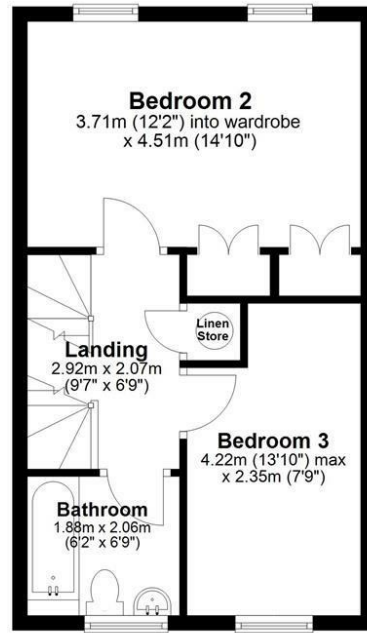
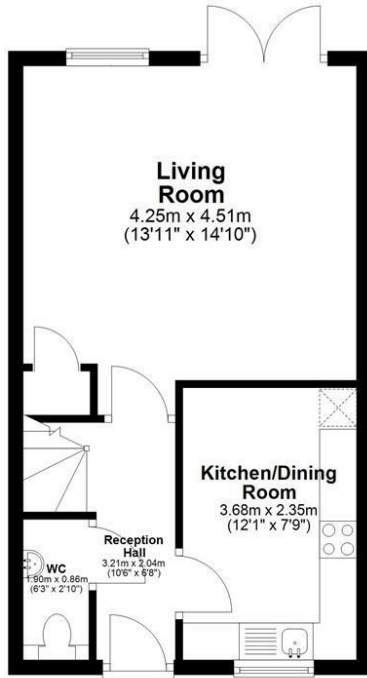

Second Floor

Approx. 33.3 sq. metres (357.9 sq. feet)

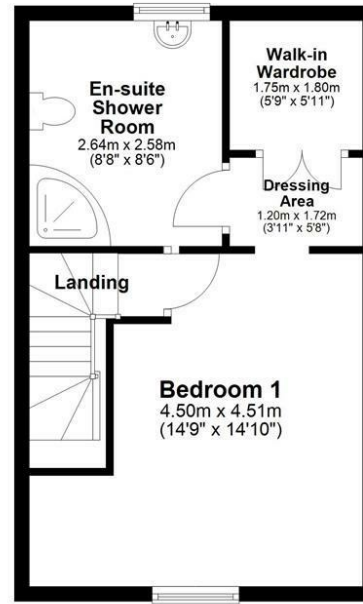

Total area: approx. 119.6 sq. metres (1287.8 sq. feet)

Energy Efficiency Rating	Current	Potential
Very energy efficient - lower running costs		
(92 plus) A		
(81-91) B		
(69-80) C		
(55-68) D		
(39-54) E		
(21-38) F		
(1-20) G		
Not energy efficient - higher running costs		
	78	82
England & Wales	EU Directive 2002/91/EC	

Environmental Impact (CO ₂) Rating	Current	Potential
Very environmentally friendly - lower CO ₂ emissions		
(82 plus) A		
(81-91) B		
(69-90) C		
(55-68) D		
(39-54) E		
(21-38) F		
(1-20) G		
Not environmentally friendly - higher CO ₂ emissions		
England & Wales	EU Directive 2002/91/EC	

