



MACHAN ROAD, LARKHALL

OFFERS OVER £220,000

move  on

MACHAN ROAD,
LARKHALL

Terraced Bungalow

3 Bedrooms

1 Bathroom

2 Receptions



move on
www.moveonhomes.co.uk

01698 757 125



move  on

www.moveonhomes.co.uk









Located in Larkhall, this three-bedroom, one-bathroom mid-terraced bungalow offers a comfortable and practical living space. The property features a spacious full-length lounge and dining area, enhanced by patio doors that open onto the rear garden, providing a seamless indoor-outdoor living experience. The modern kitchen is equipped with white wall and floor units, complemented by grey worktops and flooring. Integrated appliances and a breakfast bar add to the kitchen's functionality and style. The property has been freshly painted throughout and has new floor coverings in the bedroom and hallway.

The bungalow includes three well-proportioned bedrooms, each offering ample storage solutions. The wet floor shower room is fitted with wall panels, providing a clean and contemporary finish. A standout feature of this property is the impressive converted double detached garage, complete with a WC. This versatile space can be utilized in many ways, such as a home studio, office, kids playroom, or gym, catering to a variety of needs.

Externally, the property boasts an enclosed rear garden, offering a private outdoor space for relaxation or entertaining. The garden is designed for low maintenance, featuring a paved patio area and gravelled sections. Additionally, the property provides private off-street parking for multiple vehicles, ensuring convenience for residents and visitors alike.

Situated close to Larkhall town centre, the bungalow benefits from easy access to a range of local amenities, including shops, supermarkets, bars, and restaurants. The area is well-served by public transport, with train stations offering connections to Glasgow, making it an ideal location for commuters. The M74 motorway is also within a few minutes' drive, further enhancing the property's accessibility.

The property falls under Council Tax Band D and has an EPC rating of D, reflecting its energy efficiency. With its practical layout, modern features, and convenient location, this bungalow presents an excellent opportunity for those seeking a well-appointed home in Larkhall.

move  on



Floorplans are indicative only - not to scale

move 

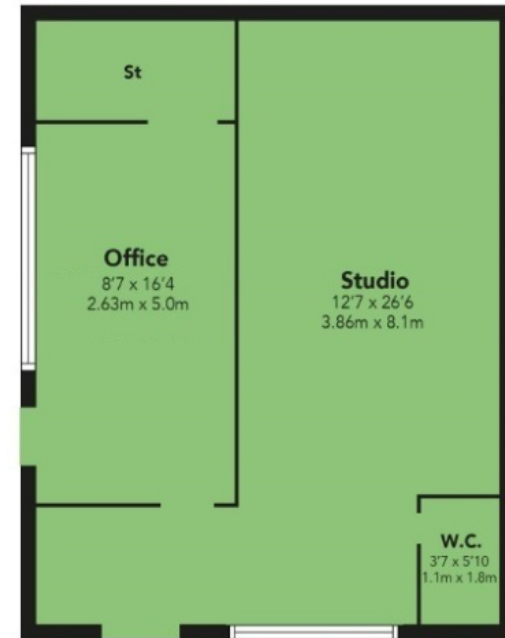

DETACHED GARAGE CONVERTED TO STUDIO AND OFFICE

Energy Efficiency Rating

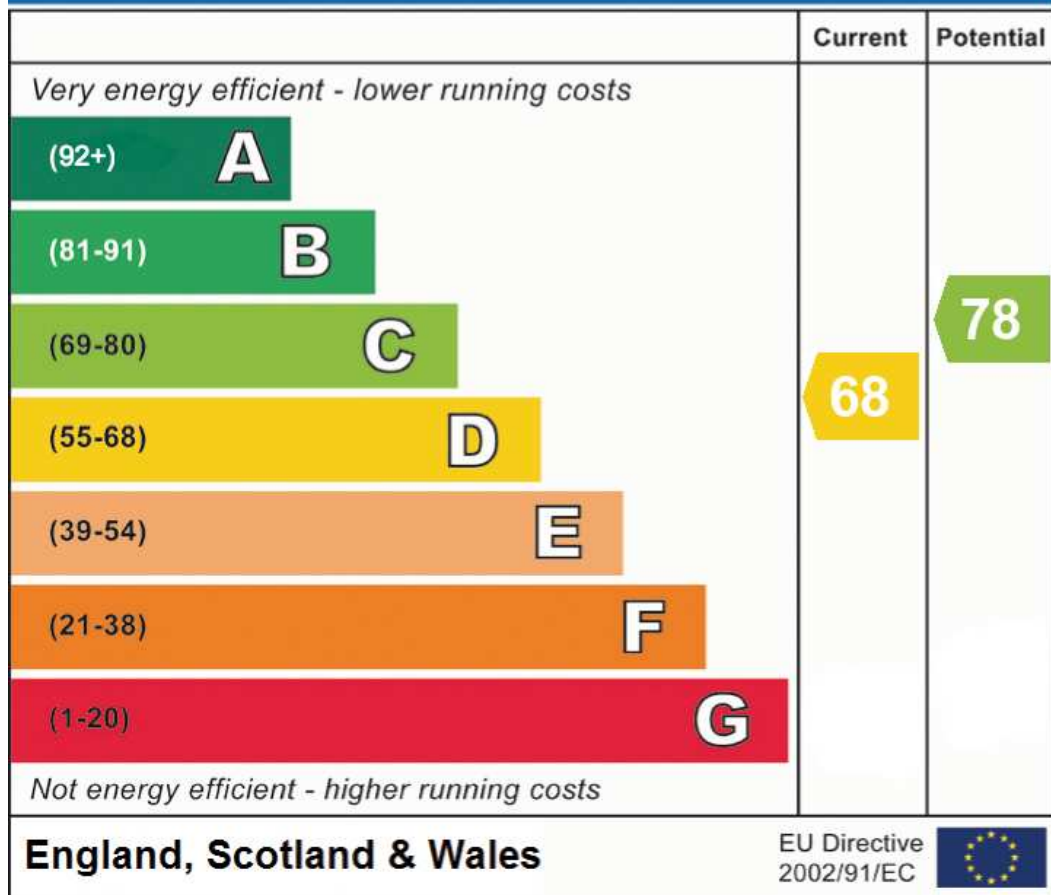

Environmental Impact (CO₂) Rating

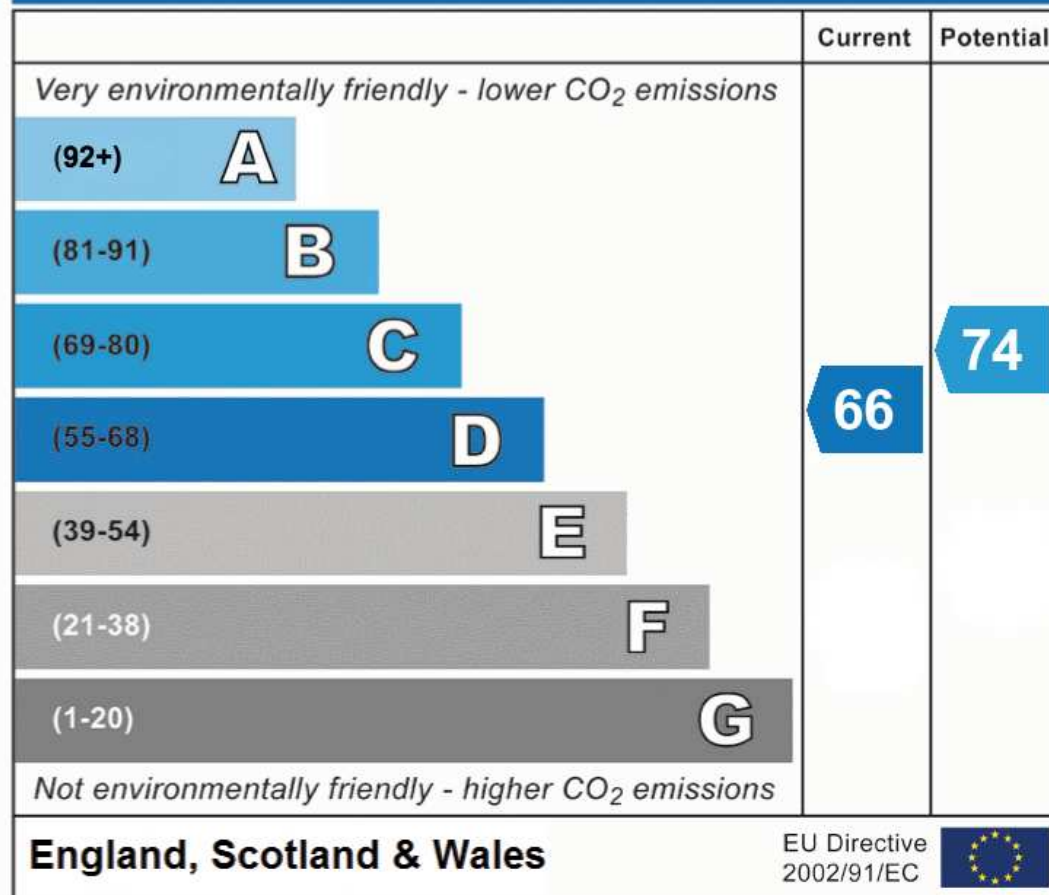

Address: Larkhall, ML9

move n

166 Merry Street, Motherwell, ML1 1NA

EMAIL : info@moveonhomes.co.uk

WEB : www.moveonhomes.co.uk

01698 757 125

 **facebook.com/moveonhomes**