

KE



Middle Cottage, 3 Hollow Street, Chislet, Canterbury, CT3 4DS

£325,000

- Three Double Bedrooms
- Well maintained throughout
- Village location with uninterrupted countryside views
- Brand New Fitted Kitchen
- Beautiful garden with sunny patio area

3 Hollow Street, Canterbury CT3 4DS

Nestled in the sought-after village of Chislet, this delightful terraced cottage combines timeless character with modern comforts. The spacious lounge/diner features a striking brick fireplace with a cosy log burner while the newly fitted kitchen comes complete with a range of quality appliances. To the rear, a bright conservatory offers additional living space and overlooks the garden. Upstairs, the first floor offers two generous double bedrooms: the main boasts uninterrupted countryside views, and the second showcases beautiful vaulted ceilings. A family bathroom is also located on this floor, with stairs leading up to a third bedroom on the second floor. The low-maintenance garden is designed for enjoyment year-round, with artificial grass, two inviting patio areas, and plenty of space for outdoor entertaining.



Council Tax Band: B



Lounge/Diner

15'11' x 14'4'

Front door and window to front

Kitchen

11'2'x 9'7'

Window to rear, selection of matching wall and base units, ceramic sink fitted oven and hob, space for washing machine

Conservatory

8' x 4'

Landing

Bedroom 2

12'5' x 9'9'

Window to front

Bedroom 3

10' x 9'8'

Window to rear

Bathroom

Window to rear, panelled bath with shower over, low level wc, pedestal wash hand basin, heated towel rail, tiled walls,

2nd Floor

Bedroom 1

14'3' x 11'5'

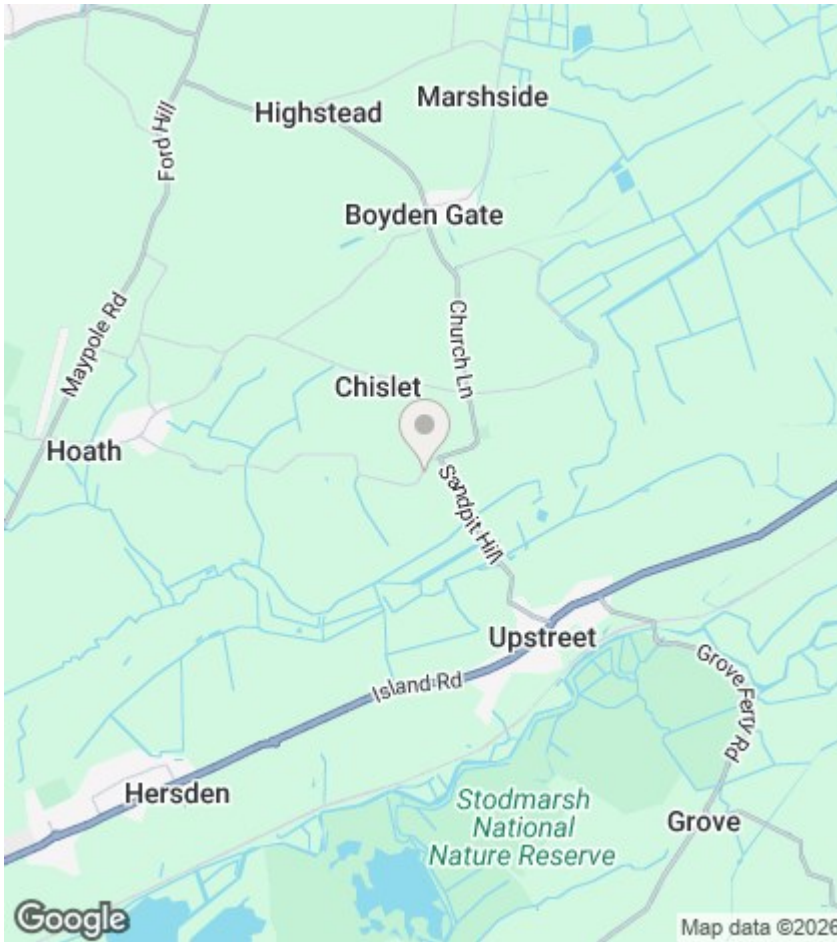

Viewings

Viewings by arrangement only. Call 01227 389 998 to make an appointment.

EPC Rating:

E

Energy Efficiency Rating		Current	Potential
Very energy efficient - lower running costs			
(92 plus) A			84
(81-91) B			
(69-80) C			
(55-68) D			
(39-54) E		44	
(21-38) F			
(1-20) G			
Not energy efficient - higher running costs			
England & Wales		EU Directive 2002/91/EC	



Ground Floor

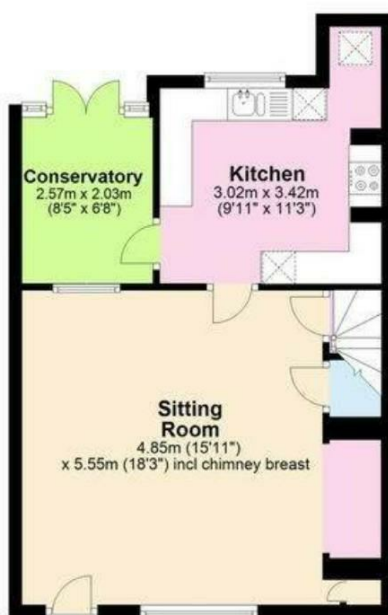

First Floor



Second Floor

