



30 Dolver Close

Corby, Northamptonshire NN18 8NB



Simpson West

Occupying a desirable position within the sought after Poppyfields development is this well presented TWO bedroom residence that is being offered to the market for sale with NO ONWARD CHAIN. This home is situated within a quiet cul-de-sac that happens to be within walking distance from the local schools, shops and other amenities. Features include an entrance hall, living room and a fitted kitchen breakfast room with door leading to the rear garden. To the first floor there are TWO DOUBLE bedrooms that both benefit from fitted wardrobes, in addition to this there is the main family bathroom. Outside is an established garden that is fully enclosed and is mainly laid to lawn. To the side there is a large driveway providing off road parking for multiple vehicles. Early viewings are highly encouraged. Energy rating C. (agents note - opportunity to purchase with sitting tenant, speak with agent for more detail)

£177,500



Ground Floor

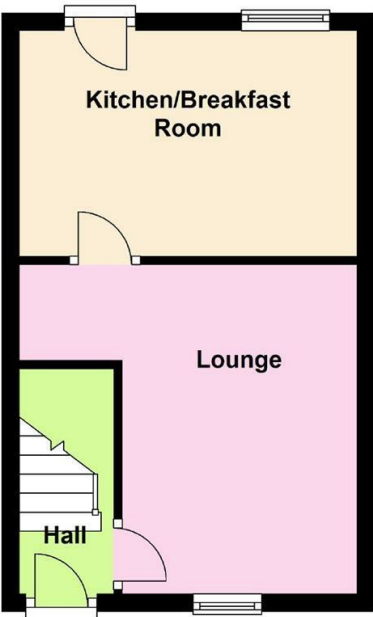

First Floor

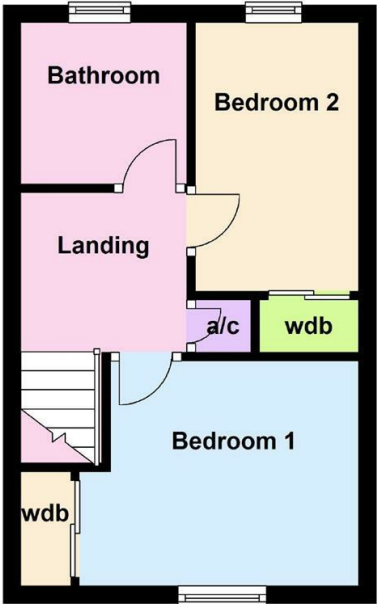

Floor plan not to scale - for guidance purposes only.
Plan produced using PlanUp.

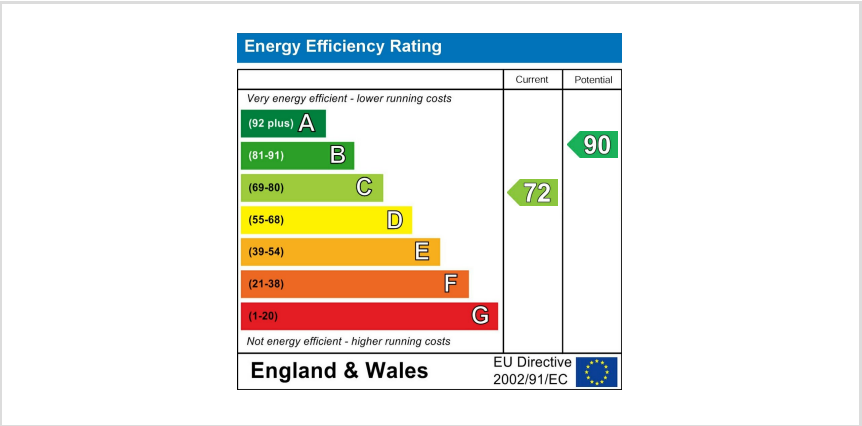

When you buy with Simpson West, you know **you'll be in safe hands**. From the moment you walk through our doors, we'll make you **feel truly welcome**. Our sales consultants and financial advisors will take you through **every step of the process**, offering **free expert advice** along the way, from help choosing the right mortgage and insurance through to finding your conveyancer. And if you need help selling your home too, **with over 20 years of local experience, you can trust us to get you moving**.



**Simpson
West**

Making Every
Journey Personal



01536 202007

info@simpsonwest.co.uk

<https://www.simpsonwest.co.uk/>

64 Corporation Street, Corby, Northants, NN17 1NH