



STEPHENSON BROWNE

Cromer Street, May Bank

ST5 0JN



£775 PCM

Description

Located in the charming area of May Bank, Cromer Street presents a delightful opportunity to acquire a fully refurbished terraced home located in a quiet street. This two-bedroom property boasts a modern and stylish interior, making it an ideal choice for those seeking a blend of classic character and contemporary living.

Upon entering, you will find two inviting reception rooms that offer ample space for relaxation and entertaining. The layout is thoughtfully designed to maximise comfort and functionality, perfect for both families and professionals alike. The well-appointed kitchen and bathroom further enhance the home's appeal, ensuring that all your daily needs are met with ease.

The property features a private rear yard, providing a tranquil outdoor space for enjoying the fresh air or hosting gatherings with friends and family. On-street parking is also available, adding to the convenience of this lovely home.

With its prime location in May Bank, you will benefit from easy access to local amenities, schools, and transport links, making it a practical choice for everyday living.

Pets considered via written application only.



Viewing

Please contact our office using the details provided on the final page if you are interested in booking a viewing or require further information.

Floorplans

33 Cromer Street, Newcastle, ST5 0JN

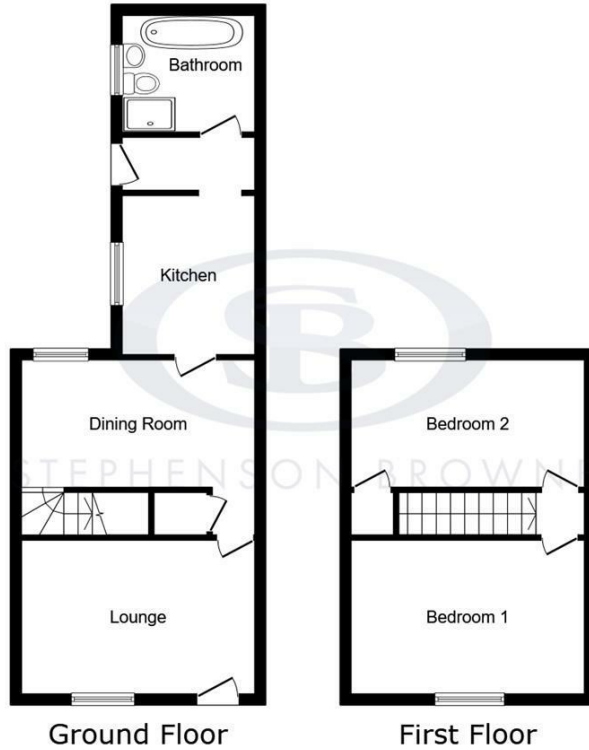

This floor plan is for illustrative purposes only. It is not drawn to scale. Any measurements, floor areas (including any total floor area), openings and orientations are approximate. No details are guaranteed, they cannot be relied upon for any purpose and do not form any part of any agreement. No liability is taken for any error, omission or misstatement. A party must rely upon its own inspection(s). Powered by www.Propertybox.io



Area Map

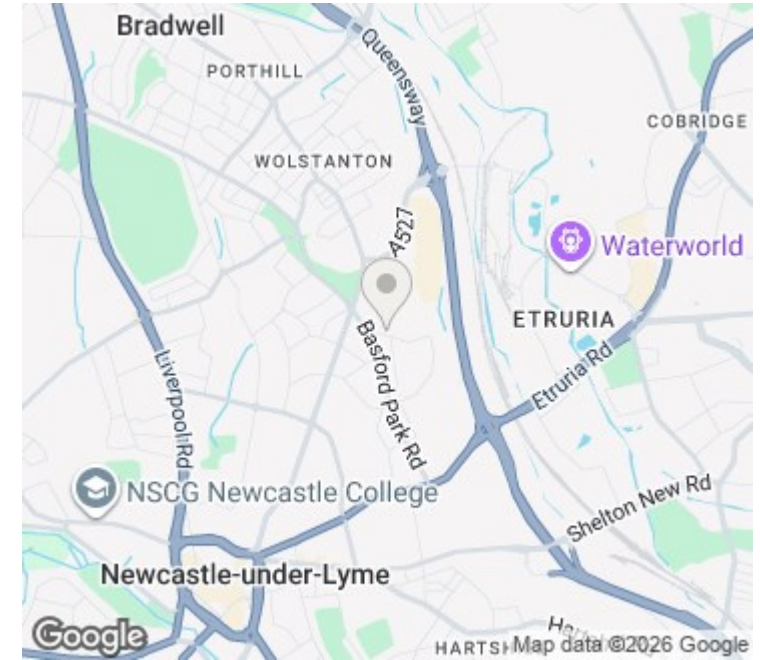

Energy Efficiency Rating	
Current	Potential
Very energy efficient - lower running costs	
(92 plus) A	64
(81-91) B	
(69-80) C	
(55-68) D	
(39-54) E	
(21-38) F	
(1-20) G	
Not energy efficient - higher running costs	
EU Directive 2002/91/EC	
England & Wales	

Environmental Impact (CO ₂) Rating	
Current	Potential
Very environmentally friendly - lower CO ₂ emissions	
(92 plus) A	88
(81-91) B	
(69-80) C	
(55-68) D	
(39-54) E	
(21-38) F	
(1-20) G	
Not environmentally friendly - higher CO ₂ emissions	
EU Directive 2002/91/EC	
England & Wales	

NOTICE: Stephenson Browne for themselves and for the vendors or lessors of this property whose agents they are give notice that: (1) the particulars are set out as a general guideline only for the guidance of intending purchasers or lessees, and do not constitute, nor constitute part of, an offer or contract; (2) all descriptions, dimensions, references to condition and necessary permissions for use and occupation, and other details are given in good faith and are believed to be correct but any intending purchasers or tenants should not rely on them as statements or representations of fact but must satisfy themselves by inspection or otherwise as to the correctness of each theme; (3) no person in the employment of Stephenson Browne has any authority to make representation or warranty whatever in relation to this property. (4) fixtures & fittings are subject to a formal list supplied by the vendors solicitors. **Referring to:** Move with Us Ltd **Average Fee:** £123.64

T: 01782 625734 opt 2 E: newcastlelettings@stephensonbrowne.co.uk

www.stephensonbrowne.co.uk