



Sydney Wharf,

£155,000

FOR SALE



- Over 60's
- Great Central Location
- No Onwards Chain
- One Bedroom Apartment
- Communal and Guest Facilities
- Local amenities

## THE PROPERTY

This apartment at Sydney Wharf, available for those aged 60 and over, offers an excellent opportunity to embrace comfortable living in a beautiful riverside setting. Whether you're looking to simplify your lifestyle or enjoy a welcoming community, this well-presented home could be the perfect next move.

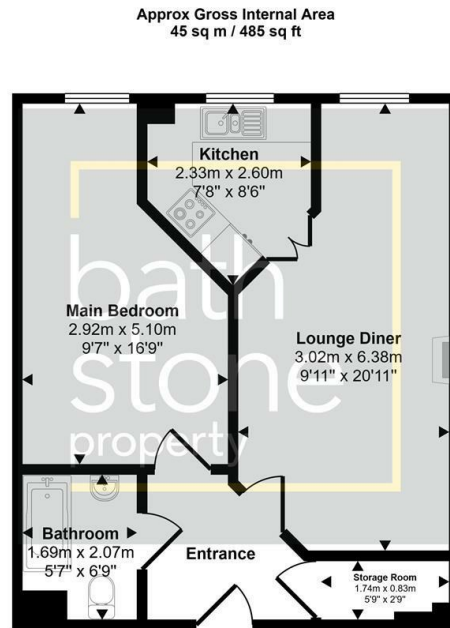

Floorplan

This floorplan is only for illustrative purposes and is not to scale. Measurements of rooms, doors, windows, and any items are approximate and no responsibility is taken for any error, omission or mis-statement. Icons of items such as bathroom suites are representations only and may not look like the real items. Made with Made Snappy 360.



Energy Efficiency Rating		Current	Potential
Very energy efficient - lower running costs			
(92 plus) A			
(81-91) B			
(69-80) C			
(55-68) D			
(39-54) E			
(21-38) F			
(1-20) G			
Not energy efficient - higher running costs			
		73	83
<b>England &amp; Wales</b>		EU Directive 2002/91/EC	