



## 20 Norwood Grove, Harrogate

£295,000 Guide Price

VERITY  
FREARSON

YOUR AWARD  
WINNING AGENT

#DARINGTOBEDIFFERENT



**A spacious three-bedroom, double-fronted semi-detached home, occupying a generous plot at the head of a peaceful cul-de-sac and enjoying a superb position backing onto Oakdale Golf Course.**

Externally, the property occupies a generous plot with a well-maintained front garden, ample off-street parking, and a detached garage. The rear garden is designed for ease of maintenance, featuring a generous gravelled seating area and paved terrace—ideal for outdoor entertaining—while enjoying a high degree of privacy and a superb backdrop backing directly onto Oakdale Golf Course.

Situated in a quiet cul-de-sac, the property is conveniently located for access to Harrogate town centre, well-regarded schools, and local amenities, making it an ideal choice for families and professionals alike.

Council Tax band: C

Tenure: Freehold



This excellent family home offers well-balanced and versatile accommodation, ideal for modern living. An entrance hall leads through to a generously proportioned dual-aspect sitting room, enjoying excellent natural light and featuring French doors opening onto the rear garden, creating a bright and inviting space for both relaxing and entertaining. The heart of the home is the spacious dining kitchen, fitted with a range of wall and base units with complementary work surfaces and integrated appliances. There is ample room for a family dining table, making it perfect for everyday living and hosting. A ground floor WC completes the accommodation on this level.

To the first floor, a bright and airy landing leads to three well-proportioned bedrooms, all enjoying a pleasant outlook and offering flexibility for family life, guest accommodation, or home working. The house bathroom is fitted with a modern white suite, comprising a panelled bath, separate shower enclosure, wash hand basin, and WC.



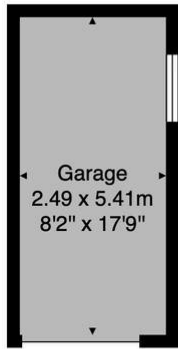

Garage

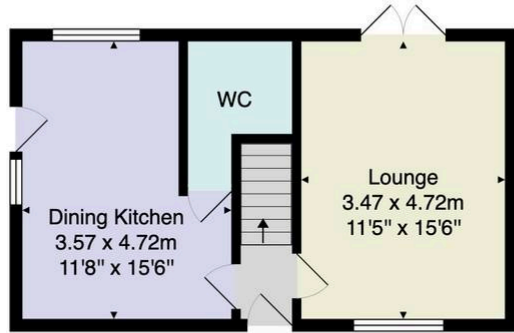

Ground Floor

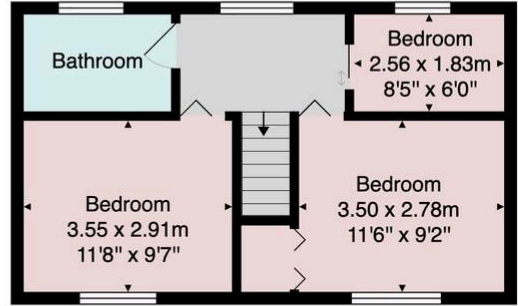

First Floor

Total Area: 77.6 m<sup>2</sup> ... 836 ft<sup>2</sup> (excluding garage)

All measurements are approximate and for display purposes only.

No liability is accepted by either the agency or Box Property Solutions Ltd as to the exact measurements of the rooms.  
Box Property Solutions Ltd retains the copyright on this plan and allows agents to use it with agreed permission.

