



# Castles

ASKING PRICE

**£700,000**

**Pembroke Avenue**

Enfield, EN1 4HE



## PROPERTY SUMMARY

A beautifully presented semi-detached home offering a perfect blend of modern comfort and classic style, with 1,760 sq ft of generous living space.

The property features four bedrooms—three on the first floor and a loft bedroom with an en-suite. There are three bathrooms in total, including one on the ground floor. The home also offers two bright and spacious reception rooms and a high-spec, fully updated kitchen, ready for immediate move-in.

The loft room provides excellent privacy, while the large garage offers ample space for cars and additional storage.

Outside, you'll find both a front and rear garden, fully gated and equipped with an intercom front gate, adding convenience and security.

This is an ideal family home in a friendly neighbourhood with great local amenities.





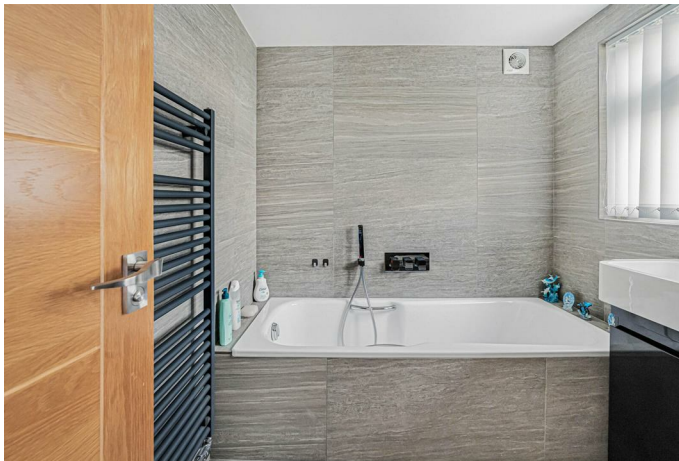



**Approximate Gross Internal Area = 1760 sq ft / 163.4 sq m  
(Including Garage & Outbuilding)**

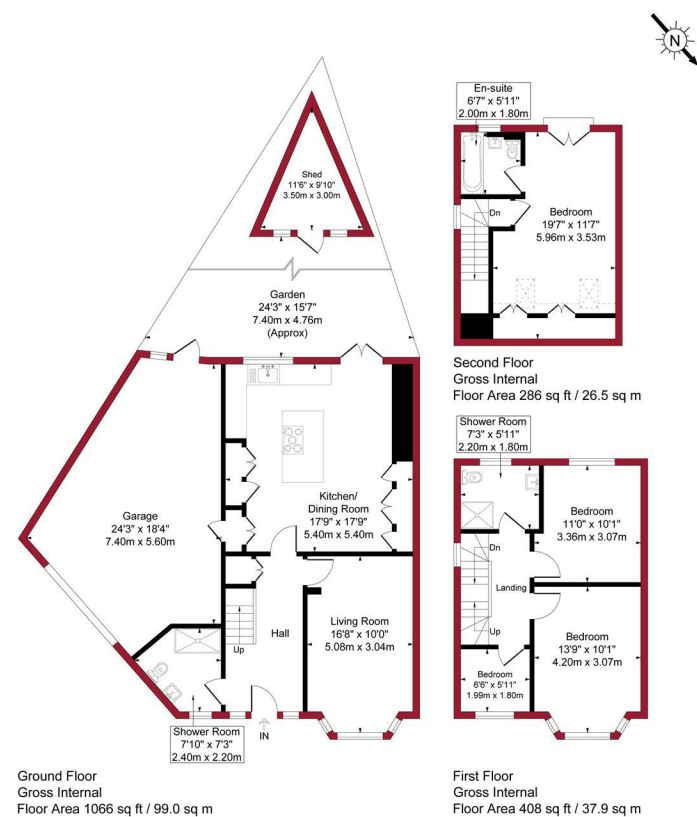

SCAN ME



**Council Tax Band: D**



243 - 245 Hertford Road  
Enfield  
London  
EN3 5JJ

0208 804 8000  
enfield@castles.london  
<https://www.castles.london>

