



## DELANCEY STREET, NW1

£475,000

One double bedroom  
Walk-in wardrobe  
Private garden  
Long lease  
Gated development  
Low service charges

@marshandparsons  
marshandparsons.co.uk

MARSH &  
PARSONS



# ABOUT THE PROPERTY

Delancey Studios is a gated boutique development of just 17 properties, ideally located in the heart of Camden. Beautifully presented throughout, the property benefits from a private garden, a spacious bedroom with a walk-in wardrobe, a long lease, and low service charges.

The property is situated within walking distance of Regent's Park, Primrose Hill, and Camden Town, offering an excellent array of amenities. Nearby transport links include London Euston, as well as Camden Town and Mornington Crescent Underground stations.



# STEP INSIDE DELANCEY STREET

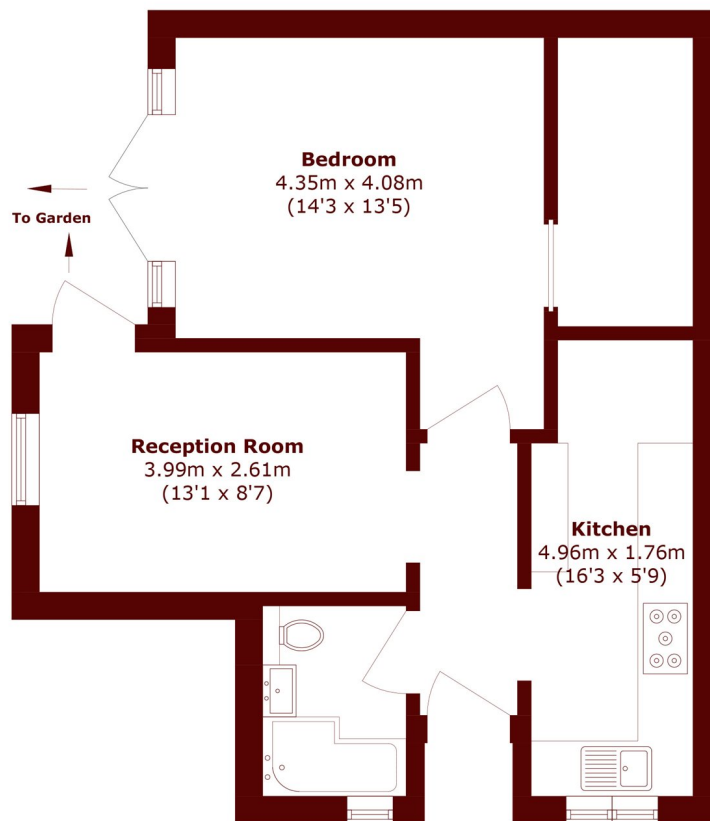

## Ground Floor

Total area (approx.): 47.7 sq. m (513.7 sq. ft)

Camden  
020 7244 2200

Energy Rating: C We aim to make our particulars both accurate and reliable. However, they are not guaranteed; nor do they form part of an offer or contract. If you require clarification on any points then please contact us, especially if you're traveling some distance to view. Please note that appliances and heating systems have not been tested and therefore no warranties can be given as to their good working order

MARSH &  
PARSONS