



Guide Price
£325,000

Freehold

2x  1x  1x 

**Manordene Road,
London, SE28**

OVER 60?

Secure this property
for up to **59% less!**

Wards
Helping you move forwards



Main features

- Central yet tucked away position for this spacious home
- Two bedrooms
- Allocated parking for 1 car
- Charming garden backing onto the canal, creating a tranquil aspect
- Ideal first time purchase

Accommodation

GROUND FLOOR

Entrance Porch

Lounge: 13'5 x 12'3 (4.09m x 3.74m)

Kitchen/Diner: 12'2 x 8'8 (3.71m x 2.64m)

FIRST FLOOR

Landing

Bedroom 1: 12'4 x 7'0 (3.76m x 2.14m)

Bedroom 2: 12'4 x 7'3 (3.76m x 2.21m)

Bathroom

OUTSIDE

Allocated Parking

Rear Garden

Front Garden

Ground Floor

Approx. 30.5 sq. metres (328.4 sq. feet)

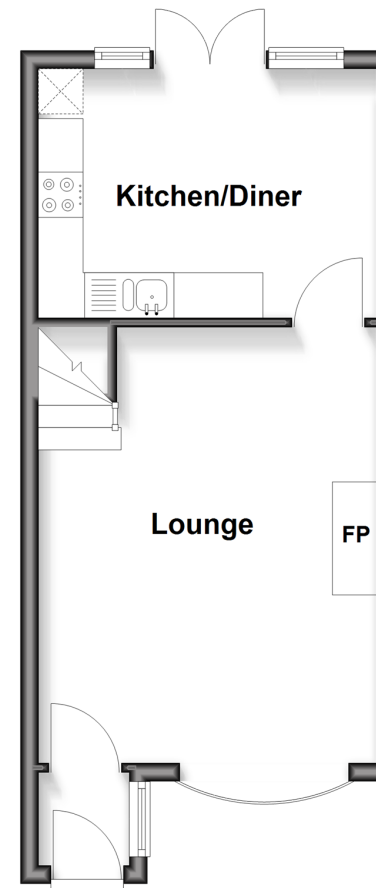

First Floor

Approx. 29.1 sq. metres (313.5 sq. feet)

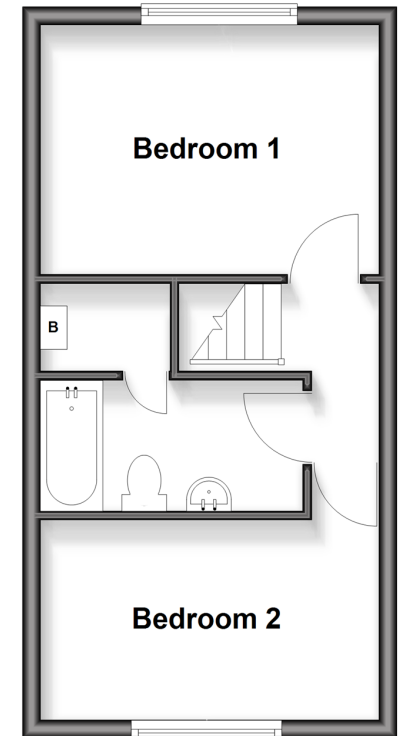

Call Barnehurst - 01322 335525 ■ wardsofkent.co.uk

- If buying to rent, please check if Local Authority licensing schemes apply before proceeding
- Through a Homewise Home For Life Plan people aged 60+ can secure this property for up to 59% less, by purchasing a Lifetime Lease



147008TH/20260611/JS1/DH