



**Guide Price**  
**£275,000**

**Freehold**

2x  1x  1x 

**Church Street,  
Nonington, Dover, Kent,  
CT15**

**OVER 60?**

Secure this property  
for up to **59% less!**

*Wards*  
Helping you move forwards

## Ground Floor

Approx. 31.5 sq. metres (338.7 sq. feet)

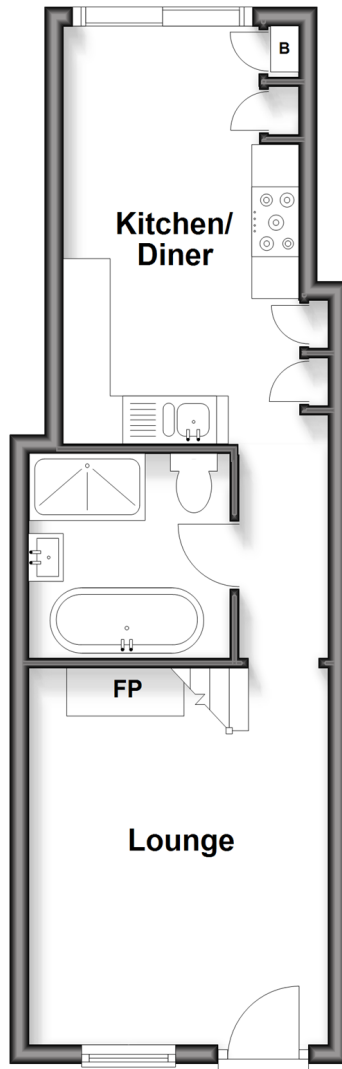

## First Floor

Approx. 19.8 sq. metres (212.6 sq. feet)

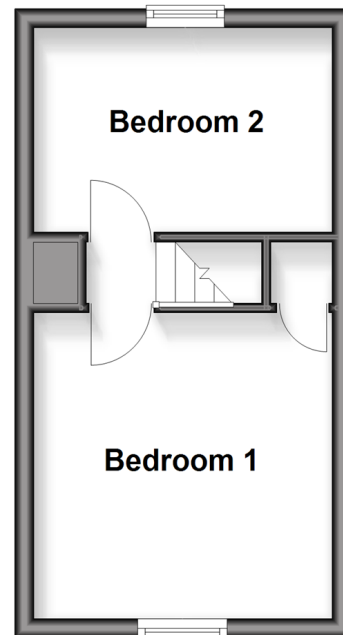

## Accommodation

### GROUND FLOOR

Lounge : 10'1 x 10'1 (3.08m x 3.08m)

Kitchen/Diner : 14'6 x 8'9 (4.42m x 2.67m)

Bathroom

### FIRST FLOOR

Landing

Bedroom 1 : 10'2 x 10'2 (3.10m x 3.10m)

Bedroom 2 : 10'1 x 6'10 (3.08m x 2.08m)

### OUTSIDE

Rear Garden



## Main features

- Beautifully renovated and extended village cottage
- Major upgrades including full rewire, new boiler and improved ventilation system
- Modern kitchen with quartz worktops & full-height splashbacks
- Cosy lounge with wood-burning stove & oak flooring
- Long enclosed rear garden



### Nearest Schools

Primary Schools: Nonington C of E Primary 0.1 miles, St Joseph's Catholic Primary 0.6 miles, Aylesham Primary 1.0 miles  
Secondary Schools: Sandwich Technology School 5.6 miles, Dover Christchurch Academy 6.0 miles



### Transport Information

Train Stations: Shepherdswell 2.4 miles, Kearsney 5.5 miles, Martin Mill 6.6 miles



### Address

Church Street, Nonington, Dover, Kent, CT15



### Directions

For directions to this property please contact us.



*Wards*  
Helping you move forwards

Call Dover Branch 01304 214876 ■ [wardsofkent.co.uk](http://wardsofkent.co.uk)



**Unable to display material information. Please check with the branch for material information details for this property**



10736360/20260318/OV/GM