



ELSTREE APARTMENTS, NW9

£1,499 pcm

This spacious 420 sq/ft second-floor studio offers ample storage and modern living. Featuring lift access and a well-designed layout, the property provides a comfortable and efficient home for urban professionals.

- Spacious 420 SQFT

-

Colindale Station Nearby



ABOUT THE HOME

Conveniently located just ten minutes from Colindale Station, this property offers easy Northern Line access. Residents benefit from being moments away from essential local amenities and vibrant neighbourhood shopping hubs.





- FE Fire Extinguishes
- SA Smoke Alarm
- CMA Carbon Monoxide Alarm

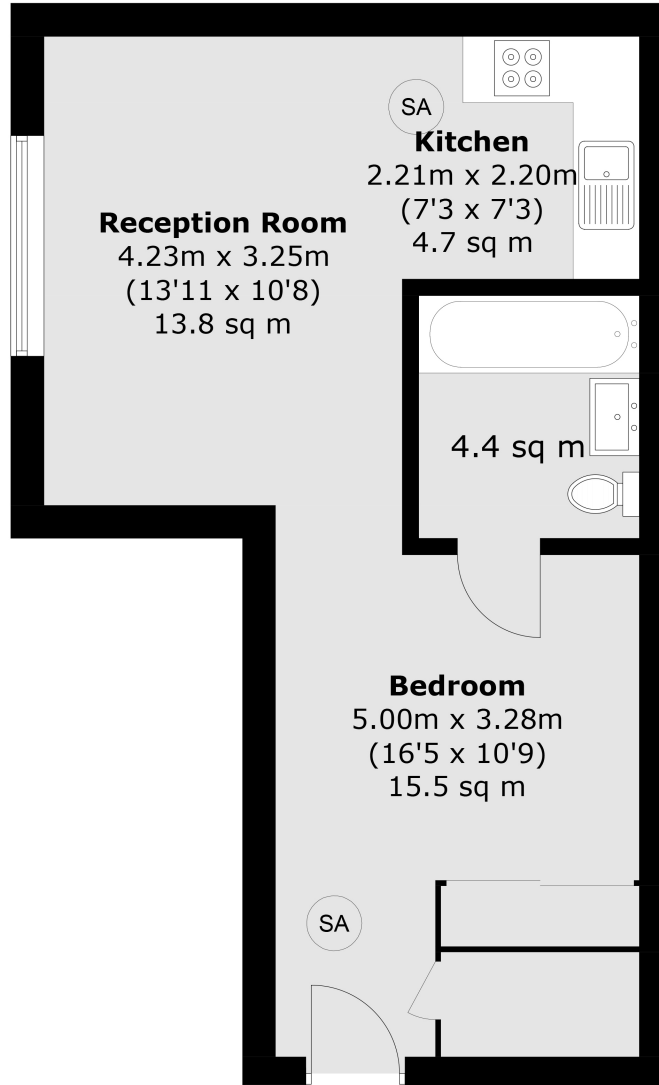

Total area (approx.): 39.6 sq. m (426.2 sq. ft)

LiFE RESIDENTIAL

203 Trentham Court, Victoria
Road, London, W3 6BT
Sales: 020 3668 1112
Lettings: 020 3668 1111

Energy Rating: B. We aim to make our particulars both accurate and reliable. However they are not guaranteed; nor do they form part of an offer or contract. If you require clarification on any points then please contact us, especially if you're traveling some distance to view. Please note that appliances and heating systems have not been tested and therefore no warranties can be given as to their good working order.