



St. Mary's Road, London SE15

London

£290,000

## St. Mary's Road, London

Spacious one-bedroom first-floor apartment on St. Mary's Road, Peckham. Features bright living space, communal gardens, separate kitchen, excellent transport links and no onward chain.

Council Tax band: B

Tenure: Leasehold

EPC Energy Efficiency Rating: D

EPC Environmental Impact Rating: D

- Chain-free
- Landscaped Communal Garden
- New Lease
- Ideal renovation project
- Excellent transport links nearby
- Double Glazing



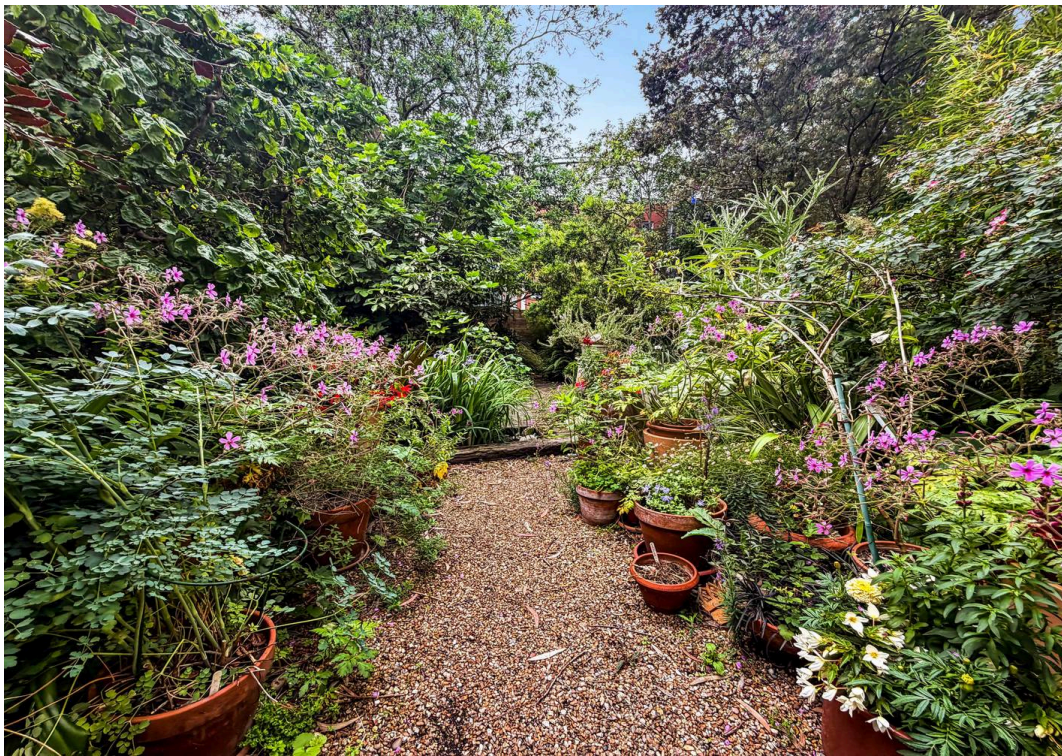





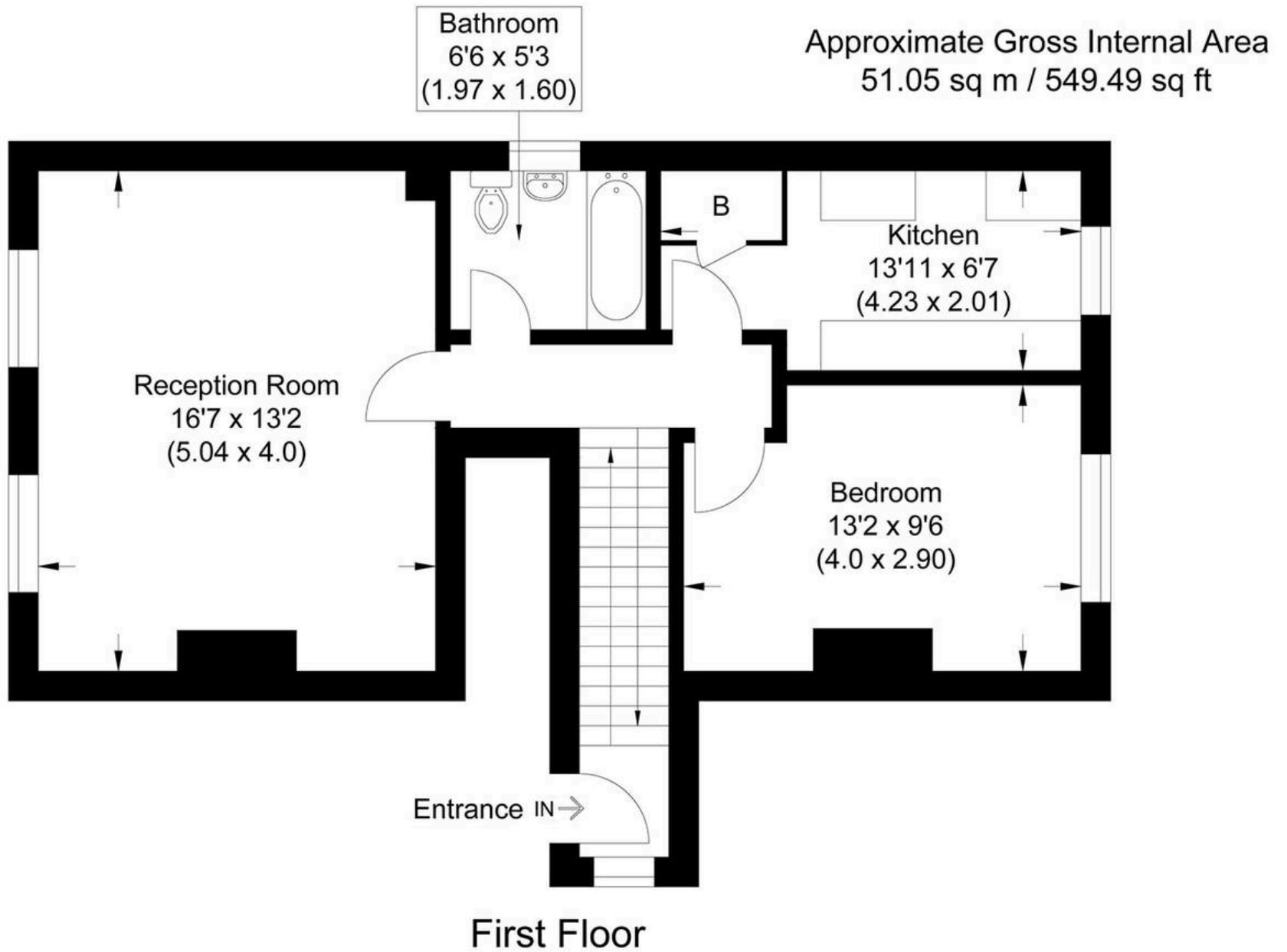

Illustration for identification purposes only, measurements are approximate, not to scale.



## MA-Residential

1st Floor Romer House, 132 Lewisham High Street, London - SE13 6EE

020 8264 4464

[hello@ma-residential.com](mailto:hello@ma-residential.com)

[ma-residential.com](http://ma-residential.com)