

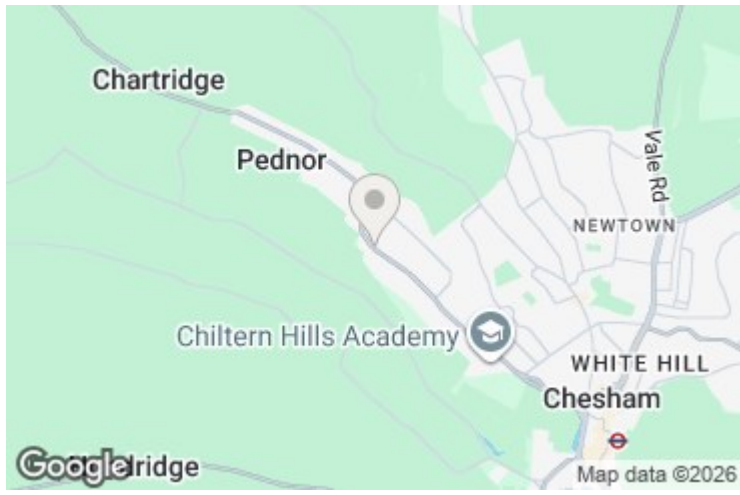

**Saxeway Drive, Chartridge Lane  
Chesham, Buckinghamshire HP5 2AE**

**£1,150**

1st Choice Properties are pleased to offer this one bedroom apartment which is set within a quiet backwater location. The apartment will be available IMMEDIATELY . The Property benefits from gas to radiator heating, double glazing, fully fitted kitchen. The property comprises of entrance hall, lounge/ open plan kitchen, bedroom, shower/room, courtyard garden and on road parking. We strongly advise an early inspection to avoid disappointment.



GROUND FLOOR

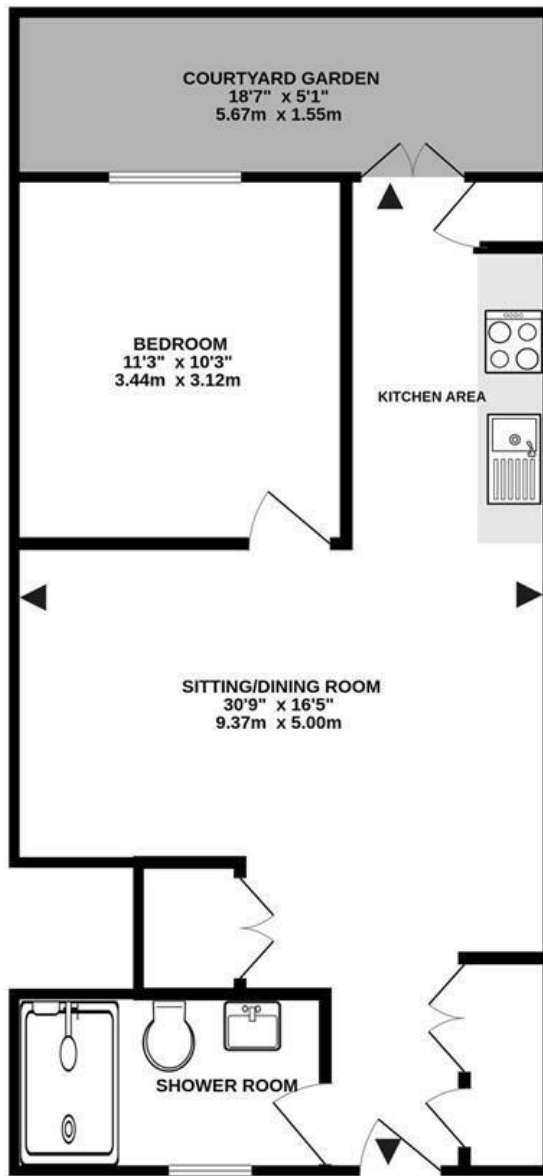

SAXEWAY DRIVE, CHARTRIDGE HP5 2AE

TOTAL FLOOR AREA : 490sq.ft. (45.5 sq.m.) approx.

No accuracy to this image, text or measurements is guaranteed  
Made with Metropix ©2026

Energy Efficiency Rating		
	Current	Potential
<i>Very energy efficient - lower running costs</i>		
(92 plus) <b>A</b>		
(81-91) <b>B</b>		
(69-80) <b>C</b>		
(55-68) <b>D</b>		
(39-54) <b>E</b>		
(21-38) <b>F</b>		
(1-20) <b>G</b>		
<i>Not energy efficient - higher running costs</i>		
<b>England &amp; Wales</b>	EU Directive 2002/91/EC	

Environmental Impact (CO <sub>2</sub> ) Rating		
	Current	Potential
<i>Very environmentally friendly - lower CO<sub>2</sub> emissions</i>		
(92 plus) <b>A</b>		
(81-91) <b>B</b>		
(69-80) <b>C</b>		
(55-68) <b>D</b>		
(39-54) <b>E</b>		
(21-38) <b>F</b>		
(1-20) <b>G</b>		
<i>Not environmentally friendly - higher CO<sub>2</sub> emissions</i>		
<b>England &amp; Wales</b>	EU Directive 2002/91/EC	

[www.1stchoice-properties.co.uk](http://www.1stchoice-properties.co.uk)

Lovat Bank, 37 Silver Street, Newport Pagnell, Buckinghamshire, MK16 0EJ | T. 01908 991277 | E. info@1stchoice-properties.co.uk

Registered in England No. 9306317 | Registered Office 1st Choice Properties St Albans Ltd. Lovat Bank, 37 Silver Street, Newport Pagnell, Buckinghamshire, MK16 0EJ