



Hitchings – SN6 6NJ
Cricklade

Fixed Price (40% Share) **£126,000**

mcfarlane
property.com

Hitchings

Cricklade, Swindon

- SHARED OWNERSHIP PROPERTY (40%)
- TWO Double Bedrooms
- Enclosed Rear Garden + Driveway
Parking for TWO Cars
- Master Bedroom with En-Suite
- Sought After Modern Development

A sought after modern development on the edge of Cricklade offering a shared ownership scheme. This well positioned and proportioned site offers a TWO DOUBLE Bedrooms with a 40% purchase.

Full market value - £315,000

Share % - 40%

Share value - £126,000

Rent - £403.30pcm

Service charge - £16.50pcm

Staircasing restrictions - Can staircase to 100%

Lease term - 118 years remaining



Hitchings

Cricklade, Swindon

Council Tax band: C

Tenure: Leasehold

EPC Energy Efficiency Rating: B

EPC Environmental Impact Rating: B



mcfarlane
property.com

Agents Note: Whilst every care has been taken to prepare these sales particulars, they are for guidance purposes only. All measurements are approximate and for general guidance purposes only and whilst every care has been taken to ensure their accuracy, they should not be relied upon and potential buyers are advised to recheck the measurements.

Ground Floor

Approx. 29.9 sq. metres (322.0 sq. feet)

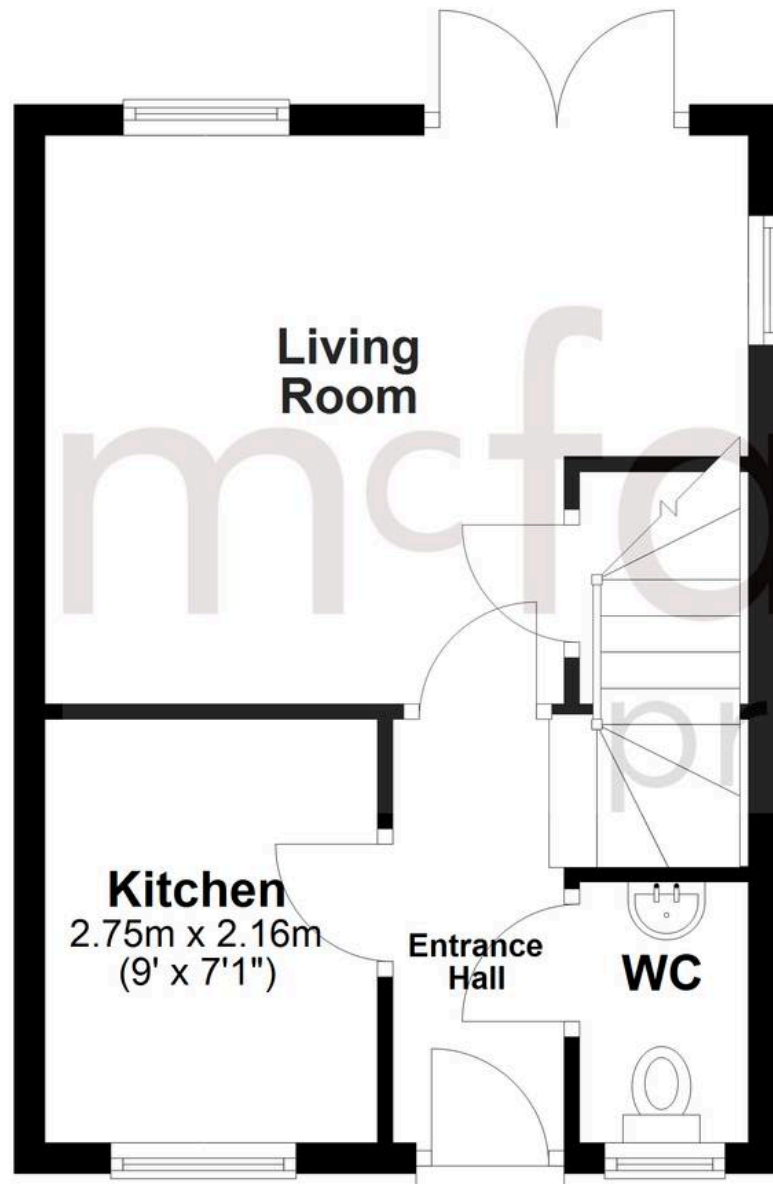

First Floor

Approx. 29.9 sq. metres (322.0 sq. feet)

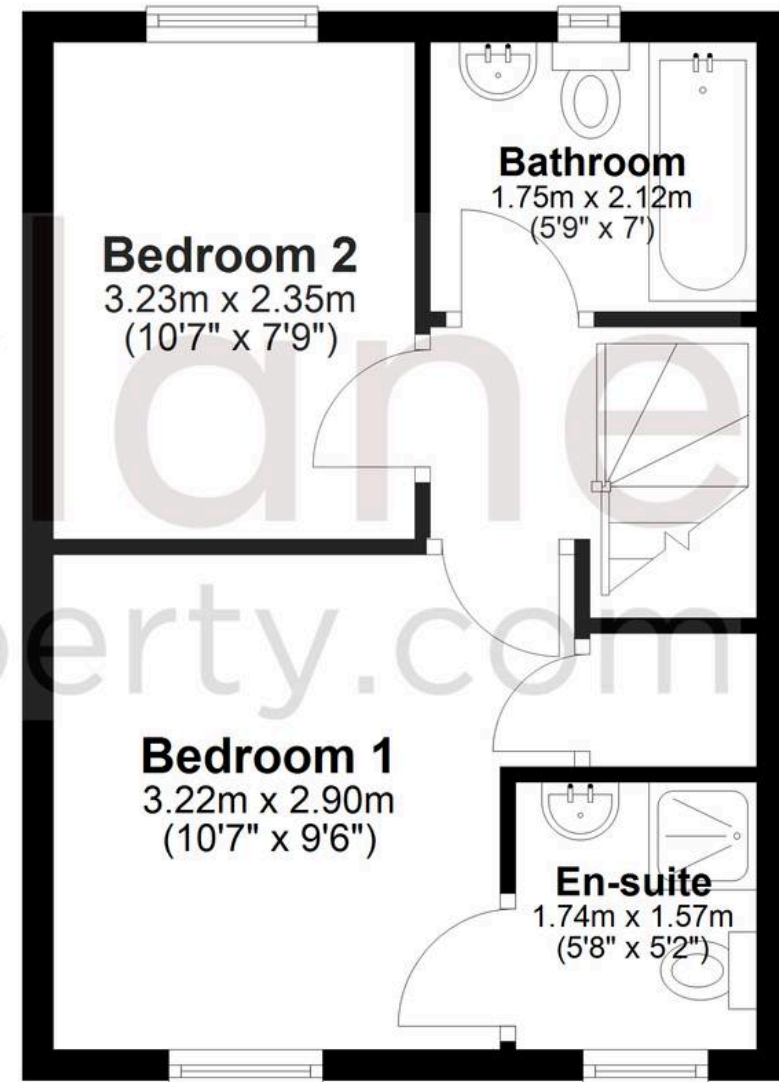

Total area: approx. 59.8 sq. metres (644.0 sq. feet)