



BOOTMAKERS COURT, E1

£2,400 pcm

Come and see out beautiful, modern two bedroom, two bathroom apartment, Ideally situated equi-distant from Mile End, Stepney Green and Lime House Stations

- Available 25th of May
- Two bedroom & Two bathroom Fully Furnished
- Views over the City
- Generous Private Balcony



ABOUT THE HOME

Ideally situated equi-distant from Mile End, Stepney Green and Lime House Stations, the development is superbly positioned for easy access all over City and close to Canary Wharf as well. Professionals & Students at Queen Mary University can enjoy a mere 10 minute walk to their departments.





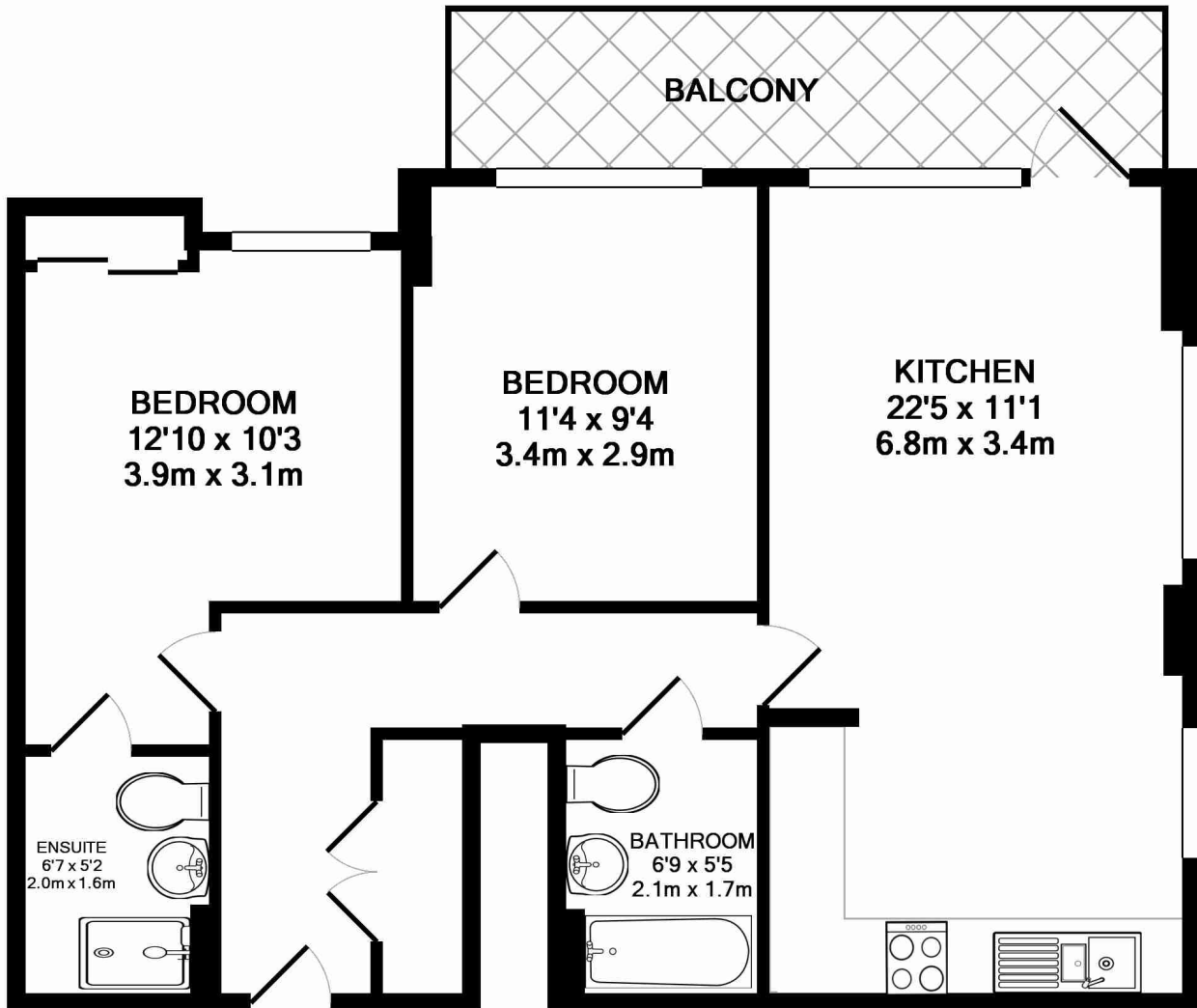

TOTAL APPROX. FLOOR AREA 634 SQ.FT. (58.9 SQ.M.)

Whilst every attempt has been made to ensure the accuracy of the floor plan contained here, measurements of doors, windows, rooms and any other items are approximate and no responsibility is taken for any error, omission, or mis-statement. This plan is for illustrative purposes only and should be used as such by any prospective purchaser. The services, systems and appliances shown have not been tested and no guarantee as to their operability or efficiency can be given

Made with Metropix ©2016

LiFE RESIDENTIAL

71 Drayton Park, London, N5

1BF

Sales: 020 3838 8666

Lettings: 020 7359 4488

Energy Rating: B. We aim to make our particulars both accurate and reliable. However they are not guaranteed; nor do they form part of an offer or contract. If you require clarification on any points then please contact us, especially if you're traveling some distance to view. Please note that appliances and heating systems have not been tested and therefore no warranties can be given as to their good working order.