



Tufnell Park Road, N19

£950,000

A well-presented three bedroom maisonette arranged over the upper floors of a Victorian conversion. The property has a private entrance, a spacious reception room, a separate kitchen and a south facing terrace.

Tufnell Park Road is moments from Tufnell Park station (Northern line) and is also ideally situated for the local independent boutiques, cafés and restaurants on Fortress Road.

Features

- Three Bedrooms
- Private Entrance
- Loft Access
- Private Terrace
- Victorian Conversion
- Great Transport Links



Tufnell Park Road, N19

The first floor features a lovely reception room with a feature fireplace, wood flooring and large windows, allowing lots of natural light into the property. There is also a separate kitchen on this floor with enough space for a dining table.

Ascending the stairs to the second floor, you will find three bedrooms, one of which is currently being used as a study/office space, and access to a lovely south facing terrace. The area is also well regarded for its excellent selection of nearby primary and secondary schools.



Tufnell Park Road, London, N19

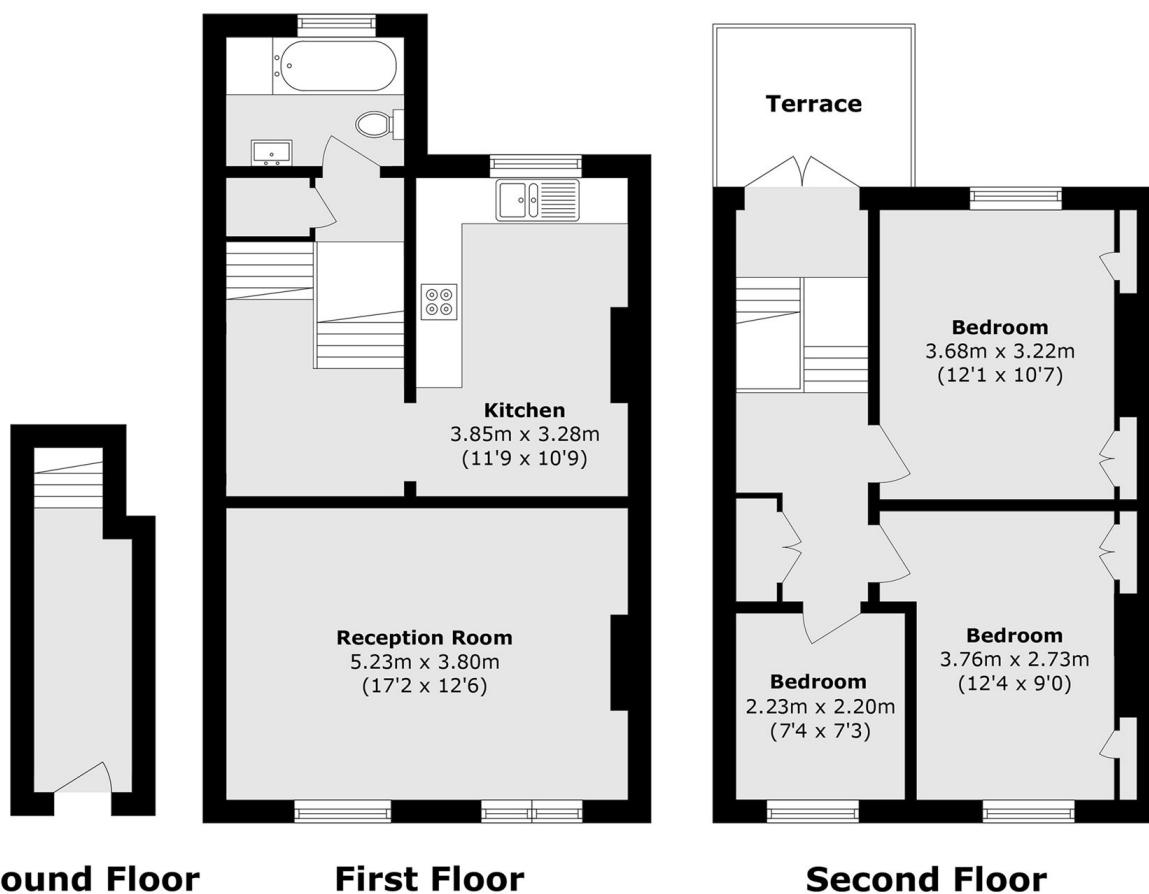

Total area (approx.): 92.0 sq. m (990.3 sq. ft)

Terrace area (approx.): 5.6 sq. m (60.3 sq. ft)