



7 Pemberton Road

Ashford, TN24 8BU

Price £225,000

Offered for sale with no onward chain is spacious terraced home in easy reach of Ashford town centre and mainline station. The property comprises an entrance hall, sitting room, dining room, kitchen, ground floor bathroom and three bedrooms.

Gas central heating and double glazing are installed with a pleasantly enclosed garden to the rear.

- TERRACED HOUSE
- THREE BEDROOMS
- TWO RECEPTION ROOMS
- GROUND FLOOR BATHROOM/WC
- WALKING DISTANCE TO TOWN CENTRE
- GAS CENTRAL HEATING
- NO ONWARD CHAIN

Viewing

Please contact our Ashford Office on 01233 646411 if you wish to arrange a viewing appointment for this property or require further information.



2



1



1



C

Floor Plan

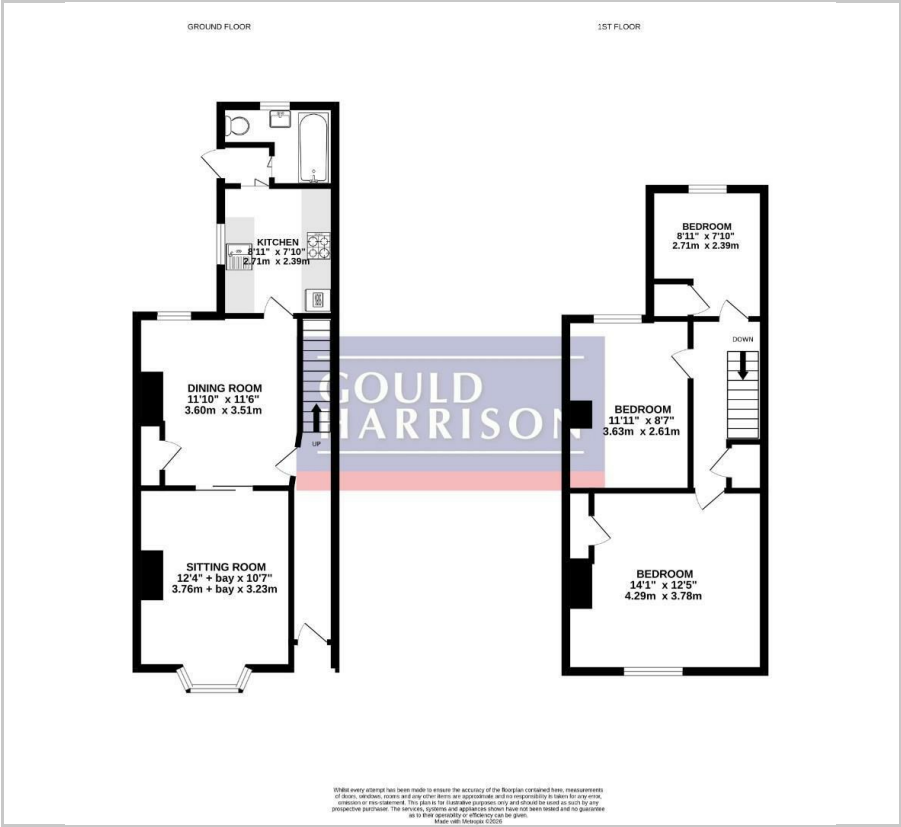

Area Map



Energy Efficiency Graph

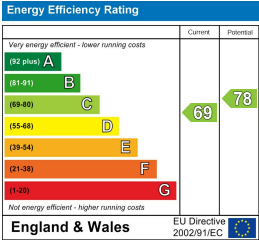

These particulars, whilst believed to be accurate are set out as a general outline only for guidance and do not constitute any part of an offer or contract. Intending purchasers should not rely on them as statements of representation of fact, but must satisfy themselves by inspection or otherwise as to their accuracy. No person in this firm's employment has the authority to make or give any representation or warranty in respect of the property.