



Westbourne Terrace, W2

£2,250 Per week

A spacious and recently refurbished one bedroom flat within a Victorian period Stucco building on Westbourne Terrace. Layout includes a large reception, semi-open plan kitchen and a modern tiled bathroom with shower over bath.

Westbourne Terrace is moments from local shops and restaurants and within easy reach of Paddington station and Hyde Park.

Features

- One Bedroom
- Recently Refurbished
- Large Reception
- Modern Bathroom
- Private Outside Space
- Period Conversion

Westbourne Terrace, London, W2

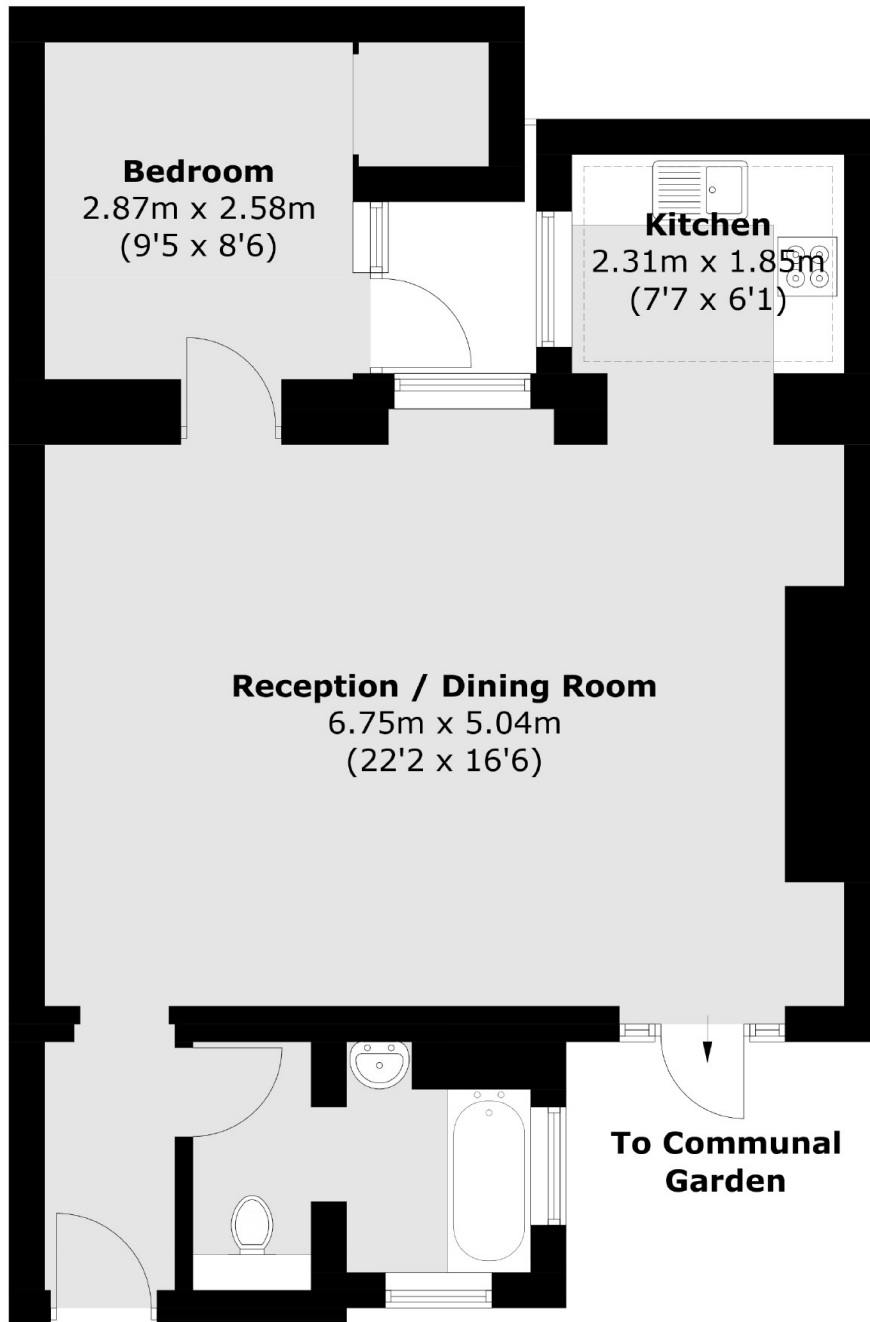

Lower Ground Floor

Total area (approx.): 58.3 sq. m (627.5 sq. ft)
External area (approx.): 1.9 sq. m (20.4 sq. ft)