



HUNTERS®

HERE TO GET *you* THERE

54 Volta Street, Selby, YO8 8DF

54 Volta Street, Selby, YO8 8DF

Asking Price £160,000

DESCRIPTION

Hunters Selby are delighted to offer for sale this well presented two bedroom mid terrace property situated within walking distance of Selby town Centre. The property benefits from a gas central heating system, UPVC double glazing and briefly comprises a lounge, dining room and kitchen to the ground floor. To the first floor there are two double bedrooms and a family bathroom. The staircase in second bedroom leads to the loft office. Outside to the rear of the property there is a low maintenance courtyard garden with outbuilding that is currently used as a bar/games room and a separate toilet, Viewing comes highly recommended to appreciate the accommodation on offer. Call Hunters Selby, seven days a week to book a viewing.

LOCATION

The ancient town of Selby was originally settled during the Roman period, and since then has built a rich and varied history, from battles to the birth of King Henry I. The amenities of the town are comprehensive, including supermarkets, a hospital, several good schools at primary and secondary level, many pubs and restaurants, along with a bustling high street with its selection of shops. The town is also home to the beautiful Selby Abbey, founded in 1069. Another strong point of Selby is its excellent transport links, with bus links to all of the surrounding towns and cities and direct rail routes to London, Leeds, Manchester and York.

DIRECTIONS

From our Finkle Street office, take the left turn onto Micklegate, turn right onto Water Lane, continue onto Ousegate then onto Shipyard Road. Turn left onto Denison Road then turn left on to Volta Street where the property can be identified by our Hunters for sale board.

Material Information - Selby

Tenure Type; Freehold
Council Tax Banding; A
EPC Rating : D

Hunters Selby 23 Finkle Street, Selby, YO8 4DT | 01757 210884
selby@hunters.com | www.hunters.com



Ground Floor
Floor area 43.9 sq.m.
(472 sq.ft.)



First Floor
Floor area 38.6 sq.m.
(416 sq.ft.)

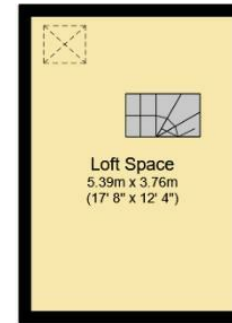

Second Floor
Floor area 20.0 sq.m.
(215 sq.ft.)



Outbuilding
Floor area 17.8 sq.m.
(192 sq.ft.)

Total floor area: 120.4 sq.m. (1,296 sq.ft.)

This floor plan is for illustrative purposes only. It is not drawn to scale. Any measurements, floor areas (including any total floor area), openings and orientations are approximate. No details are guaranteed, they cannot be relied upon for any purpose and do not form any part of any agreement. No liability is taken for any error, omission or misstatement. A party must rely upon its own inspection(s). Powered by www.Propertybox.io

Energy Efficiency Rating		
	Current	Potential
Very energy efficient - lower running costs		
(92 plus) A		
(81-91) B		
(69-80) C		
(55-68) D		
(39-54) E		
(21-38) F		
(1-20) G		
Not energy efficient - higher running costs		
	67	75
England & Wales	EU Directive 2002/91/EC	

Environmental Impact (CO ₂) Rating		
	Current	Potential
Very environmentally friendly - lower CO ₂ emissions		
(92 plus) A		
(81-91) B		
(69-80) C		
(55-68) D		
(39-54) E		
(21-38) F		
(1-20) G		
Not environmentally friendly - higher CO ₂ emissions		
England & Wales	EU Directive 2002/91/EC	

DESCRIPTION

Hunters Selby are delighted to offer for sale this well presented two bedroom mid terrace property situated within walking distance of Selby town Centre. The property benefits from a gas central heating system, UPVC double glazing and briefly comprises a lounge, dining room and kitchen to the ground floor. To the first floor there are two double bedrooms and a family bathroom. The staircase in second bedroom leads to the loft office. Outside to the rear of the property there is a low maintenance courtyard garden with outbuilding that is currently used as a bar/games room and a separate toilet, Viewing comes highly recommended to appreciate the accommodation on offer. Call Hunters Selby, seven days a week to book a viewing.

LOCATION

The ancient town of Selby was originally settled during the Roman period, and since then has built a rich and varied history, from battles to the birth of King Henry I. The amenities of the town are comprehensive, including supermarkets, a hospital, several good schools at primary and secondary level, many pubs and restaurants, along with a bustling high street with its selection of shops. The town is also home to the beautiful Selby Abbey, founded in 1069. Another strong point of Selby is its excellent transport links, with bus links to all of the surrounding towns and cities and direct rail routes to London, Leeds, Manchester and York.

DIRECTIONS

From our Finkle Street office, take the left turn onto Micklegate, turn right onto Water Lane, continue onto Ousegate then onto Shipyard Road. Turn left onto Denison Road then turn left on to Volta Street where the property can be identified by our Hunters for sale board.

Material Information - Selby

Tenure Type; Freehold

Council Tax Banding; A
EPC Rating : D

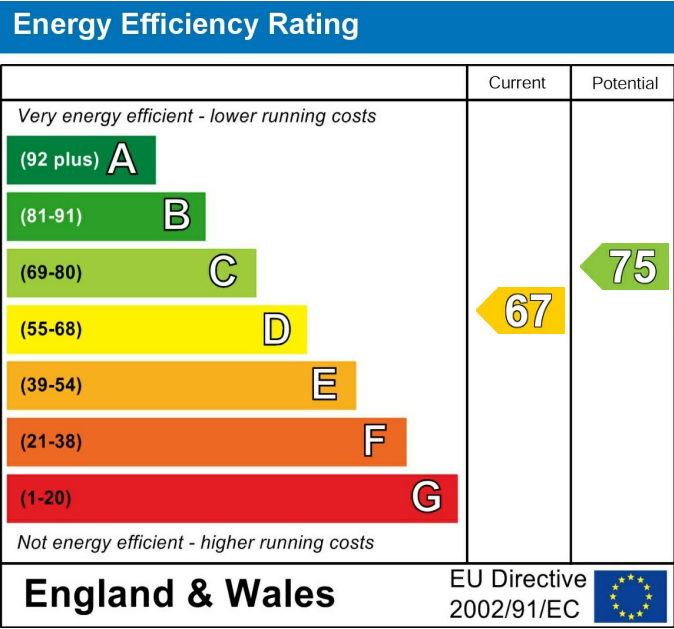

These particulars are intended to give a fair and reliable description of the property but no responsibility for any inaccuracy or error can be accepted and do not constitute an offer or contract. We have not tested any services or appliances (including central heating if fitted) referred to in these particulars and the purchasers are advised to satisfy themselves as to the working order and condition. If a property is unoccupied at any time there may be reconnection charges for any switched off/disconnected or drained services or appliances - All measurements are approximate. If you are thinking of selling your home or just curious to discover the value of your property, Hunters would be pleased to provide free, no obligation sales and marketing advice. Even if your home is outside the area covered by our local offices we can arrange a Market Appraisal through our national network of Hunters estate agents.









