



## ARENA TOWER, E14

**£600,000**

A south-east facing, two bedroom apartment in the popular Arena Tower. This property provides a spacious kitchen/reception which leads out to a large private balcony, two double bedrooms, one of which features an en suite, and a family bathroom.

- Two Bedrooms
- Gym and Pool
- Cinema
- Lease Length 980 Years
- Ground Rent £750
- Service Charge £7,427

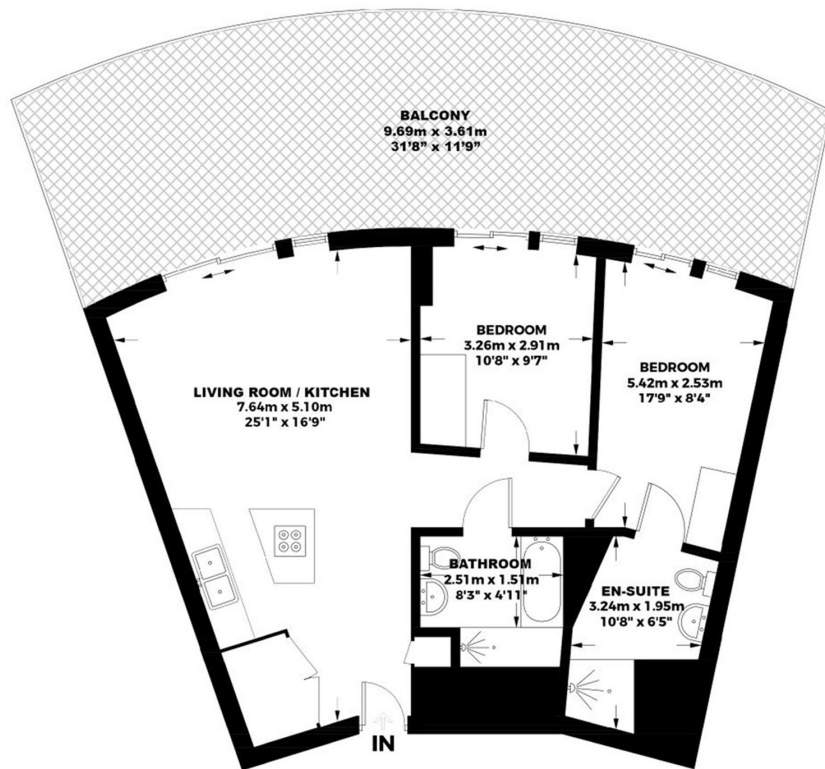

**Approximate Gross Internal Area = 780 sq ft or 72 sq mtr**

**All dimensions are estimates only and may not be exact measurements. Areas are approximate. Floor plans and development plans are subject to change. The sketches, renderings, graphic materials, plans, specifics, terms, conditions and statements are proposed only, and the developer, the management company, the owners and other affiliates reserve the right to modify, revise or withdraw any or all of same in their sole discretion and without prior notice.**

## LiFE RESIDENTIAL

36 Millharbour, London, E14

9JS

Sales: 020 3668 1033

Lettings: 020 3668 1030

Energy Rating: . We aim to make our particulars both accurate and reliable. However they are not guaranteed; nor do they form part of an offer or contract. If you require clarification on any points then please contact us, especially if you're traveling some distance to view. Please note that appliances and heating systems have not been tested and therefore no warranties can be given as to their good working order.