



College Close, Wainfleet Skegness PE24 4EN

welcome to

College Close, Wainfleet Skegness

Three bedroom detached home in the sought after village of Wainfleet, offering spacious and versatile living accommodation throughout. Benefiting from a lounge, dining room, study, conservatory and kitchen, alongside two double bedrooms and a single bedroom.

Entrance

Leading into a small entrance hallway with stairs leading to the first floor and access into living room and study.

Lounge

16' 2" x 10' 5" (4.93m x 3.17m)

Window to front elevation, radiator, fire place with hearth and surround, sliding door leading into conservatory and door leading into inner hallway.

Conservatory

13' 2" x 8' 7" (4.01m x 2.62m)

With windows to the rear elevation offering views of the garden and open field, double doors leading out to the garden.

Kitchen

10' x 8' 1" (3.05m x 2.46m)

Wall, base and drawer units with worktop space over, sink & drainer, integrated electric hob and oven part tiled splashbacks, window to rear elevation and radiator.

Dining Room

10' 7" x 8' (3.23m x 2.44m)

With window to side elevation, radiator and door leading into study.

Study

10' 7" x 7' 9" (3.23m x 2.36m)

With window to front elevation and radiator.

Bedroom 1

11' 1" x 10' 9" (3.38m x 3.28m)

Double bedroom with radiator and window to front elevation.

Bedroom 2

11' x 10' 6" (3.35m x 3.20m)

Double bedroom with radiator, window to front elevation and built in wardrobes and cupboard.

Bedroom 3

7' 7" x 7' 1" (2.31m x 2.16m)

With window to rear elevation and radiator.

Bathroom

Bath with shower over, toilet, sink and window to side elevation.

External

Well landscaped and maintained rear garden with a range of mature shrubs and flower beds. Beautiful views across the open field to the rear of the property.
The front of the property offers an allocated parking space.





view this property online williamhbrown.co.uk/Property/SKG110213



welcome to

College Close, Wainfleet Skegness

- Detached three bedroom house
- Spacious lounge
- Separate dining room
- Study/home office
- Conservatory overlooking the garden

Tenure: Freehold EPC Rating: D
Council Tax Band: C

offers in the region of
£240,000

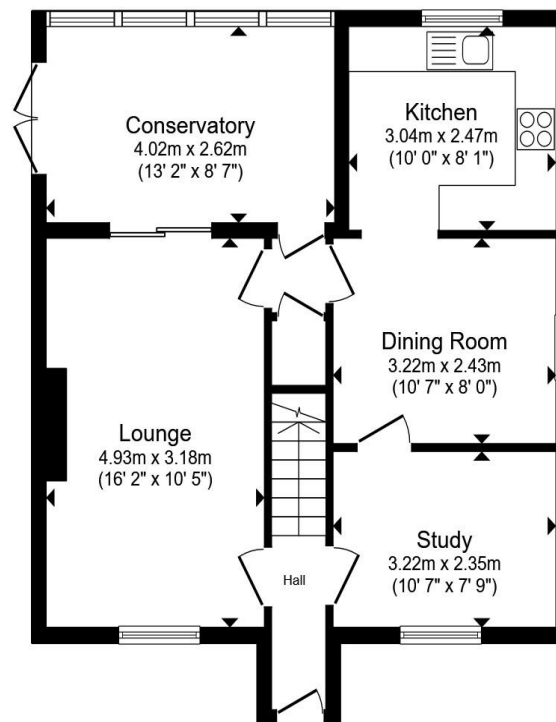

Ground Floor

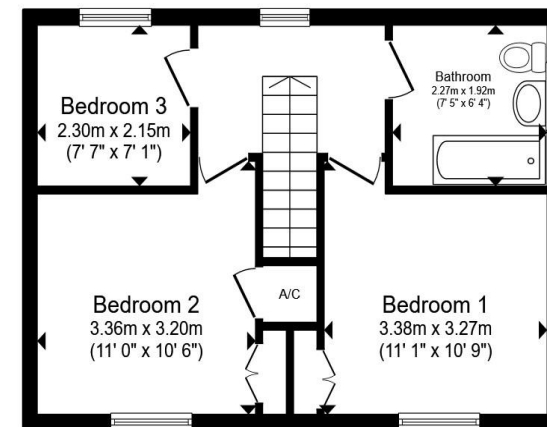

First Floor

Total floor area 99.5 m² (1,071 sq.ft.) approx

This floor plan is for illustrative purposes only. It is not drawn to scale. Any measurements, floor areas (including any total floor area), openings and orientation are approximate. No details are guaranteed, they cannot be relied upon for any purpose and they do not form part of any agreement. No liability is taken for any error, omission or misstatement. A party must rely upon its own inspection(s). Powered by www.propertybox.io



view this property online williamhbrown.co.uk/Property/SKG110213



Property Ref:
SKG110213 - 0002

1. MONEY LAUNDERING REGULATIONS Intending purchasers will be asked to produce identification documentation at a later stage and we would ask for your co-operation in order that there is no delay in agreeing the sale. 2. These particulars do not constitute part or all of an offer or contract. 3. The measurements indicated are supplied for guidance only and as such must be considered incorrect. Potential buyers are advised to recheck measurements before committing to any expense. 4. We have not tested any apparatus, equipment, fixtures or services and it is in the buyers interest to check the working condition of any appliances. 5. Where an EPC, or a Home Report (Scotland only) is held for this property, it is available for inspection at the branch by appointment. If you require a printed version of a Home Report, you will need to pay a reasonable production charge reflecting printing and other costs. 6. We are not able to offer an opinion either written or verbal on the content of these reports and this must be obtained from your legal representative. 7. Whilst we take care in preparing these reports, a buyer should ensure that his/her legal representative confirms as soon as possible all matters relating to title including the extent and boundaries of the property and other important matters before exchange of contracts.

William H Brown is a trading name of Sequence (UK) Limited which is registered in England and Wales under company number 4268443, Registered Office is Cumbria House, 16-20 Hockliffe Street, Leighton Buzzard, Bedfordshire, LU7 1GN. VAT Registration Number is 500 2481 05.

william h brown



01754 768311



Skegness@williamhbrown.co.uk



20 Roman Bank, SKEGNESS, Lincolnshire, PE25 2RU



williamhbrown.co.uk