



Caernarvon Road
Norwich, Norfolk NR2 3HX
Guide price £475,000 - £500,000

claxtonbird
residential

Caernarvon Road, Norwich, Norfolk NR2 3HX

*** Guide Price £475,000 - £500,000 *** Nestled within the sought-after Golden Triangle area of Norwich, this splendid mid-terrace Victorian house offers a wonderful blend of classic charm and contemporary living. With its striking bay frontage and spacious over carriage layout, this home offers four bedrooms, including a master bedroom with an en-suite bathroom, as well as a separate shower room on the first floor. The ground floor features two inviting reception rooms, as well as a convenient cloakroom. The heart of the home is undoubtedly the extended open-plan kitchen/living area. This modern space has been designed for both functionality and style, featuring bi-folding doors that seamlessly connect to the larger-than-average garden. The property retains a host of original features that add to its charm, while the modern fitted kitchen and bathroom suites provide all the conveniences of contemporary living. This delightful home is not only a testament to Victorian architecture but also a comfortable space for modern family life. With its prime location just off Earham Road, residents will enjoy easy access to local amenities, parks, and excellent transport links. Offered for sale with no onward chain.

Sitting Room 13'10" max into bay x 11'8" max (4.22 max into bay x 3.58 max)

Glazed entrance door, upvc double glazed sash look bay window to front aspect, cast iron fireplace with wood surround and tiled hearth, cornice, stripped wooden floor and Victorian style radiator.

Dining Room 11'8" max into recess x 10'11" (3.57 max into recess x 3.33)

Fireplace with wood surround and tiled hearth, stripped wooden floor and Victorian-style radiator. Open to:

Open Plan Kitchen / Breakfast Room 14'4" x 11'4" (4.38 x 3.47)

Fitted kitchen comprising modern base units with solid wood work surfaces over, double stainless steel sink with mixer tap, gas Range cooker, space for fridge freezer, shelving, stripped wooden floor, vertical radiator, three skylights, glazed door to passage and triple bi-folding doors leading out into the garden.

Cloakroom

Low-level WC, wash hand basin and stripped wooden floor.

First Floor Landing

Victorian style radiator.

Bedroom 14'1" max x 9'2" (4.31 max x 2.81)

Sash window to rear aspect, stripped wooden floor and Victorian-style radiator. Door:

En Suite Bathroom

Suite comprising free-standing bath with mixer tap and shower attachment, low-level WC, twin wash hand basin set in vanity unit, part tiled walls, stripped wooden floor, vertical radiator and sash window to rear aspect.

Bedroom 11'10" max x 8'6" (3.63 max x 2.60)

Upvc double glazed sash look window to front aspect, feature

decorative fireplace with tiled hearth, stripped wooden floor and Victorian-style radiator.

Bedroom 10'11" x 8'10" (3.34 x 2.71)

Sash window to rear aspect, cupboard housing the central heating boiler, decorative fireplace with tiled hearth, stripped wooden floor and radiator.

Bedroom 8'10" x 6'4" (2.71 x 1.94)

Upvc double glazed sash look window to front aspect, stripped wooden floor and radiator.

Shower Room

Suite comprising walk in shower cubicle with inset shower, wash hand basin with mixer tap, part-tiled walls, stripped wooden floor, spotlights, extractor fan and towel rail radiator.

Front Garden

Traditional terrace style garden enclosed by wall with gated access to the entrance door.

Rear Garden

Larger than average bisected rear garden enclosed by fencing and mainly laid to lawn with seating area, mature flower, shrub and tree borders.

Agents Note

Council Tax Band B



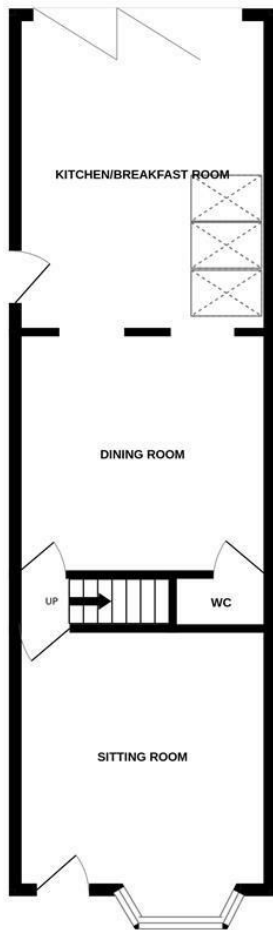

claxtonbird
residential

Whilst every attempt has been made to ensure the accuracy of the floorplan contained here, measurements of doors, windows, rooms and any other items are approximate and no responsibility is taken for any error, omission or mis-statement. This plan is for illustrative purposes only and should be used as such by any prospective purchaser. The services, systems and appliances shown have not been tested and no guarantee as to their operability or efficiency can be given.
Made with Metropix ©2025

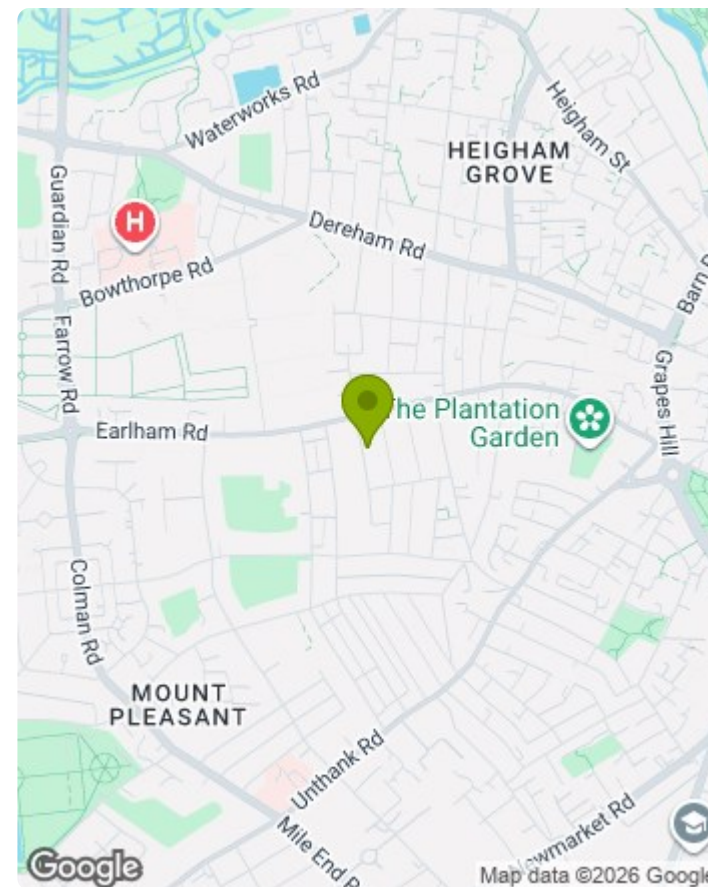

Energy Efficiency Rating		Current	Potential
Very energy efficient - lower running costs			
(92 plus)	A		
(81-91)	B		
(69-80)	C		
(55-68)	D		61
(39-54)	E		
(21-38)	F		
(1-20)	G		
Not energy efficient - higher running costs			
England & Wales		EU Directive 2002/91/EC	

- MONEY LAUNDERING REGULATIONS:** Intending purchasers will be asked to produce identification documentation at a later stage and we would ask for your co-operation in order that there will be no delay in agreeing the sale.
- General:** While we endeavour to make our sales particulars fair, accurate and reliable, they are only a general guide to the property and, accordingly, if there is any point which is of particular importance to you, please contact the office and we will be pleased to check the position for you, especially if you are contemplating travelling some distance to view the property.
- Measurements:** These approximate room sizes are only intended as general guidance. You must verify the dimensions carefully before ordering carpets or any built-in furniture.
- Services:** Please note we have not tested the services or any of the equipment or appliances in this property, accordingly we strongly advise prospective buyers to commission their own survey or service reports before finalising their offer to purchase.
- THESE PARTICULARS ARE ISSUED IN GOOD FAITH BUT DO NOT CONSTITUTE REPRESENTATIONS OF FACT OR FORM PART OF ANY OFFER OR CONTRACT. THE MATTERS REFERRED TO IN THESE PARTICULARS SHOULD BE INDEPENDENTLY VERIFIED BY PROSPECTIVE BUYERS OR TENANTS. NEITHER CLAXTONBIRD LIMITED NOR ANY OF ITS EMPLOYEES OR AGENTS HAS ANY AUTHORITY TO MAKE OR GIVE ANY REPRESENTATION OR WARRANTY WHATSOEVER IN RELATION TO THIS PROPERTY.**

ClaxtonBird Residential
134 Unthank Road
Norwich
NR2 2RS

Tel: 01603 733002
Email: norwich@claxtonbird.co.uk
www.claxtonbird.co.uk

claxtonbird
residential

