



Daubeney Road, E5

£280,000

A one double bedroom flat with amazing views across the Hackney Marshes and Olympic Park. Located on the 7th floor, the property comprises of one double bedroom with built in storage, modern kitchen, bathroom, spacious living room and a private balcony. The gated development benefits from a 24-hour concierge, residents gymnasium & launderette. The flat has an allocated parking space and is offered to cash buyers only.

The property is surrounded by the green spaces of Victoria Park, Hackney Marshes, Olympic Park and River Lea offering many opportunities for outdoor recreation. Chatsworth Road and its many boutique shops, cafés and Sunday Market is under half a mile away as well as Stratford with museums and restaurants. Transport links nearby include bus routes to the City and Homerton Overground and Stratford which is well connected by the Elizabeth Line.

Features

- Cash Only
- One Double Bedroom
- Far Reaching Views
- Allocated Parking Space
- Private Balcony
- 24-Hour Concierge
- Gymnasium

Daubeney Road,
London, E5

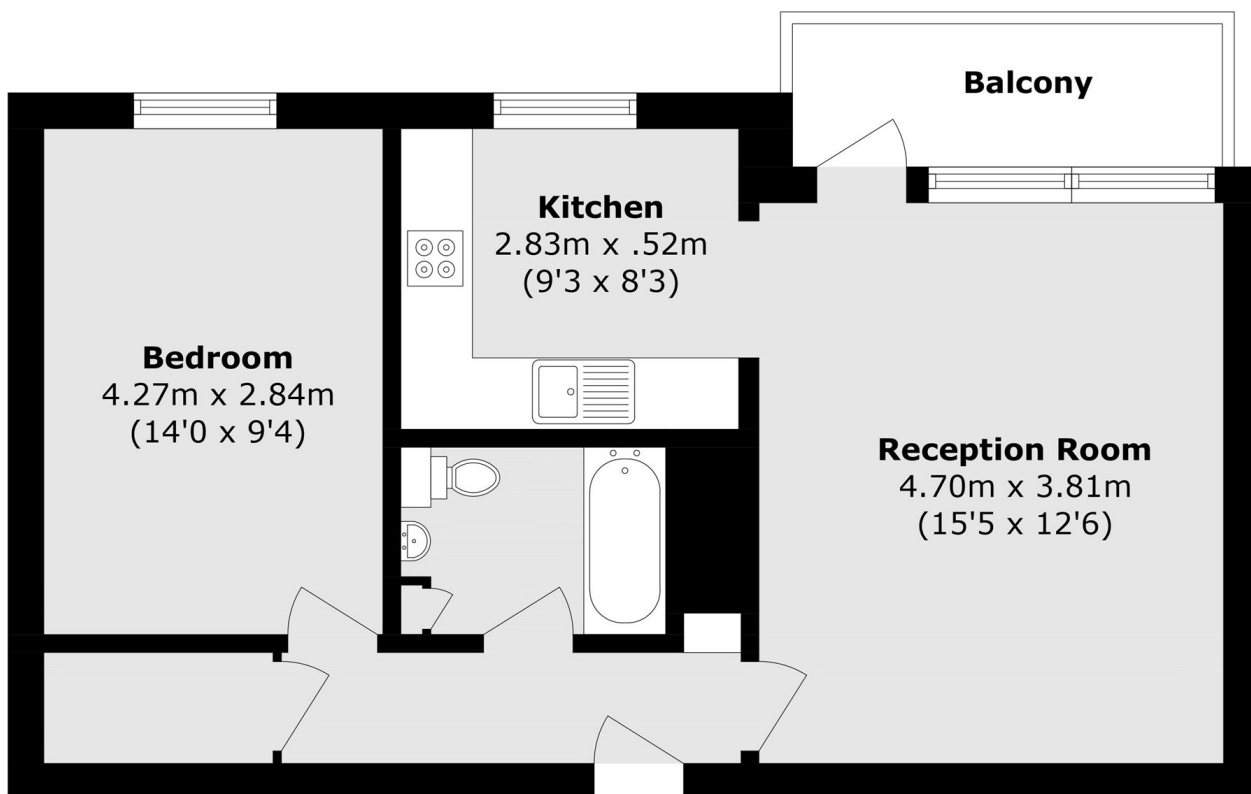

Total area (approx.): 50.1 sq. m (539.2 sq. ft)

Balcony area (approx.): 4.3 sq. m (46.2 sq. ft)