



**Station View, Guildford, GU1**

Guildford

**£2,400 pcm**

**Deposit:** £2,769

**Date First Available:** 05/09/2026

**Furnishing:** Furnished

Built in 2017, this superb two-bedroom apartment is ideally located just 0.3 miles from Guildford's mainline station and a short walk from the historic High Street.

Finished to a high standard, the apartment features a bright open-plan kitchen/living space.

The master bedroom includes fitted wardrobes and a sleek en-suite, with a second double bedroom and stylish family bathroom completing the layout.

Further benefits include secure gated underground parking, a video entry system, and EPC rating B.

This is modern town-centre living at its finest.

Virtual Tour Disclaimer (AI-Enhanced Content Notice)

Please note that certain images and/or elements within the virtual tour may include AI-enhanced or digitally improved visuals. These enhancements are used solely for illustrative and marketing purposes to better convey space, lighting, and layout. They should not be interpreted as an exact or fully unaltered representation of the property. All prospective purchasers are advised to view the property in person to verify its condition and features.



**Deposit:** £2,769

**Date First Available:** 05/09/2026

**Furnishing:** Furnished

Built in 2017, this superb two-bedroom apartment is ideally located just 0.3 miles from Guildford's mainline station and a short walk from the historic High Street.

Finished to a high standard, the apartment features a bright open-plan kitchen/living space.

The master bedroom includes fitted wardrobes and a sleek en-suite, with a second double bedroom and stylish family bathroom completing the layout.

Further benefits include secure gated underground parking, a video entry system, and EPC rating B.

This is modern town-centre living at its finest.

Virtual Tour Disclaimer (AI-Enhanced Content Notice)

Please note that certain images and/or elements within the virtual tour may include AI-enhanced or digitally improved visuals. These enhancements are used solely for illustrative and marketing purposes to better convey space, lighting, and layout. They should not be interpreted as an exact or fully unaltered representation of the property. All prospective purchasers are advised to view the property in person to verify its condition and features.

## Station View, Guildford, GU1

Approximate Gross Internal Area = 63.5 sq m / 683 sq ft

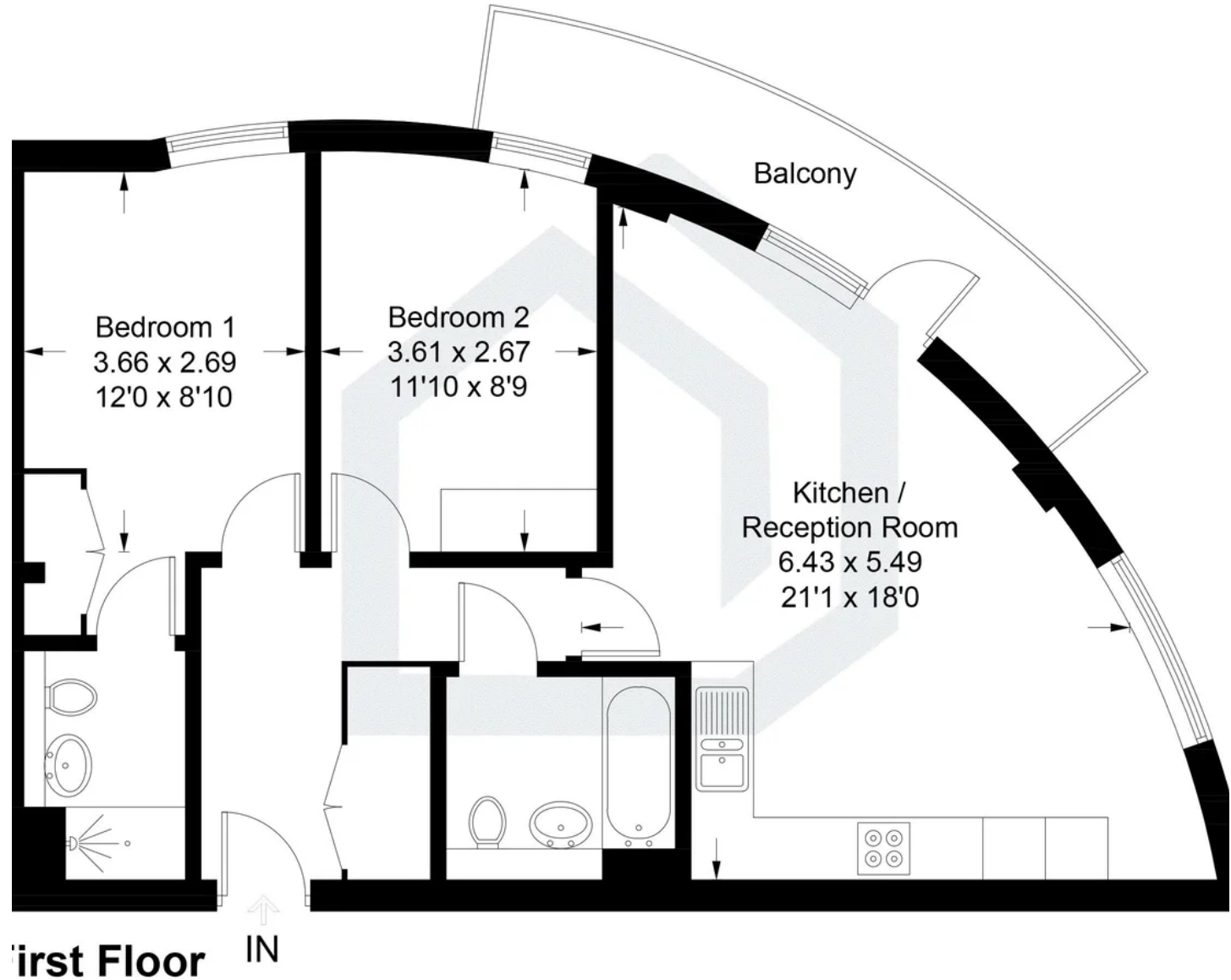

Illustration for identification purposes only, measurements are approximate, not to scale. Fourlabs.co © (ID1299836)



**Pacey Wingent Dickson Property Partnership Limited**  
197 Lower Road Great Bookham Leatherhead KT23 4DG

**01372 456 804**  
[info@pwdproperty.co.uk](mailto:info@pwdproperty.co.uk)  
<https://pwdproperty.co.uk/>