

26, Heath End Road, Bexley DA5 2AH
Asking Price £550,000



Park Estates are delighted to offer onto the market this modern three bedroom end of terrace house, providing spacious accommodation ideal for contemporary family living. The ground floor comprises an entrance hall, ground floor WC, and a modern fitted kitchen which is open plan to a generous living area with built in cupboards and featuring bi folding doors leading out to the rear garden. To the first floor, there is a generous landing with boarded loft for storage, a family bathroom, and three well proportioned bedrooms, with the master benefitting from an en suite shower room. Externally, the property offers off street parking to the front and a secluded rear garden with extended patio. The home is conveniently located within walking distance of a selection of well regarded schools including Wilmington Grammar and Wilmington Academy, as well as local shops, woods, fields, bus routes and other transport links.

Local Authority: Dartford
Council Tax Band: E



01322 553322

60-62 High Street, Bexley, Kent DA5 1AH

bexley@parkestates.co.uk
www.parkestates.co.uk

Heath End Road

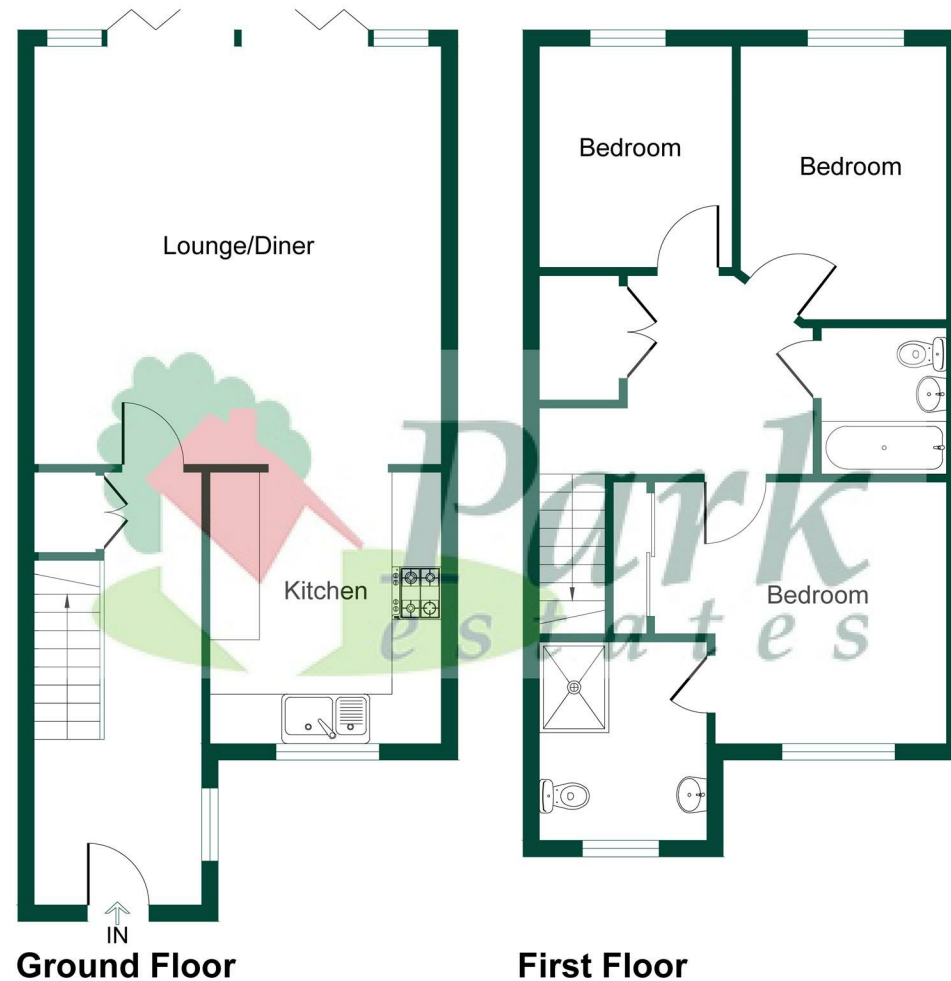

This plan is for layout guidance only. Not drawn to scale unless stated. Windows and door openings are approximate. Whilst every care is taken in the preparation of this plan, please check all dimensions, shapes and compass bearings before making any decisions reliant upon them.
Produced By Planpix

Every care has been taken with the preparation of details, but accuracy is in no way guaranteed. These particulars do not constitute a contract and are issued and accepted on the express understanding that all negotiations will be conducted through Park Estates. The seller does not make or give, nor do we or our employees have any authority to give a representation or warranty in relation to the property. Please contact this office before viewing the property. If there is any point which is of particular importance to you, we will be pleased to check the information for you and confirm that the property remains available. This is particularly important if you are contemplating travelling some distance to view the property. We would strongly recommend that all the information that we provide about the property is verified by yourself on inspection and also by your conveyancer, especially where statements have been made by us to the effect that the information provided by us has not been verified.