



**Allan Morris**  
estate agents

 **MAYFAIR**  
OFFICE GROUP

# Apartment 26, St. Peter's Court, 2 St. Peter's Street, Worcester. WR1 2PJ

Offers In Region Of £230,000

🛏 2 🚿 2 🛋 1



A super opportunity to acquire a top floor two bedroom Apartment, situated within this central city location, with the benefit of lift, secure underground parking and balcony with views towards the Cathedral.

Accommodation briefly comprising: Main Entrance Vestibule and lift to top floor, door giving access into: Hallway with large storage cupboard with water tank, washer dryer, slatted shelving over and further storage, open-plan Kitchen/Dining/Sitting Room with integrated appliances and balcony looking towards the Cathedral, Master Bedroom with good size En-Suite with Villeroy & Boch sanitary ware, further Bedroom and Bathroom. The property also benefits from gas central heating throughout.

Outside: Balcony with views towards Cathedral and secure underground parking.



**Sitting Room/Dining Area/Kitchen** - 7.2m x 2.6m overall (23'7" x 8'6")

**Master Bedroom** - 5.0m x 3.0m max (16'4" x 9'10")

**En-suite** - 2.2m x 1.7m (7'2" x 5'6")

**Bedroom 2** - 3.7m x 2.9m (12'1" x 9'6")

**Bathroom** - 2.2m x 1.7m (7'2" x 5'6")



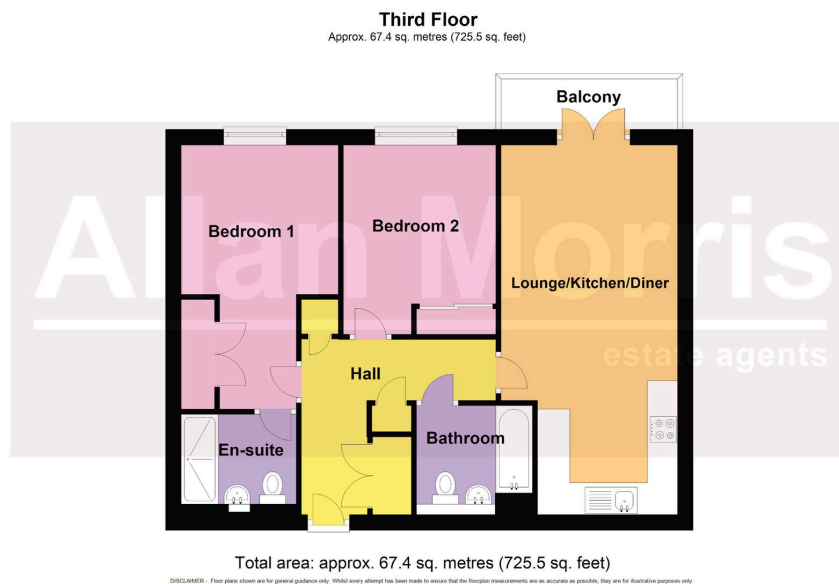

- NO ONWARD CHAIN
- Purpose built 2 bedroom City Apartment
- Top floor & Lift Accessible
- Spacious and well planned
- Views towards the Cathedral
- Balcony
- Secure underground parking
- Council Tax Band: C

