



**Greenwood Road, Wythenshawe, Manchester,  
M22**

**Guide Price: £225,000**

*Freehold*

# Greenwood Road, Wythenshawe, Manchester, M22

Located on Greenwood Road in Wythenshawe, this well-presented three-bedroom terrace property. The home benefits from off-road parking to the front, providing practical and easy access.

The property is entered via a welcoming entrance hall, which leads through to a spacious living and dining room positioned to the right-hand side. This bright and versatile space features a window to the front elevation and patio doors to the rear, allowing plenty of natural light and direct access to the garden, making it ideal for both everyday living and entertaining.

To the rear of the property is the fitted kitchen, which offers a range of base and eye-level units providing ample storage. The kitchen is equipped with a combination of freestanding and integral appliances.

The first floor comprises three generous bedrooms, each offering comfortable accommodation, along with a white three-piece family bathroom.

Externally, the rear garden is mainly laid to lawn with hedge boundaries, offering a good degree of privacy. A paved patio area provides an ideal space for outdoor seating and entertaining, making the garden both practical and enjoyable throughout the year.

- Freehold
- EPC TBC
- Council Tax Band A

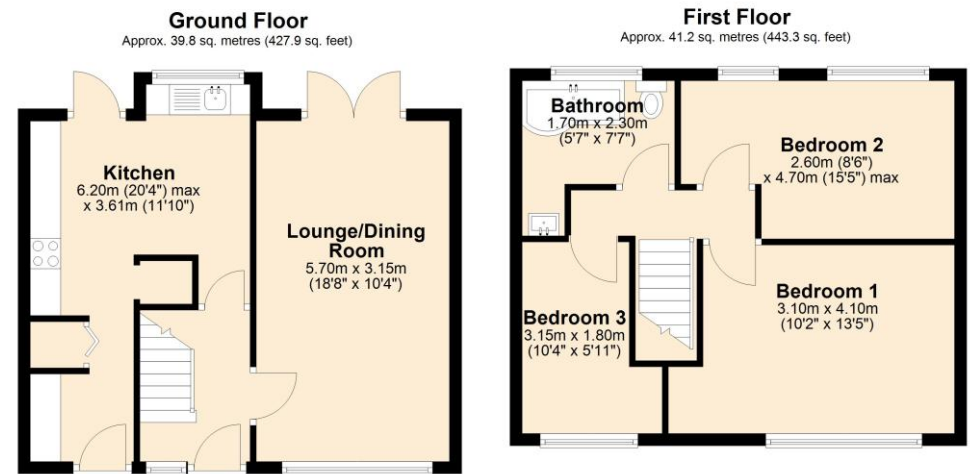

Total area: approx. 80.9 sq. metres (871.2 sq. feet)





## The Property Man

102A School Road

Sale

Cheshire

M33 7XB

T: 01615198855

E: [sales@thepropertyman.co.uk](mailto:sales@thepropertyman.co.uk)

[www.thepropertyman.co.uk](http://www.thepropertyman.co.uk)

The Property Man

Registered Office Address: 7 St. Petersgate, Stockport, England, SK1 1EB Company Reg No: 09023087

### Disclaimer

Every attempt has been made to ensure accuracy, however these property particulars are approximate and for illustrative purposes only. They have been prepared in good faith and they are not intended to constitute part of an offer of contract. We have not carried out a structural survey and the services, appliances and specific fittings have not been tested. All photographs, measurements, floor plans and distances referred to are given as a guide only and should not be relied upon for the purchase of any fixture or fittings. Lease details, service charges and ground rent (where applicable) are given as a guide only and should be checked prior to agreeing a sale.