



## Copperwood Place, SE10

£325,000

A well presented one bedroom top floor modern apartment with a private balcony and city views. A viewing is highly recommended.

Perfectly positioned within walking distance of both Greenwich and Lewisham stations, the property offers excellent transport links into Canary Wharf and the City. The historic Greenwich Market, alongside the expansive green open spaces of Greenwich Park, are also just a short distance away.

### Features

- City Views
- Private Balcony
- Sought After Location
- Ideal First Purchase
- Modern
- Close To Stations

# Copperwood Place, London, SE10

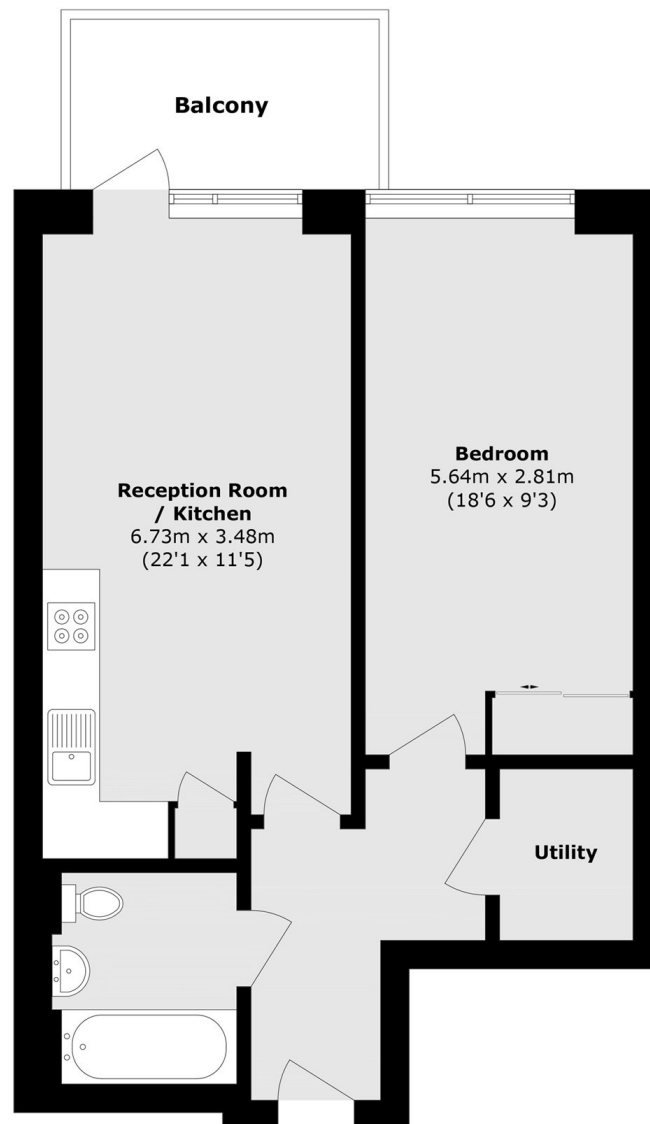

Total area (approx.): 52.6 sq. m (566.1 sq. ft)

Balcony area (approx.): 5.7 sq. m (61.3 sq. ft)